

| REV.NO. | REVISION DESCRIPTION | DRAWN / DATE | REVIEWED / DATE | APPROVED / DATE |
|---------|----------------------|--------------|-----------------|-----------------|
| △       | First issued         | OSS/20191015 | KCH/20191015    | KTJ/20191015    |
| △       | Drawing updated      | KCH/20250108 | JCS/20250108    | KTJ/20250108    |

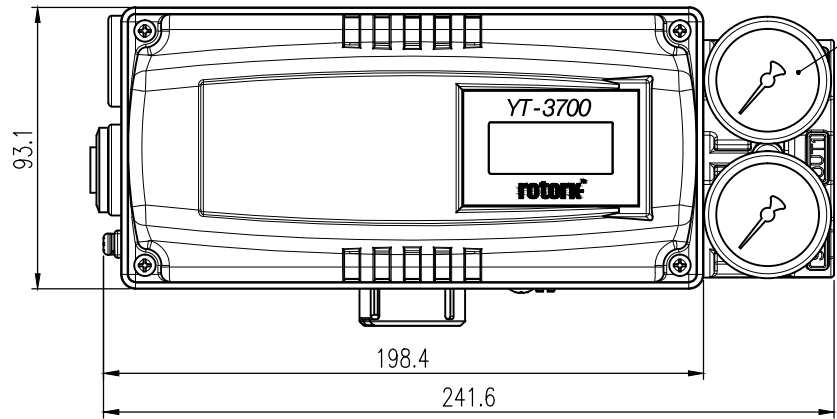

This pressure gauge will be replaced with a plug for single acting type.

| No. | Part name      | Material | Q'ty | Remark |
|-----|----------------|----------|------|--------|
| 6   | Pressure gauge | STS304   | 2    |        |
| 5   | Gauge block    | ALDC12   | 2    |        |
| 4   | Vent cover     | PC       | 1    |        |
| 3   | Main shaft     | STS303   | 1    |        |
| 2   | Base cover     | ALDC12   | 1    |        |
| 1   | Base body      | ALDC12   | 1    |        |

### Specifications

|                                  |                                                                                                                                                                                                           |                         |
|----------------------------------|-----------------------------------------------------------------------------------------------------------------------------------------------------------------------------------------------------------|-------------------------|
| Acting Type                      | <input type="checkbox"/> Single <input type="checkbox"/> Double                                                                                                                                           |                         |
| Input Signal                     | 4-20 mA DC                                                                                                                                                                                                |                         |
| Impedance                        | Max. 500 Ohm/20 mA DC                                                                                                                                                                                     |                         |
| Supply Pressure                  | 0.14 to 0.7MPa (1.4 to 7bar)                                                                                                                                                                              |                         |
| Explosion Protection             | <input type="checkbox"/> Non-Explosion proof <input type="checkbox"/> Ex ia IIC T5/T6 ...                                                                                                                 |                         |
| Stroke                           | 55 to 110"                                                                                                                                                                                                |                         |
| Operating Temp.                  | <input type="checkbox"/> -30 to 85 °C (-22 to 185 °F) <input type="checkbox"/> -40 to 85 °C (-40 to 185 °F)<br><input type="checkbox"/> -55 to 85 °C (-67 to 185 °F) : Only Non-Explosion                 |                         |
| Ambient Temp. of Explosion proof | -40 to 60 °C(T5) / -40 to 40 °C(T6)                                                                                                                                                                       |                         |
| Linearity                        | ± 0.5 % F.S.                                                                                                                                                                                              |                         |
| Hysteresis                       | ± 0.5 % F.S.                                                                                                                                                                                              |                         |
| Sensitivity                      | ± 0.2 % F.S.                                                                                                                                                                                              |                         |
| Repeatability                    | ± 0.3 % F.S.                                                                                                                                                                                              |                         |
| Conduit entry, Air Connection    | <input type="checkbox"/> G 1/2, Rc 1/4 <input type="checkbox"/> G 1/2, 1/4 NPT <input type="checkbox"/> G 1/2, G 1/4 <input type="checkbox"/> M20x1.5P, 1/4 NPT <input type="checkbox"/> 1/2 NPT, 1/4 NPT |                         |
| Gauge Connection                 | 1/8 NPT                                                                                                                                                                                                   |                         |
| Air consumption                  | Below 2 LPM (Sup. = 0.14 MPa, 1.4 bar)                                                                                                                                                                    |                         |
| Flow Capacity                    | 70 LPM (Sup. = 0.14 MPa, 1.4 bar)                                                                                                                                                                         |                         |
| Ingress Protection               | IP66, Type 4X(FM), (excluding the pressure gauges)                                                                                                                                                        |                         |
| Main Board                       | MPU                                                                                                                                                                                                       | 16 bit Micro Controller |
|                                  | A/D Converter                                                                                                                                                                                             | 12 bit                  |
|                                  | D/A Converter                                                                                                                                                                                             | 12 bit                  |
| Output Characteristics           | Linear, EQ%, Quick Open, User set                                                                                                                                                                         |                         |
| Communication                    | HART Communication (HART 7)                                                                                                                                                                               |                         |
| Analog Output                    | <input type="checkbox"/> None <input type="checkbox"/> 4-20 mA (DC 9-28 V)                                                                                                                                |                         |
| Digital In / Out                 | Applied                                                                                                                                                                                                   |                         |
| Housing material                 | Aluminum                                                                                                                                                                                                  |                         |
| Weight                           | 2.0 kg (4.4 lb)                                                                                                                                                                                           |                         |

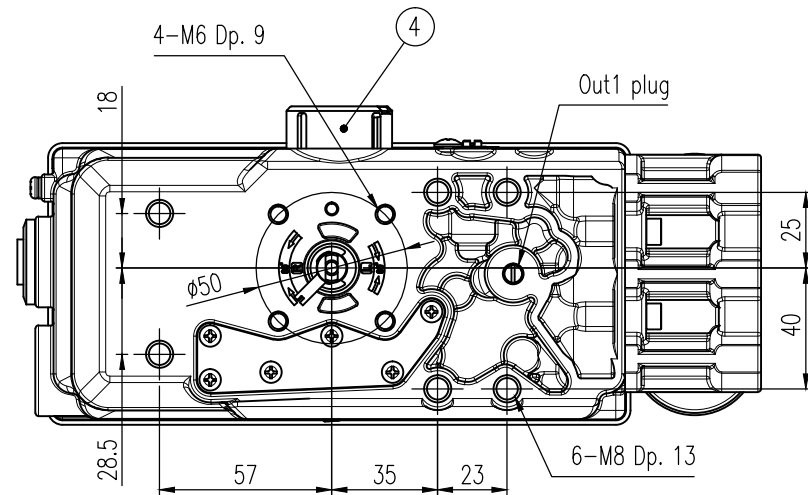
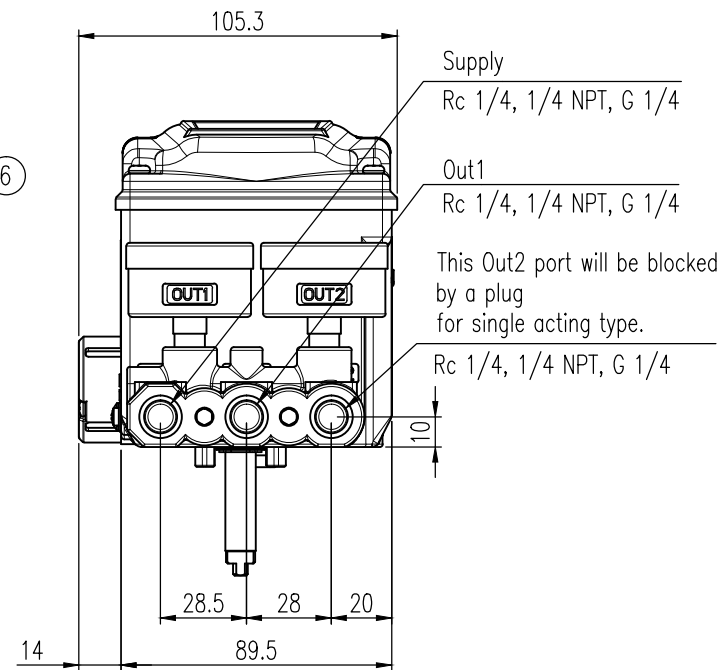
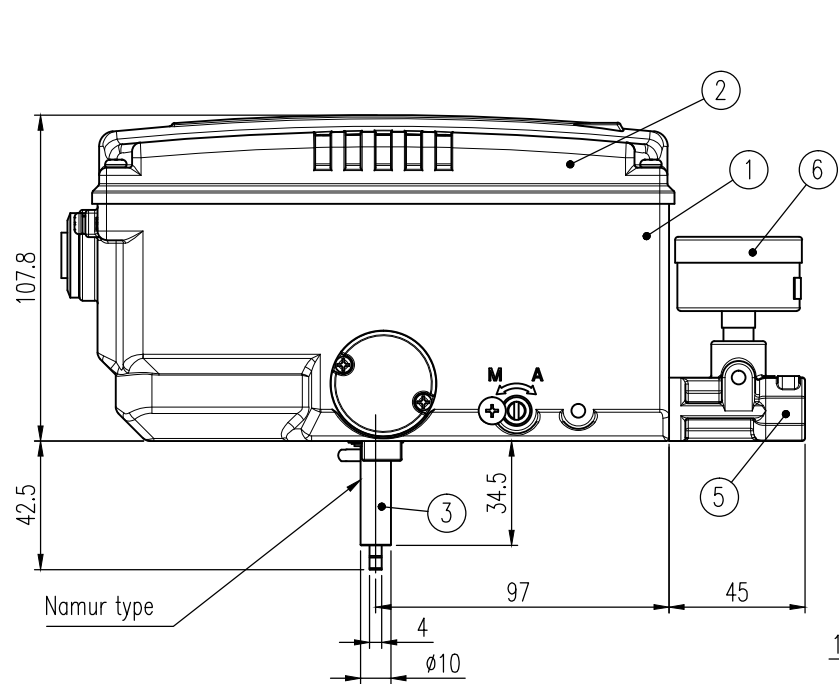
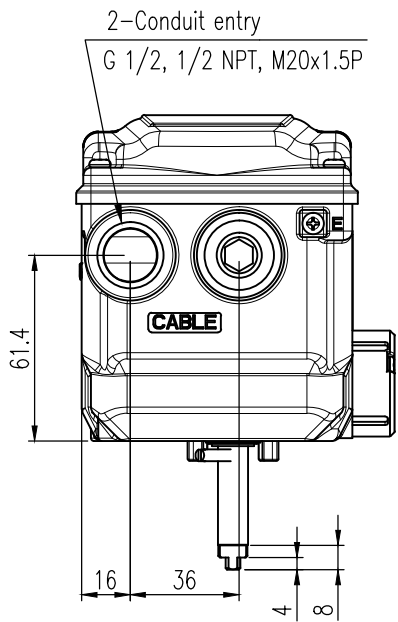

|                  |  |                   |          |                  |      |
|------------------|--|-------------------|----------|------------------|------|
| SURFACE TEXTURE  |  | PRODUCT NAME      |          | PROJECT NAME     |      |
| -                |  | Smart positioner  |          | -                |      |
| FINISH TREATMENT |  | MODEL             |          | TITLE            |      |
| -                |  | YT-3700R          |          | Rotary, Standard |      |
| MATERIAL         |  | PROJECTION        | SCALE    | DRAWING NO.      |      |
| -                |  | 3rd               | 1 / 2.5  | YT-3700R-1       |      |
| OTHERWISE NOTE   |  | GENERAL TOLERANCE | QUANTITY | SHEET No.        | REV. |
| -                |  | 1                 |          | 1 / 1            | 1    |