

REV.NO.	REVISION DESCRIPTION	DRAWN / DATE	REVIEWED / DATE	APPROVED / DATE
	Previous versions omitted			
2	Drawing title block updated	KCH/20190801	JJS/20190801	KTJ/20190801
3	Number range dispys changed	KYJ/20241119	JJS/20241119	KTJ/20241119

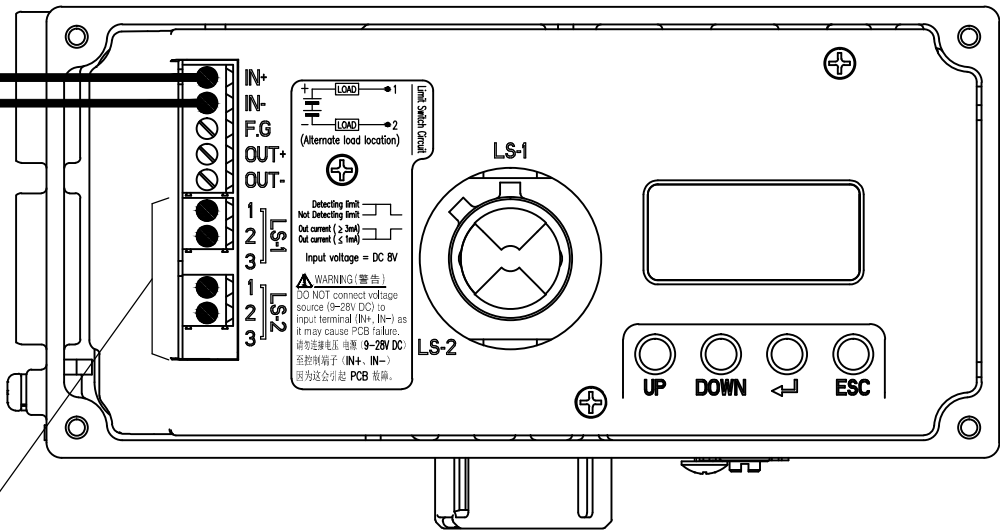

* P&F Proximity Sensor Spec.

Supply Voltage	DC 8.2V
Output Current	Not Detected : $\geq 3\text{mA}$, Detected : $\leq 1\text{mA}$
Type	Namur, NC

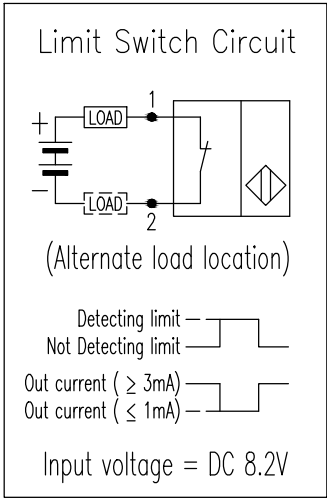
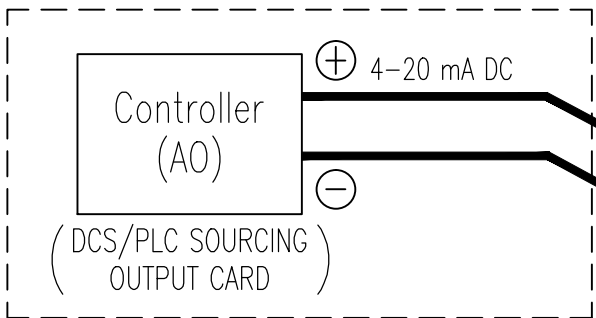
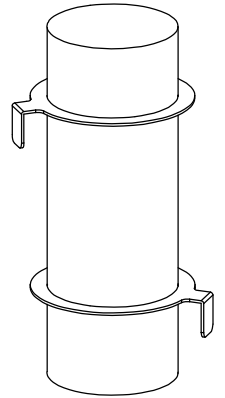
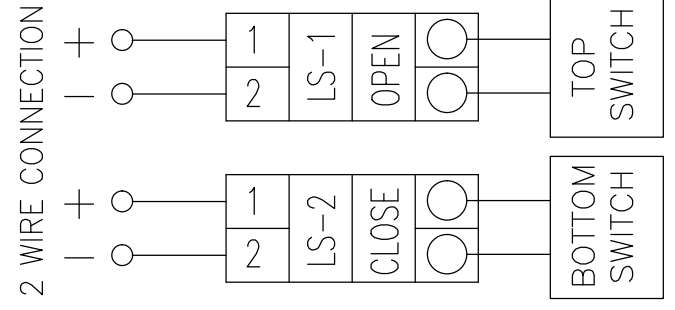

SURFACE TEXTURE		PRODUCT NAME	
-		SMART POSITIONER	
FINISH TREATMENT		MODEL	
-		YT-3300, 3350	
MATERIAL		PROJECTION	SCALE
-		3rd	-
OTHERWISE NOTE	GENERAL TOLERANCE	QUANTITY	SHEET No.
-	-	1	1 / 1

PROJECT NAME		-	
Rotork YTC Limited <small>GMPO-SI, KOREA</small>		TITLE	
		YT-3300/3350 + L/S(2xProximity) WIRING DIAGRAM	
DRAWING NO.		REV.	
3300-09		3	