

SEE TABLE FOR BORE & KEY DETAILS

SEE TABLE FOR BASEPLATE DETAILS

MOUNTING HOLES CAN BE POSITIONED ON CTRS BY REMOVING 8 BOLTS INDICATED AND REPOSITIONING

RATIO	M.A.	C.O.G.			MAX OUTPUT TORQUE Nm (lbs.ft)
		X	Y	Z	
2	1.800	0	101	63	1355 (1000)
3	2.700	0	95	63	1355 (1000)
4	3.600	0	93	63	1355 (1000)
6	5.400	0	94	63	1355 (1000)
8	7.200	0	89	63	1355 (1000)

MAX BORE SQ KEY			MAX BORE RECTANGULAR KEY		
STD	BORE	KEY	STD	BORE	KEY
BS4235	-	-	BS4235	52.0	16 x 10
BS46	1.875	1/2" SQ	BS46	2.000	1/2" x 5/16"
ANSI B17.1	1.875	1/2" SQ	ANSI B17.1	2.000	1/2" x 3/8"

MAX STEM SCREW ACCEPTANCE DIA.
55 (2.125)

INPUT FLANGE DETAILS						
ISO	FLANGE	SHAFT	RECESS	RECESS	HOLE DETAILS	KEY
	O/DIA. & THICKNESS	DIA.	DIA.	DEPTH	45°(OFF CENTRES)	DETAILS
F10	Ø125 x 10	Ø20.00-0.05	Ø70.05+0.05	5	4 HOLES Ø10.5 (Ø0.41")	6x6x40
	(Ø4.92" x 0.39")	(Ø0.787"-0.002")	(Ø2.758"+0.002")	(0.20")	ON Ø102.0 (Ø4.02") P.C (0.24"x0.24"x1.57")	
FA10	Ø125 x 10	Ø20.00-0.05	Ø58.75+0.05	5	4 HOLES Ø10.5 (Ø0.41")	6x6x40
	(Ø4.92" x 0.39")	(Ø0.787"-0.002")	(Ø2.313"+0.002")	(0.20")	ON Ø102.0 (Ø4.02") P.C (0.24"x0.24"x1.57")	

BASEPLATE DETAILS		
ISO	SPIGOT DIA.	HOLE DETAILS (45° OFF CENTRES)
F14	Ø99.95-0.05	4 HOLES M16x20 (0.79") DEEP (Ø3.935"-0.002") ON Ø140.0 (Ø5.51") P.C.
FA14	Ø95.22-0.10	4 HOLES 5/8"UNCx20 (0.79") DEEP (Ø3.749"-0.004") ON Ø139.7 (Ø5.50") P.C.

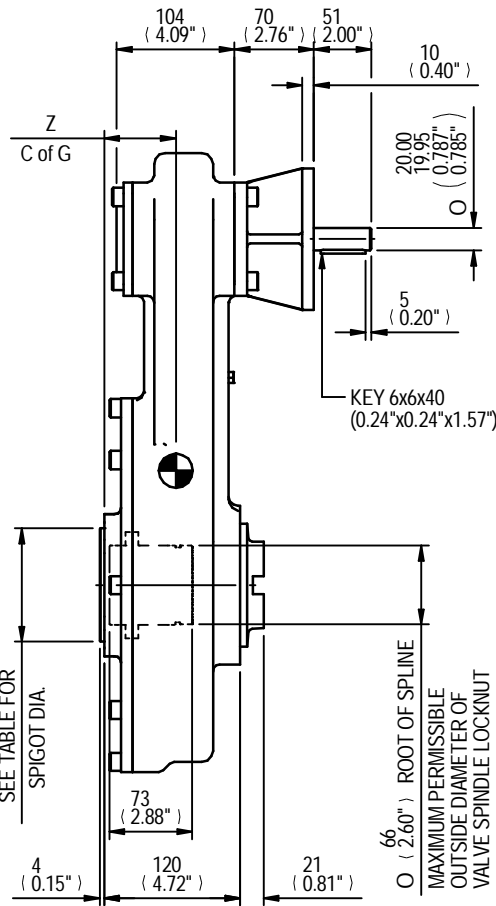

SEE TABLE FOR SPIGOT DIA.

66 O (2.60") ROOT OF SPLINE
MAXIMUM PERMISSIBLE OUTSIDE DIAMETER OF VALVE SPINDLE LOCKNUT

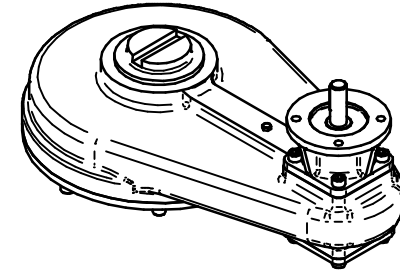
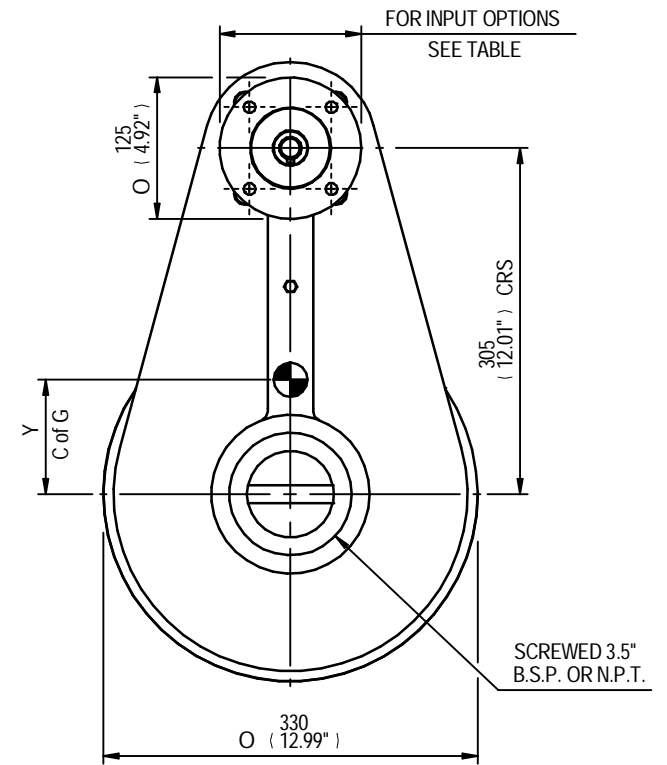

rotork gears

IS6 GEARBOX
F10/FA10 INPUT F14/FA14 OUTPUT

APPROX WEIGHT 44.5 kg

DRAWING No	PUBIS6-F10-F14	Regina House Ring Road Bramley Leeds LS134ET United Kingdom
ISSUE	A	
DATE	26/05/2011	

DETAILS SUBJECT TO CHANGE WITHOUT PRIOR NOTICE

FOR UP TO DATE DETAILS VISIT www.rotork.com