

SEE TABLE FOR BORE & KEY DETAILS

SEE TABLE FOR BASEPLATE DETAILS

MOUNTING HOLES CAN BE POSITIONED ON CTRS BY REMOVING 8 BOLTS INDICATED AND REPOSITIONING

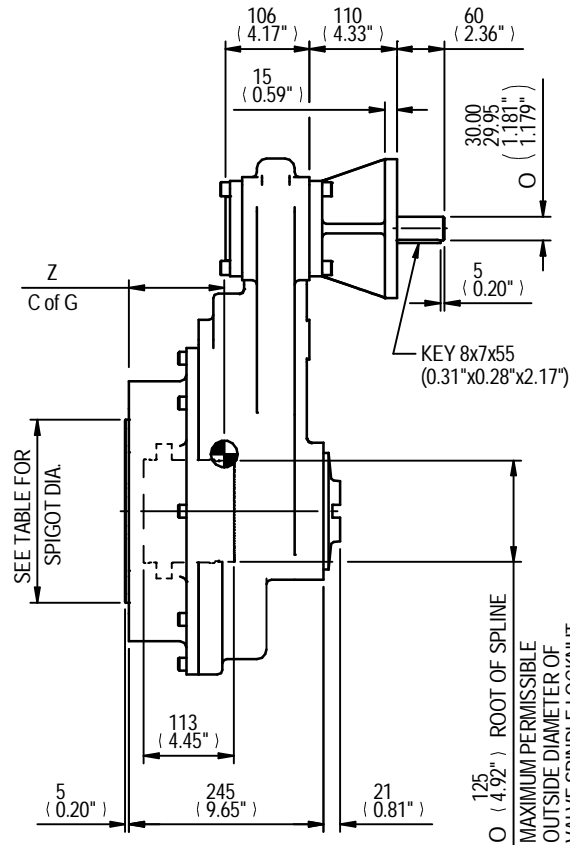

SEE TABLE FOR SPIGOT DIA.

125 (4.92 inches) O (1.181 inches) MAXIMUM PERMISSIBLE OUTSIDE DIAMETER OF VALVE SPINDLE LOCKNUT

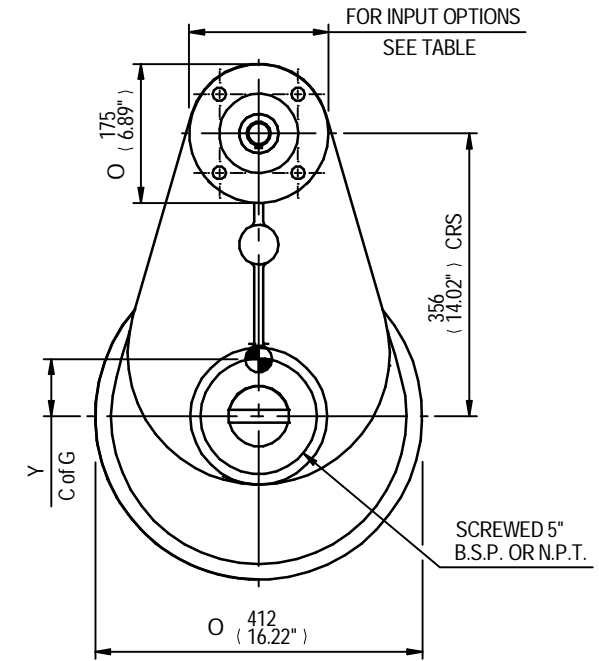

| RATIO | M.A.   | C.O.G. |    |     | MAX OUTPUT TORQUE Nm (lbs.ft) |
|-------|--------|--------|----|-----|-------------------------------|
|       |        | X      | Y  | Z   |                               |
| 4     | 3.633  | 0      | 72 | 120 | 4067 (3000)                   |
| 6     | 5.500  | 0      | 71 | 120 | 4067 (3000)                   |
| 8     | 7.025  | 0      | 70 | 120 | 4067 (3000)                   |
| 10    | 9.156  | 0      | 71 | 121 | 4067 (3000)                   |
| 12    | 10.900 | 0      | 71 | 121 | 4067 (3000)                   |
| 15    | 13.194 | 0      | 71 | 121 | 4067 (3000)                   |

| MAX BORE SQ KEY |                |     | MAX BORE RECTANGULAR KEY |        |             | MAX STEM SCREW ACCEPTANCE DIA (3.875") |
|-----------------|----------------|-----|--------------------------|--------|-------------|--|
| STD             | BORE           | KEY | STD                      | BORE   | KEY         |  |
| BS4235          | -              | -   | BS4235                   | 96.0   | 28 x 16     |  |
| BS46            | 3.500" 7/8" SQ |     | BS46                     | 3.625" | 1" x 3/4"   |  |
| ANSI B17.1      | 3.500" 7/8" SQ |     | ANSI B17.1               | 3.750" | 7/8" x 5/8" |  |

|      | INPUT FLANGE DETAILS       |                              |                              |                               |  |
|------|----------------------------|------------------------------|------------------------------|-------------------------------|--|
|      | FLANGE O/DIA. & THICKNESS  | SHAFT DIA.                   | RECESS DIA.                  | RECESS DEPTH                  | HOLE DETAILS 45°(OFF CENTRES)                                      |
|      | ISO F14                    | Ø175 x 15 (Ø6.89" x 0.59")   | Ø30.00-0.05 (Ø1.181"-0.002") | Ø100.05+0.05 (Ø3.939"+0.002") | 5 (0.20")  |
| FA14 | Ø175 x 15 (Ø6.89" x 0.59") | Ø30.00-0.05 (Ø1.181"-0.002") | Ø95.27+0.05 (Ø3.751"+0.002") | 5 (0.20")                     | 4 HOLES Ø16.5 (Ø0.65") ON Ø140.0 (Ø5.51") P.C. (0.31"x0.28"x2.17") |

|      | BASEPLATE DETAILS             |  |
|------|-------------------------------|--|
|      | SPIGOT DIA.                   | HOLE DETAILS (22.5° OFF CENTRES)                         |
|      | ISO F30                       | Ø229.95-0.05 (Ø9.053"-0.002")                            |
| FA30 | Ø177.70-0.05 (Ø6.996"-0.002") | 8 HOLES 3/4"UNCx25 (0.98") DEEP ON Ø298.5 (Ø11.75") P.C. |

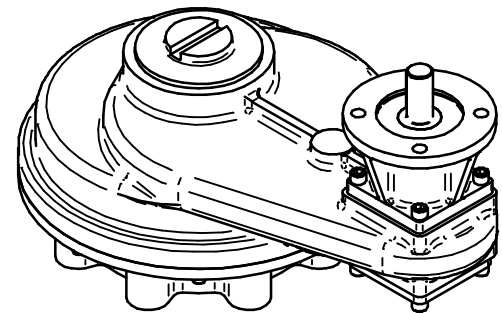

IS11 GEARBOX  
F14/FA14 INPUT F30/FA30 OUTPUT

DETAILS SUBJECT TO CHANGE WITHOUT PRIOR NOTICE

FOR UP TO DATE DETAILS VISIT [www.rotork.com](http://www.rotork.com)

APPROX WEIGHT 125.9 kg

|            |                 |  |
|------------|-----------------|--|
| DRAWING No | PUBIS11-F14-F30 | Regina House<br>Ring Road<br>Bramley<br>Leeds<br>LS134ET<br>United Kingdom |
| ISSUE      | A               |  |
| DATE       | 08/06/2011      |  |