

SEE TABLE FOR BORE & KEY DETAILS

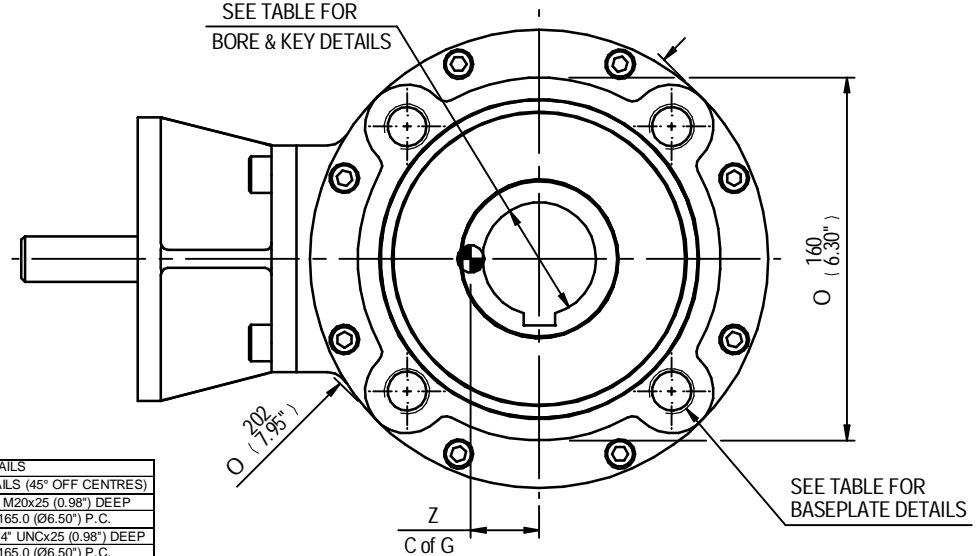

RATIO	M.A.	C.O.G.			MAX OUTPUT TORQUE Nm (lbs.ft)
		X	Y	Z	
2	1.70	0	34	30	306 (225)
3	2.55	0	34	29	678 (500)
4	3.40	0	34	28	678 (500)
6	5.10	0	34	28	542 (400)

MAX BORE SQ KEY			MAX BORE RECTANGULAR KEY		
STD	BORE	KEY	STD	BORE	KEY
BS4235	-	-	BS4235	52.0	16X10
BS46	1.875	1/2" SQ	BS46	2.000	1/2"x5/16"
ANSI B17.1	1.875	1/2" SQ	ANSI B17.1	2.000	1/2"x3/8"

MAX STEM SCREW ACCEPTANCE DIA
55 (2.125")

	INPUT FLANGE DETAILS					
	FLANGE	SHAFT	RECESS	RECESS	HOLE DETAILS	KEY
	O/DIA. & THICKNESS	DIA.	DIA.	DEPTH	45°(OFF CENTRES)	DETAILS
ISO F10	Ø125 x 10 (Ø4.92" x 0.39")	Ø20.00-0.05 (Ø0.787"-0.002")	Ø70.05+0.05 (Ø2.758"+0.002")	5 (0.20")	4 HOLES Ø10.5 (Ø0.41") ON Ø102.0 (Ø4.02") P.C.	6x6x40 (0.24"x0.24"x1.57")
	Ø125 x 10 (Ø4.92" x 0.39")	Ø20.00-0.05 (Ø0.787"-0.002")	Ø58.75+0.05 (Ø2.313"+0.002")	5 (0.20")	4 HOLES Ø10.5 (Ø0.41") ON Ø102.0 (Ø4.02") P.C.	6x6x40 (0.24"x0.24"x1.57")

	BASEPLATE DETAILS	
	SPIGOT DIA.	HOLE DETAILS (45° OFF CENTRES)
ISO F16	Ø129.95-0.05 (Ø5.116"-0.002")	4 HOLES M20x25 (0.98") DEEP ON Ø165.0 (Ø6.50") P.C.
FA16	Ø126.87-0.25 (Ø4.995"-0.010")	4 HOLES 3/4" UNCx25 (0.98") DEEP ON Ø165.0 (Ø6.50") P.C.

**rotork
gears**

**IB5 GEARBOX
F10/FA10 INPUT F16/FA16 OUTPUT**

DETAILS SUBJECT TO CHANGE WITHOUT PRIOR NOTICE

FOR UP TO DATE DETAILS VISIT www.rotork.com

APPROX WEIGHT 19.8 kg

DRAWING No	PUBIB5-F10-F16	Regina House Ring Road Bramley Leeds LS134ET United Kingdom
ISSUE	A	
DATE	28/04/2011	