

# Mounting kits

## For actuator - valve / On-Off and modulating

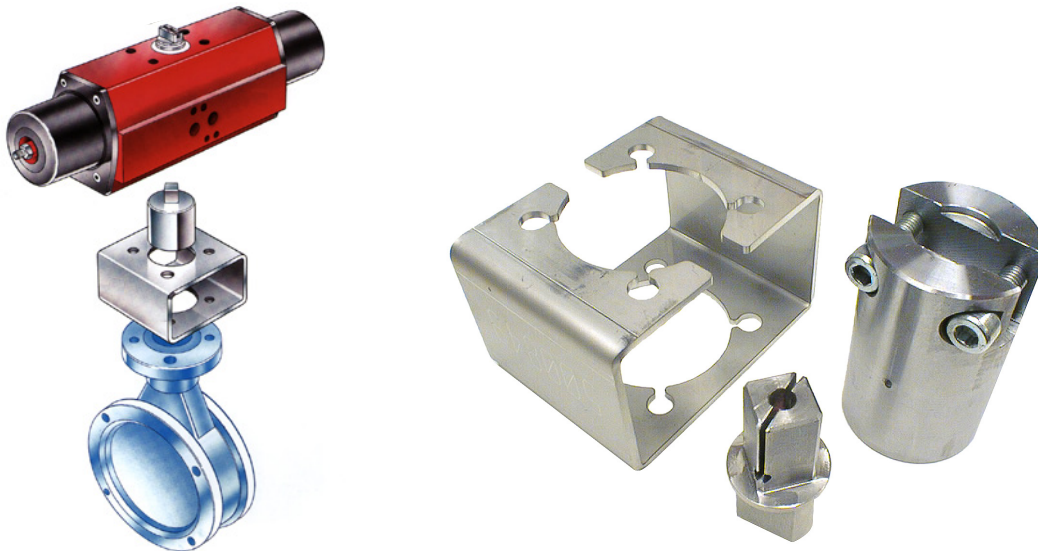

### Standard Design

Actuator	Valve	Mounting kit		
		Screw kit	Driving bush	Bracket
RC210-265	ISO-flange ≤ F12	Stainless	Stainless	Stainless
RC250-265	ISO-flange ≥ F14	Zinc plated	Stainless	Steel, painted
RC210-265	No ISO flange	Zinc plated	Stainless	Steel, painted
RC270-88	ISO flange	Zinc plated	Steel, painted	Steel, painted

### Option

Actuator	Valve	Mounting kit		
		Screw kit	Driving bush	Bracket
RC210-265	No ISO flange	Stainless	Stainless	Steel, epoxy coated
RC270-88	No ISO flange	Stainless	Steel, epoxy coated	Steel, epoxy coated
RC270-88	ISO flange	Stainless	Steel, epoxy coated	Steel, epoxy coated

The high quality mounting kits from Rotork Sweden with the perfect fit are available for most existing valves on the market.

When ordering, please mention the type of actuator, valve manufacture and type, connection dimension, full or reduced bore and pressure class.

