

RATIO	M.A.	C.O.G.			MAX. OUTPUT TORQUE Nm (lbs.ft)
		X	Y	Z	
15	13.650	0	91	349	43386 (32000)
24	21.680	0	89	353	43386 (32000)

MAX BORE SQ KEY			MAX BORE RECTANGULAR KEY		
STD	BORE	KEY	STD	BORE	KEY
BS4235	-	-	BS4235	206.0	50 x 28
BS46	7.500"	1 7/8" SQ	BS46	7.750"	2" x 1 3/8"
ANSI B17.1	7.500"	1 3/4" SQ	ANSI B17.1	7.750"	2" x 1 1/2"

MAX STEM SCREW ACCEPTANCE DIA 225 (8.750")
--

INPUT FLANGE DETAILS						
ISO	FLANGE	SHAFT		RECESS	HOLE DETAILS	KEY
	O/DIA. & THICKNESS	DIA.	DIA.	DEPTH	22.5°(OFF CENTRES)	DETAILS
F30	Ø350 x 20	Ø50.00-0.05	Ø230.10+0.05	6	8 HOLES Ø20.5 (Ø0.81")	14x9x80
	(Ø13.78" x 0.79")	(Ø1.969"-0.002")	(Ø9.059"+0.002")	(0.24")	ON Ø298.0 (Ø11.73") P.C	(0.55"x0.35"x3.15")
FA30	Ø350 x 20	Ø50.00-0.05	Ø177.80+0.05	6	8 HOLES Ø20.5 (Ø0.81")	14x9x80
	(Ø13.78" x 0.79")	(Ø1.969"-0.002")	(Ø7.000"+0.002")	(0.24")	ON Ø298.0 (Ø11.73") P.C	(0.55"x0.35"x3.15")

BASEPLATE DETAILS		
ISO	SPIGOT DIA.	HOLE DETAILS (15° OFF CENTRES)
	F48	Ø369.95-0.05
FA48	(Ø14.565"-0.002")	ON Ø483.0 (Ø19.02") P.C
	Ø368.20-0.15	12 HOLES 1.25"UNCx45 (1.77") DEEP
FA48	(Ø14.496"-0.006")	ON Ø482.6 (Ø19.00") P.C

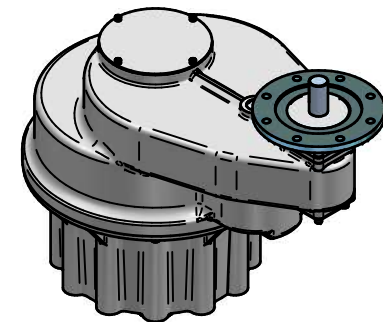

**rotork  
gears**

IS20 GEARBOX  
F30/FA30 INPUT F48/FA48 OUTPUT

DETAILS SUBJECT TO CHANGE WITHOUT PRIOR NOTICE

FOR UP TO DATE DETAILS VISIT [www.rotork.com](http://www.rotork.com)

APPROX WEIGHT 749.8 kg

DRAWING No	PUBIS20-F30-F48	9 Brown Lane West Holbeck Leeds LS12 6BH United Kingdom
ISSUE	B	
DATE	21/06/2011	