

RATIO	M.A.	C.O.G.			MAX. OUTPUT TORQUE Nm (lbs.ft)
		X	Y	Z	
15	13.650	0	118	308	43386 (32000)
24	21.680	0	115	311	43386 (32000)

MAX BORE SQ KEY			MAX BORE RECTANGULAR KEY		
STD	BORE	KEY	STD	BORE	KEY
BS4235	-	-	BS4235	130.0	32x18
BS46	4.625"	1 1/4" SQ	BS46	5.000"	1 1/4"x7/8"
ANSI B17.1	4.625"	1 1/4" SQ	ANSI B17.1	5.000"	1 1/4"x7/8"

MAX STEM SCREW ACCEPTANCE DIA
150(5.875")

	INPUT FLANGE DETAILS					
	FLANGE O/DIA. & THICKNESS	SHAFT DIA.	RECESS DIA.	RECESS DEPTH	HOLE DETAILS 22.5°(OFF CENTRES)	KEY DETAILS
ISO F30	Ø350 x 20	Ø50.00-0.05	Ø230.10+0.05	6	8 HOLES Ø20.5 (Ø0.81") (0.24")	14x9x80 (0.55"x0.35"x3.15")
	(Ø13.78" x 0.79")	(Ø1.969"-0.002")	(Ø9.059"+0.002")	(0.24")	ON Ø298.0 (Ø11.73") P.C.	(0.55"x0.35"x3.15")
FA30	Ø350 x 20	Ø50.00-0.05	Ø177.80+0.05	6	8 HOLES Ø20.5 (Ø0.81") (0.24")	14x9x80 (0.55"x0.35"x3.15")
	(Ø13.78" x 0.79")	(Ø1.969"-0.002")	(Ø7.000"+0.002")	(0.24")	ON Ø298.0 (Ø11.73") P.C.	(0.55"x0.35"x3.15")

	BASEPLATE DETAILS	
	SPIGOT DIA.	HOLE DETAILS (22.5° OFF CENTRES)
ISO F40	Ø299.95-0.05	8 HOLES M36x45 (1.77") DEEP (Ø11.809"-0.002")
		ON Ø406.0 (Ø15.98") P.C.
FA40	Ø228.60-0.15	8 HOLES 1.25"UNCx45 (1.77") DEEP (Ø9.000"-0.006")
		ON Ø406.4 (Ø16.00") P.C.

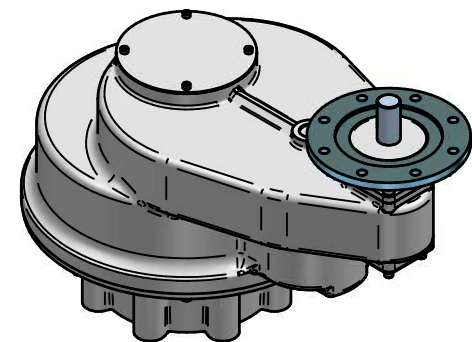

## IS18 GEARBOX F30/FA30 INPUT F40/FA40 OUTPUT

DETAILS SUBJECT TO CHANGE WITHOUT PRIOR NOTICE

FOR UP TO DATE DETAILS VISIT [www.rotork.com](http://www.rotork.com)

APPROX WEIGHT 569.1 kg

DRAWING No	PUBIS18-F30-F40	9 Brown Lane West Holbeck Leeds LS12 6BH United Kingdom
ISSUE	B	
DATE	15/06/2011	