

InSwitch-P Auxilliary switch, retrofit

2 potential free contacts, adjustable on site, adaptable to **InPlus** linear actuators

Type	Technical data	Installation area
InSwitch-P	Auxilliary switch with 2 adjustable contacts, potential free	safe area
... - CT	Housing in „Amercoat“ marine painting	

Product views

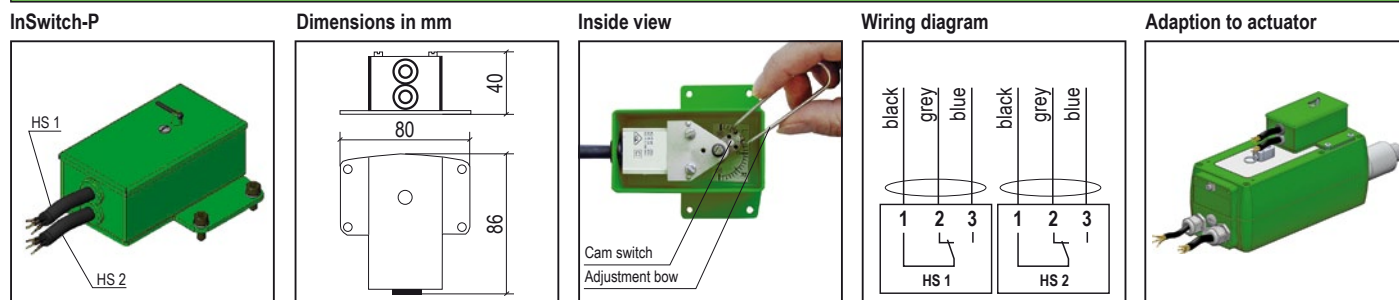

Description

InSwitch-P are adaptable auxilliary switches for end and interim position indication. InSwitch-P have 2 potential free contacts installed in a housing which can be fitted directly to InPlus linear actuators. Both contacts are adjustable. Adjustment during operation is possible. InSwitch-P are delivered with a cable of approx. 1 m. For electrical connection inside hazardous areas, a special terminal box is required (see accessories InBox).

Mounting and adjustment

- Put the mechanical linkage into the squared connection of the actuator.
- Mount the ExSwitch to the actuator and fix it with the 4 screws.
- Wire the actuator (terminal box required!).
- Drive actuator to lower end position.
- Open the InSwitch-P and adjust each switch with the adjustment bow. You have to open the screw to turn the cam switch, afterwards tighten the screw.
- Make a mechanical check that the switches are working in the required position.
- Lock the enclosure.

Settings depending on position of lifting rod

Lifting rod out –	Drive shaft rotates clockwise (switch area L):
HS 1 (top)	– switches from 1–2 to 1–3
HS 2 (bottom)	– switches from 1–3 to 1–2
Lifting rod in –	Drive shaft rotates counterclockwise (switch area R):
HS 1 (top)	– switches from 1–3 to 1–2
HS 2 (bottom)	– switches from 1–2 to 1–3

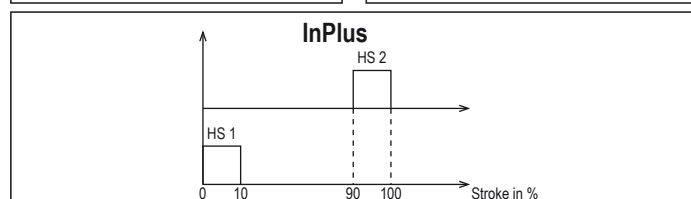
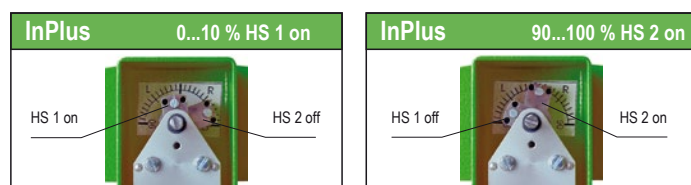

Technical data

Adaption to actuator	direct mounting to the actuator
Function	2 auxilliary switches with potential free contacts
Max. current AC/DC	24 VAC/DC, 3 A – 240 VAC, 0,5 A min. 4 V, 1 mA
Mechanical life	2 × 10 ⁶ switch cycles
Cable connection	1 cable for each switch, approx. 1 m cable length, 3 × 0,5 mm ² , cable diameter ~ Ø 4,5 mm
Ambient temperature	–40...+40 °C
Accuracy	< 5°
Switch hysteresis	approx. 5 %
IP protection switch	IP67 in acc. with EN 60529
IP protection housing	IP43 in acc. with EN 60529
Housing material	Steel, painted
Housing material Switch	Plastic, Thermoplast
Material Switch	Changeover contacts silver, gold-plated
Delivery	1 housing with 2 integral switches inclusive squared connection (mechanical linkage to InPlus linear actuators), 4 screws, 1 adjustment bow for adjustment of switching position, position indicator

Accessories

InBox-SW	Terminal box
-----------------	--------------

Subject to change!

ZIP.InSwitch-P_en
10-Jul-2012