

ISOMETRIC VIEW  
(SCALE 1:12)

**NOTES:**  
 : DIMENSIONS WITH "\*" INDICATE COVER REMOVAL ALLOWANCE  
 : ELECTRONICS COVER OPTION "\*\*\*\*" WILL VARY DEPENDING ON CONFIGURATION  
 : NETT WEIGHT = F30:247kg/544lbs, F35:255kg/562lbs  
 : = OIL FILLER/DRAIN PLUG  
 : THE INTERFACE PROVIDED FOR MOUNTING THE ACTUATOR OR SECOND STAGE GEARBOX ONTO THE VALVE SHOULD CONFORM TO GOOD ENGINEERING PRACTICES, ENSURING ADEQUATELY TOLERANCED LIMITS FOR PARALLELISM, PERPENDICULARITY AND CONCENTRICITY.  
 : ROTORK CANNOT BE HELD LIABLE FOR DAMAGE TO OUR EQUIPMENT CAUSED BY EXCESSIVE LOADING FROM COVER TUBES. (SEE ALSO PUB000-124)

**CONDUIT ENTRIES**

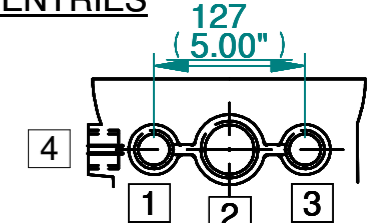

|         | Hole 1      | Hole 2      | Hole 3      | Hole 4      |
|---------|-------------|-------------|-------------|-------------|
| Size    | As Required | As Required | As Required | As Required |
| Plugged | As Required | As Required | As Required | As Required |
| Gland   | As Required | As Required | As Required | As Required |

BATTERY HOUSING  
 TERMINAL HOUSING

ELECTRONICS COVER (LONG) \*\*  
 ELECTRONICS COVER (SHORT) \*\*

HANDWHEEL Ø210  
 M6 EARTH STUD  
 FITTED AS  
 REQUIRED

154 (6.06")  
 Ø  
 MOTOR

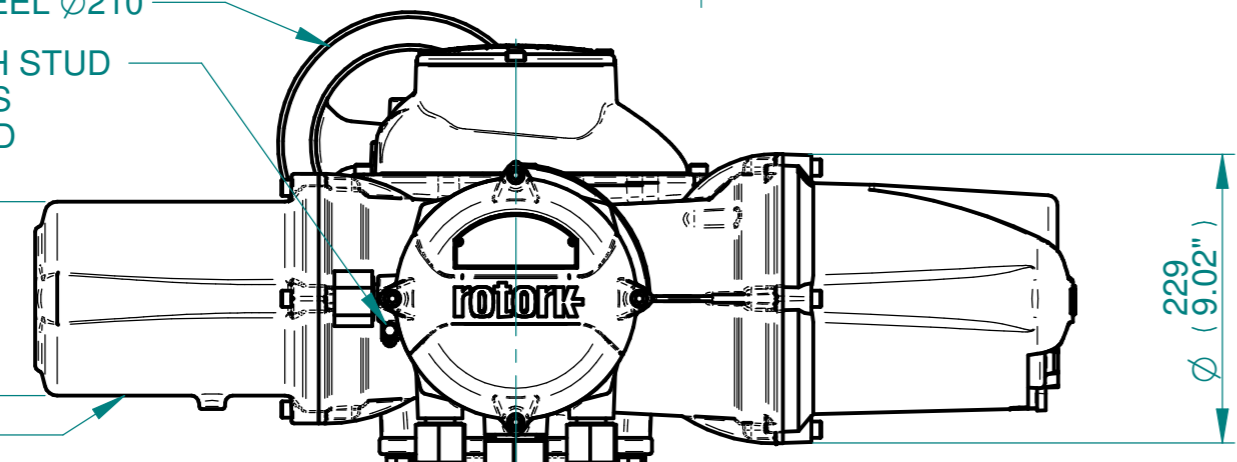

DISPLAY WINDOW  
 LOCAL/REMOTE/STOP  
 SWITCH  
 OPEN/CLOSE SWITCH

CONDUIT ADAPTERS  
 AS REQUIRED  
 (MAX HEIGHT 40.00mm)

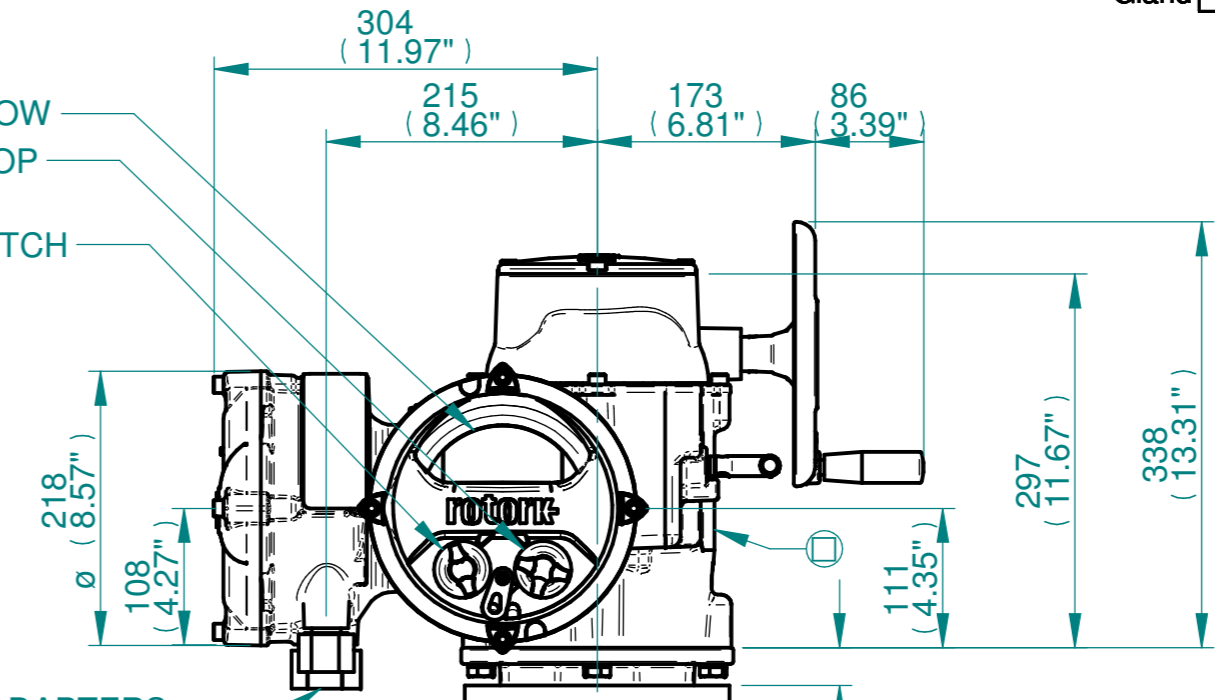

SEE MAXIMUM BORE & KEY TABLE

Ø229.95/229.90 (F30)  
 6.996"/6.994" (FA30)  
 259.95/259.90 (F35)  
 8.496"/8.488" (FA35)

SEE GEARBOX OUTPUT  
 FLANGE OPTIONS TABLE

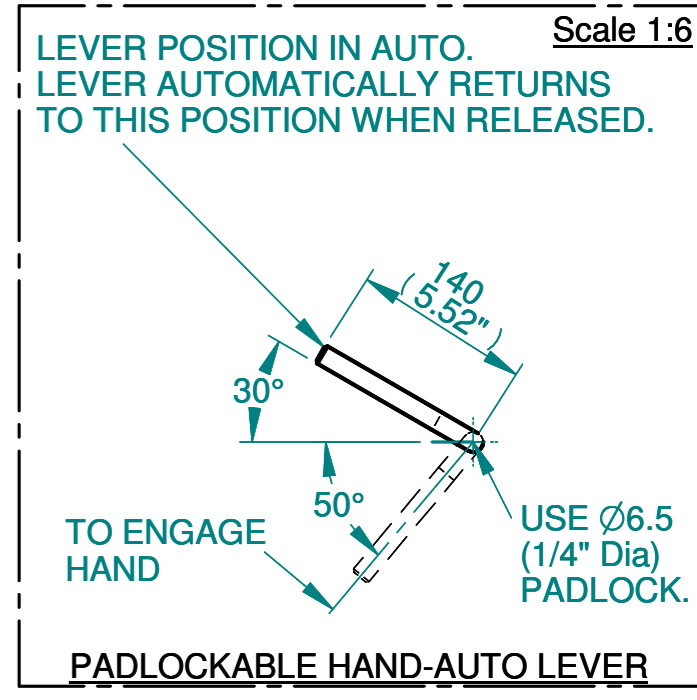

TO SUIT  
 VALVE TRAVEL

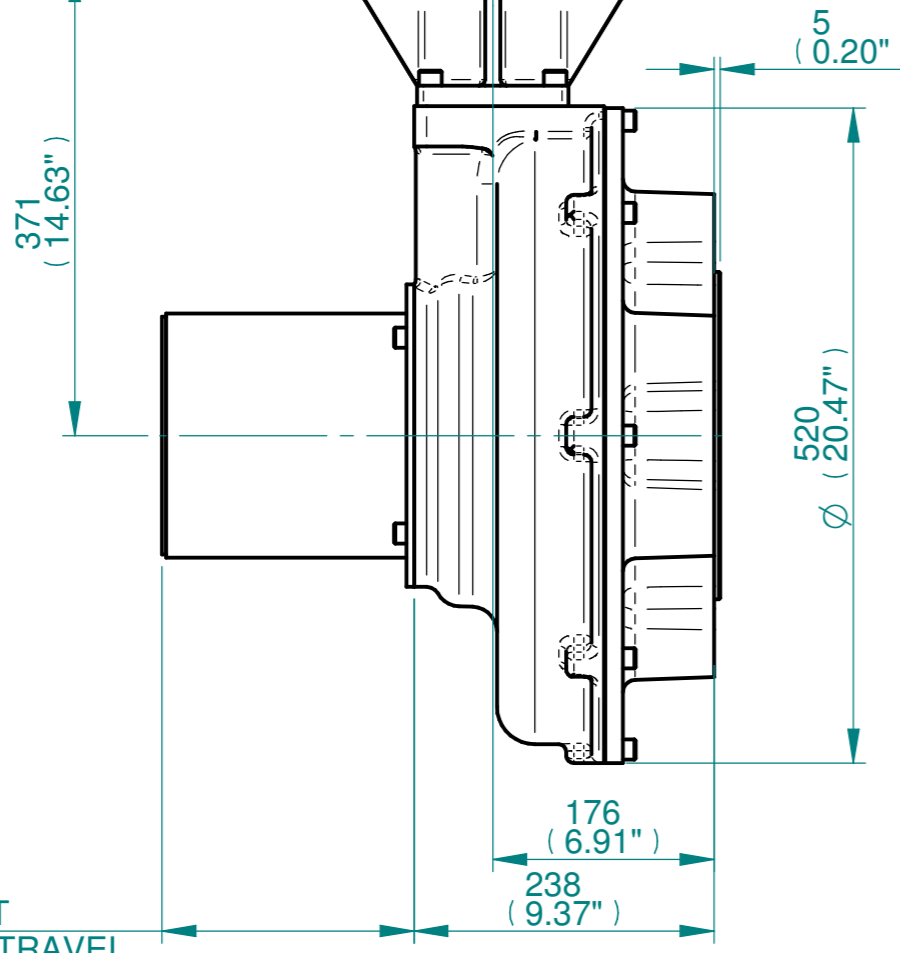

| Actuator Size: IQ35, IB12, F30/F35/FA30/FA35   |             | Gearbox output flange options |     |   |   |          |        |   |   | Maximum Bore & Key     |        |            |
|--|-------------|-------------------------------|-----|---|---|----------|--------|---|---|------------------------|--------|------------|
| Title IQ35, SIDE HANDWHEEL, IB12, F30/F35/FA30/FA35, Ratios 6:1 & 8:1, Installation Details<br>Drawn JLF Checked NJC Date 13-MAR-15<br>Ref Project Ref | Designation | F30                           | F35 | - | - | FA30     | FA35   | - | - | Key form               | Ø Bore | Key size   |
|  | No. Holes   | 8                             | 8   | - | - | 8        | 8      | - | - | Rectangle (BS4235)     | 96     | 28 X 16    |
|  | Hole size   | M20                           | M30 | - | - | 3/4" UNC | 1" UNC | - | - | Rectangle (ANSI B17.1) | 3-3/4" | 7/8 X 5/8" |
|  | PCD         | 298                           | 356 | - | - | 11.75"   | 14"    | - | - | Square (ANSI B17.1)    | 3-1/2" | 7/8"       |

| Issue | Description    |
|-------|----------------|
| 2     | 4 ENTRY CHANGE |

Scale: 1:5 THIRD ANGLE PROJECTION

| Drawing Number | Issue No | Sheet No |
|----------------|----------|----------|
| I13SHWIB12STD  | 2        | 1 of 1   |

**rotork**  
 www.rotork.com  
 Rotork Controls Limited  
 Bath, BA1 3JQ, England.  
 Telephone 01225-733200