

MOUNTING HOLES CAN BE POSITIONED ON CTRS BY REMOVING 8 BOLTS INDICATED AND REPOSITIONING

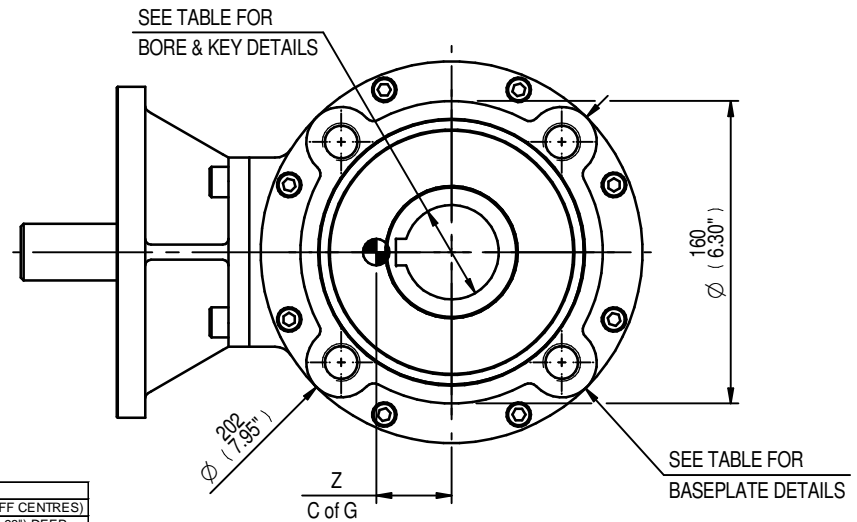
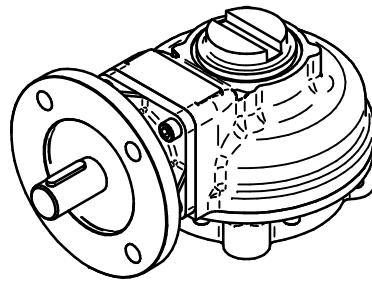
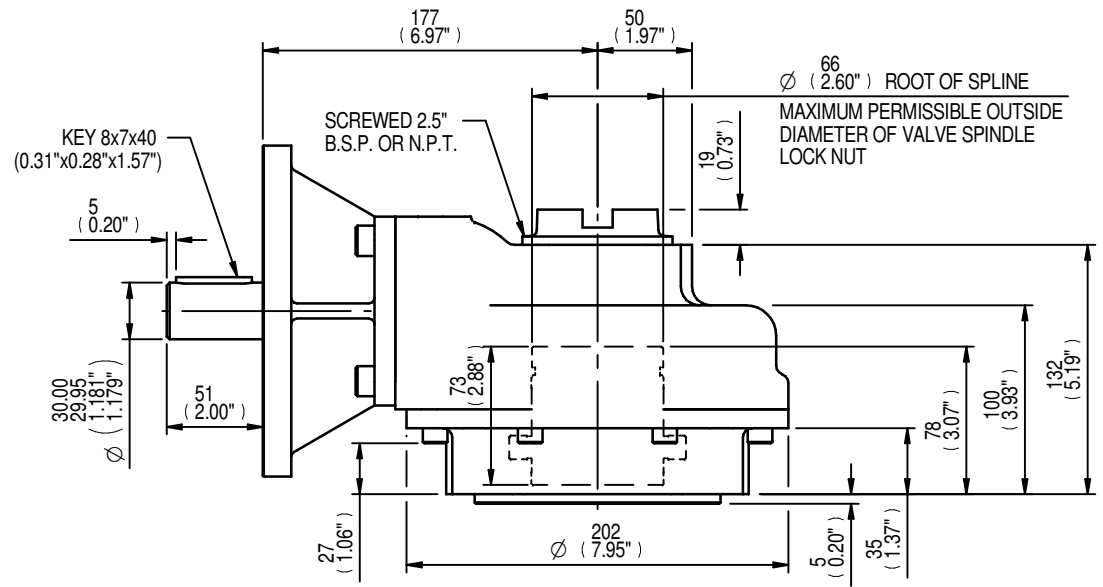

RATIO	M.A.	C.O.G.			MAX OUTPUT TORQUE Nm (lbs.ft)
		X	Y	Z	
2	1.70	0	32	40	306 (225)
3	2.55	0	32	38	678 (500)
4	3.40	0	32	38	678 (500)
6	5.10	0	32	37	542 (400)

MAX BORE SQ KEY			MAX BORE RECTANGULAR KEY		
STD	BORE	KEY	STD	BORE	KEY
BS4235	-	-	BS4235	52.0	16x10
BS46	1.875	1/2" SQ	BS46	2.000	1/2"x5/16"
ANSI B17.1	1.875	1/2" SQ	ANSI B17.1	2.000	1/2"x3/8"

MAX STEM SCREW ACCEPTANCE DIA
55 (2.125")

INPUT FLANGE DETAILS					
ISO	FLANGE	SHAFT	RECESS	RECESS	HOLE DETAILS
	O/DIA. & THICKNESS	DIA.	DIA.	DEPTH	45°(OFF CENTRES)
F14	Ø175 x 15 (Ø6.89" x 0.59")	Ø30.00-0.05 (Ø1.181"-0.002")	Ø100.05+0.05 (Ø3.939"+0.002")	5 (0.20")	4 HOLES Ø16.5 (Ø0.65") ON Ø140.0 (Ø5.51") P.C.
	Ø175 x 15 (Ø6.89" x 0.59")	Ø30.00-0.05 (Ø1.181"-0.002")	Ø95.27+0.05 (Ø3.751"+0.002")	5 (0.20")	4 HOLES Ø16.5 (Ø0.65") ON Ø140.0 (Ø5.51") P.C.

BASEPLATE DETAILS	
ISO	HOLE DETAILS (45° OFF CENTRES)
F16	Ø129.95-0.05 (Ø5.116"-0.002")
F16	Ø126.87-0.25 (Ø4.995"-0.010")



IB5 GEARBOX
F14/FA14 INPUT F16/FA16 OUTPUT

DETAILS SUBJECT TO CHANGE WITHOUT PRIOR NOTICE

FOR UP TO DATE DETAILS VISIT www.rotork.com

APPROX WEIGHT 21.2 kg

DRAWING No	PUBIB5-F14-F16	Regina House Ring Road Bramley Leeds LS134ET United Kingdom
ISSUE	A	
DATE	30/04/2011	