

E-FLANGE INPUT

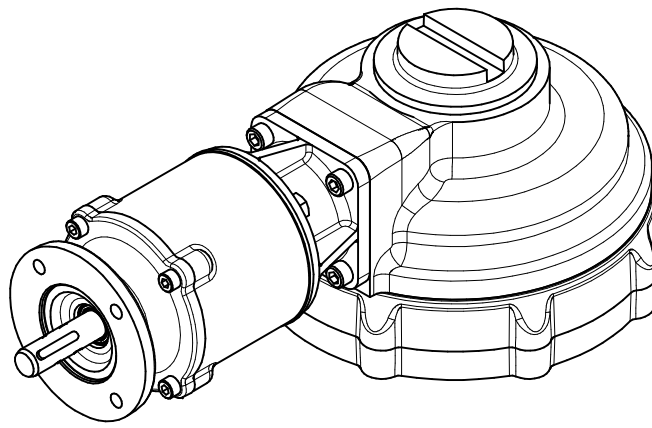

E-FLANGE INPUT  
ISOMETRIC VIEW  
1:5

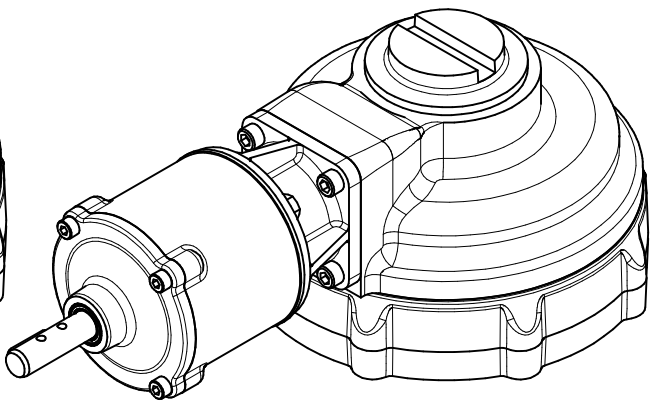

STANDARD INPUT  
ISOMETRIC VIEW  
1:5

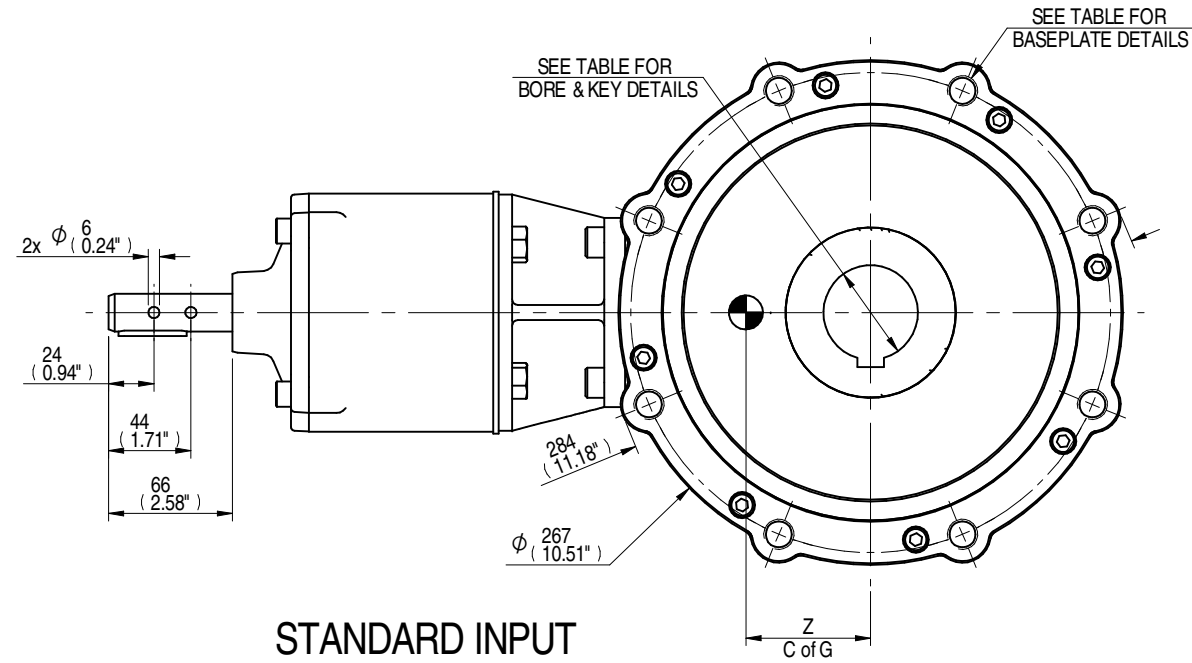

STANDARD INPUT

NOTE:  
MPR IS NOT SUITABLE FOR MOTORISED APPLICATIONS.

| COMMON INPUT DETAILS |                     | E-FLANGE INPUT DETAILS |                  |              |                                |
|----------------------|---------------------|------------------------|------------------|--------------|--------------------------------|
| SHAFT DIA.           | KEY DETAILS         | FLANGE O/DIA.          | RECESS DIA.      | RECESS DEPTH | HOLE DETAILS (45° OFF CENTRES) |
| Ø19.98-0.05          | 6x6x36              | Ø126                   | Ø70.05+0.05      | 3            | 4 HOLES Ø10.5 ON Ø102.0 P.C.   |
| (Ø0.787"-0.002")     | (0.24"x0.24"x1.42") | (Ø4.96")               | (Ø2.758"+0.002") | (0.12")      | 4 HOLES Ø0.41" ON Ø4.02" P.C.  |

| STANDARD | MOUNTING HOLES - BOLT CIRCLE (OFF CENTRES) |   |
|----------|--|---|
|          | SPIGOT DIAMETER                            | HOLE DETAILS (22.5° OFF CENTRES)                            |
| ISO F25  | Ø199.95-0.05<br>(Ø7.872"-0.002")           | 8 HOLES M16X20 (0.79") DEEP<br>ON Ø254.0 (Ø10.00") P.C.     |
| FA25     | Ø152.25-0.25<br>(Ø5.994"-0.010")           | 8 HOLES 5/8"UNCX20 (0.79") DEEP<br>ON Ø254.4 (Ø10.00") P.C. |

| STD        | MAX BORE SQ KEY |         | MAX BORE RECTANGULAR KEY |              | MAX. STEM SCREW ACCEPTANCE DIA. |
|------------|-----------------|---------|--------------------------|--------------|---------------------------------|
|            | BORE            | KEY     | BORE                     | KEY          |                                 |
| BS4235     | -               | -       | 68.0                     | 20x12        | 73 (2.875")                     |
| BS46       | 2.500"          | 5/8" SQ | 2.625"                   | 3/4" x 1/2"  |                                 |
| ANSI B17.1 | 2.500"          | 5/8" SQ | 2.625"                   | 5/8" x 7/16" |                                 |

| MPR  | RATIO  | OUTPUT  | INPUT  | MA   | X | Y  | Z  |
|------|--------|---------|--------|------|---|----|----|
| MPR4 | 16.7:1 | 1656 Nm | 137 Nm | 12.1 | 0 | 47 | 58 |
| MPR6 | 24:1   | 1700 Nm | 98 Nm  | 17.3 | 0 | 47 | 60 |

AS PART OF CONTINUOUS PRODUCT DEVELOPMENT, ALL DETAILS SUBJECT TO CHANGE WITHOUT PRIOR NOTICE. FOR UP TO DATE DETAILS PLEASE VISIT [www.rotork.com](http://www.rotork.com)

| Rev | EC | Revised     | Approved | Date       | Change Description              |
|-----|----|-------------|----------|------------|---------------------------------|
| 01  | -  | J DICKINSON | J DODD   | 29/05/2015 | OUTPUT CORRECTED TO OFF CENTRES |
| A   | -  | -           | -        | 22/04/2014 | FIRST ISSUE                     |

This drawing is confidential and is the property of Rotork Gears and must not be reproduced either wholly or partly. All rights in respect of patents, designs and copyrights are reserved. © 2014

|               |                  |                  |          |
|---------------|------------------|------------------|----------|
| Document type | <b>PUBLICITY</b> | Mass             | 47.54 kg |
| Created       |                  | Dimensions in mm |          |
| Checked       |                  | Scale 1:4        |          |
| Approved      |                  | Title            |          |

|          |  |              |  |            |  |                          |  |         |  |
|----------|--|--------------|--|------------|--|--------------------------|--|---------|--|
| Created  |  | J. DICKINSON |  | 22/04/2014 |  | Drawing Number           |  | Rev     |  |
| Checked  |  | T. WITAMORE  |  | 14/05/2014 |  | <b>PUB-HOB7MPR46-F25</b> |  | 01      |  |
| Approved |  | -            |  | -          |  | Sheet 1 of 1             |  | Size A3 |  |