

1		2			3		4			5		6			7		8
INPUT FLANGE DETAILS							MOUNTING HOLES - BOLT CIRCLE (OFF CENTRES)			STEM ACCEPTANCE IN ACCORDANCE TO STANDARD							
INPUT FLANGE	FLANGE O/DIA. + THICKNESS	SHAFT DIA.	RECESS DIA.	RECESS DEPTH	HOLE DETAILS (OFF CENTRES)	KEY DETAILS	ISO 5211 / MSS SP-101 MOUNTING OPTION	HOLE DETAILS (45° OFF CENTRES)	SPIGOT DIAMETER	MAX SCREW STEM ACCEPTANCE	STANDARD	MIN BORE	SQ KEY MAX BORE	SQ KEY SIZE	RECT. KEY MAX BORE	RECT. KEY SIZE	SQ BORE MAX
-	-	19.98-0.05 (0.787"-0.002")	-	-	-	6x6x40 (0.24"x0.24"x1.57")	F14	4xM16x20 (0.79") DEEP ON Ø140 (Ø5.51") P.C.	Ø99.95-0.05 (Ø3.935"-0.002")	55 (2.125")	BS4235	-	-	-	52.0	16 x 10	□ 40 (1.575")
							FA14	4x5/8"UNCx20 (0.79") DEEP ON Ø139.7 (Ø5.50") P.C.	Ø95.22-0.10 (Ø3.749"-0.004")		BS46	-	1.875"	1/2" SQ.	2.000"	1/2" x 5/16"	
											ANSI B17.1	-	1.875"	1/2" SQ.	2.000"	1/2" x 3/8"	
											DIN 6885	-	-	-	-	-	

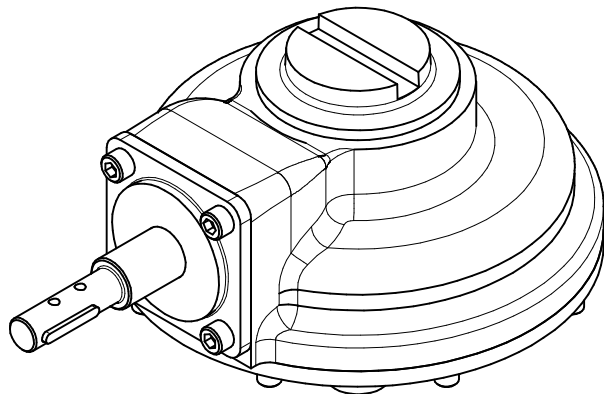

ISOMETRIC  
1:4

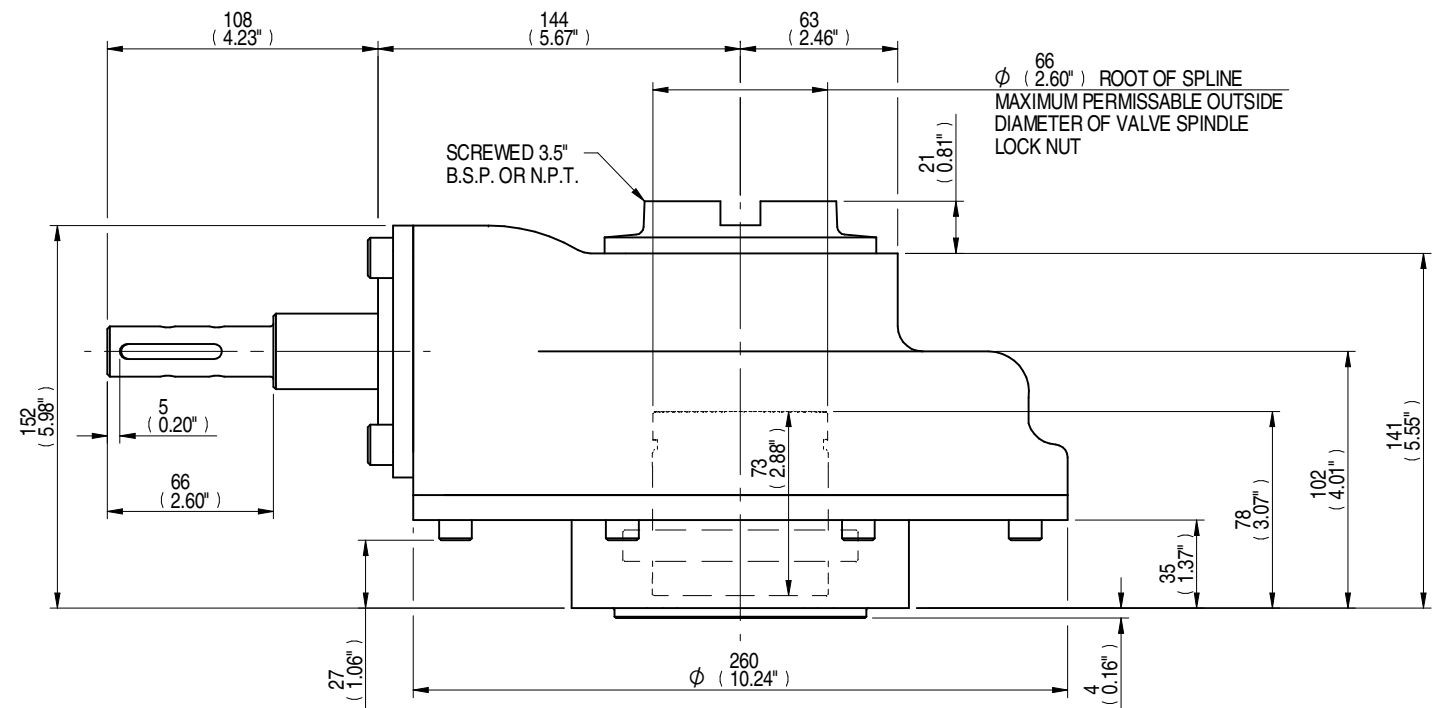
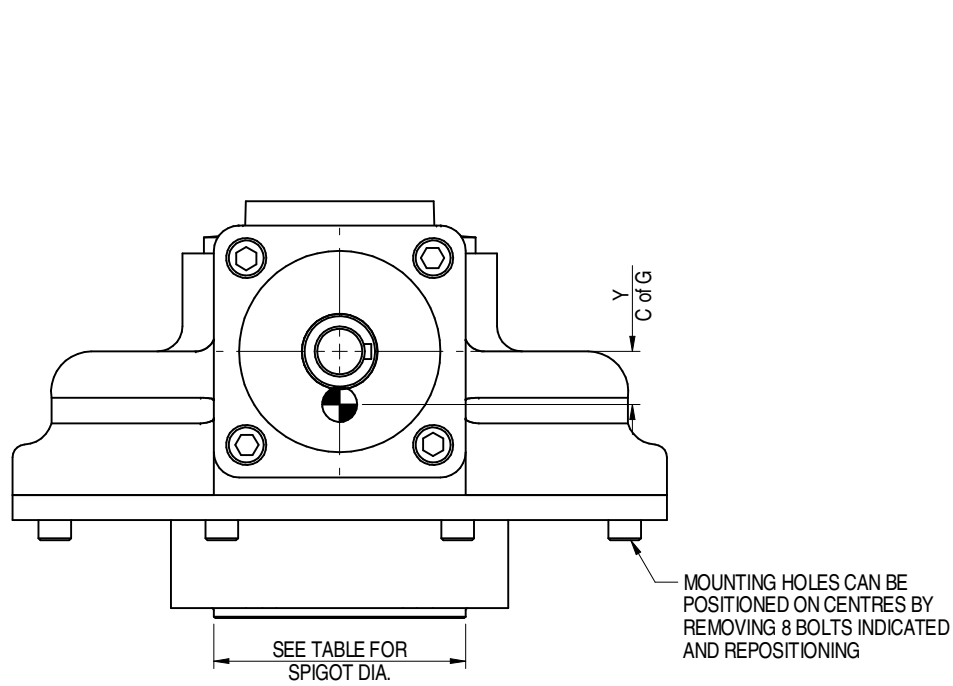
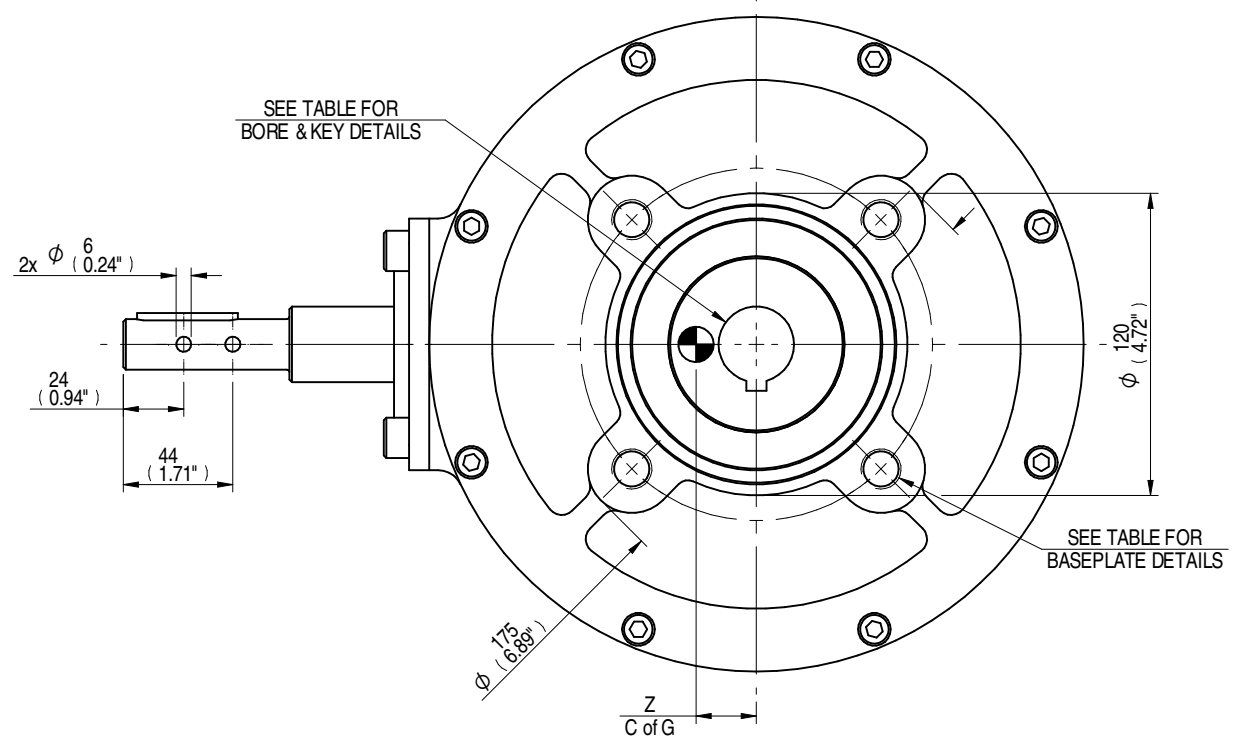

PLAN VIEW OF GEARBOX IN CLOSED POSITION SHOWING STANDARD KEYWAY POSITIONS. ALTERNATIVES AVAILABLE ON REQUEST

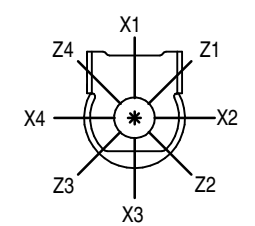

RATIO	M.A.	WEIGHT	MAX OUTPUT	MAX INPUT	X	Y	Z
6:1	5.1	24.39 kg	1355	265	0	32	16
4:1	3.4	24.58 kg	1700	500	0	32	16
DESCRIPTION	TORQUE		CENTRE OF GRAVITY				

AS PART OF CONTINUOUS PRODUCT DEVELOPMENT, ALL DETAILS SUBJECT TO CHANGE WITHOUT PRIOR NOTICE. FOR UP TO DATE DETAILS PLEASE VISIT [www.rotork.com](http://www.rotork.com)

**rotork** Gears  
LEEDS - UK  
[www.rotork.com](http://www.rotork.com)

This drawing is confidential and is the property of Rotork Gears and must not be reproduced either wholly or partly. All rights in respect of patents, designs and copyrights are reserved. © 2015

Document Type	<b>PUBLICITY</b>	Mass	<b>24.39 kg</b>	Title	<b>HOB6 GEARBOX MANUAL INPUT F14/FA14 OUTPUT</b>
Created	<b>J. DICKINSON</b>	30/03/2015	Dimensions in mm	Scale <b>1:3</b>	
Checked	<b>R. DIX</b>	31/03/2015	Drawing Number	<b>PUB-HOB6-F14</b>	Iss. <b>01</b>
Approved	-	-	Sheet	<b>1 of 1</b>	Size <b>A3</b>