

1	2		3		4			5		6			7			8				
INPUT FLANGE DETAILS	MOUNTING HOLES - BOLT CIRCLE (OFF CENTRES)	STEM ACCEPTANCE IN ACCORDANCE TO STANDARD	INPUT FLANGE	FLANGE O/DIA. + THICKNESS	SHAFT DIA.	RECESS DIA.	RECESS DEPTH	HOLE DETAILS (OFF CENTRES)	KEY DETAILS	ISO 5211 / MSS SP-101 MOUNTING OPTION	HOLE DETAILS (45° OFF CENTRES)	SPIGOT DIAMETER	MAX SCREW STEM ACCEPTANCE	STANDARD	MIN BORE	SQ KEY MAX BORE	SQ KEY SIZE	RECT. KEY MAX BORE	RECT. KEY SIZE	SQ BORE MAX
-	-	19.98-0.05 (0.787"-0.002")	-	-	-	-	-	6x6x40 (0.24"x0.24"x1.57")	6x6x40 (0.24"x0.24"x1.57")	F16	4xM20x25 (0.98") DEEP ON Ø165 (Ø6.50") P.C.	Ø129.95-0.05 (Ø5.116"-0.002")	55 (2.125")	BS4235	-	-	-	52.0	16 x 10	□ 40 (1.575")
-	-	-	-	-	-	-	-	6x6x40 (0.24"x0.24"x1.57")	FA16	4x3/4"UNCx25 (0.98") DEEP ON Ø165.1 (Ø6.50") P.C.	Ø126.87-0.25 (Ø4.995"-0.010")	BS46		-	1.875"	1/2" SQ.	2.000"	1/2" x 5/16"		
-	-	-	-	-	-	-	-	-	-	-	-	-		ANSI B17.1	-	1.875"	1/2" SQ.	2.000"	1/2" x 3/8"	
-	-	-	-	-	-	-	-	-	-	-	-	-		DIN 6885	-	-	-	-	-	

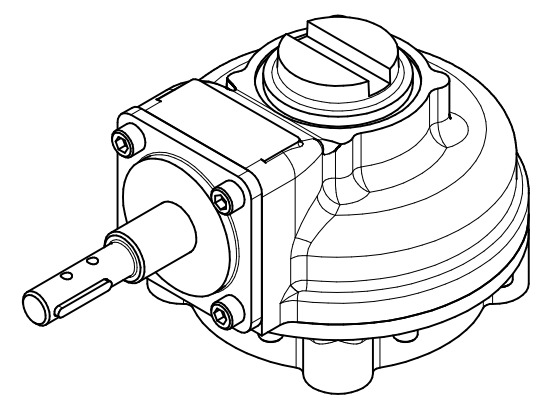

ISOMETRIC  
1:4

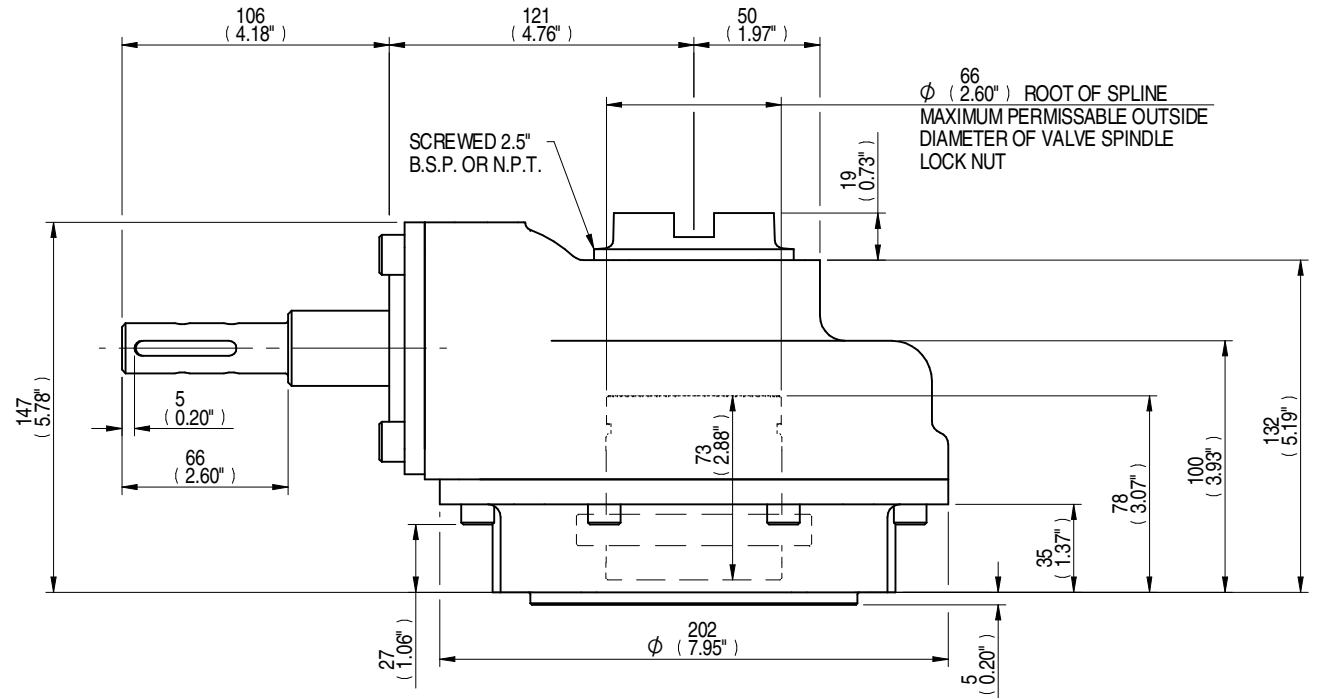
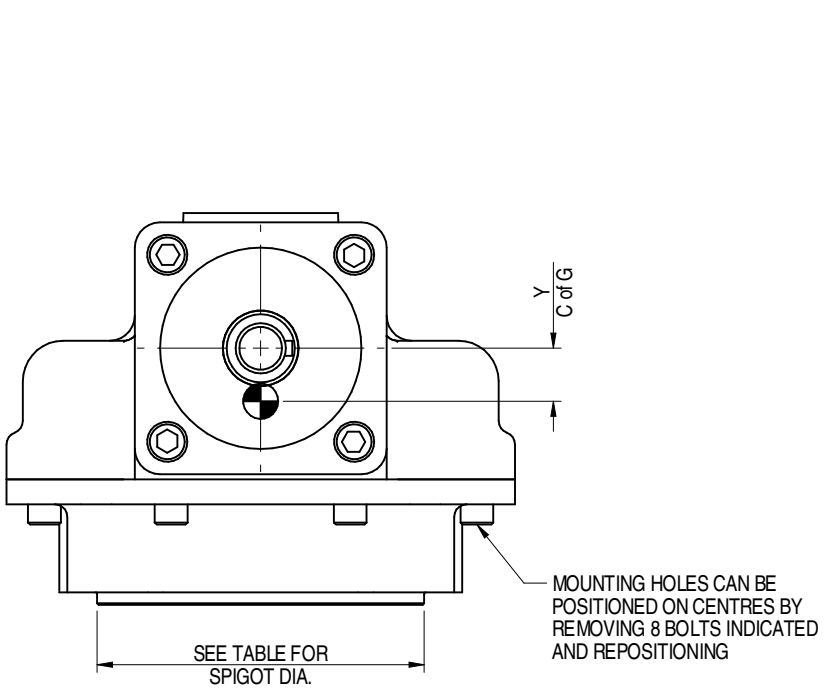
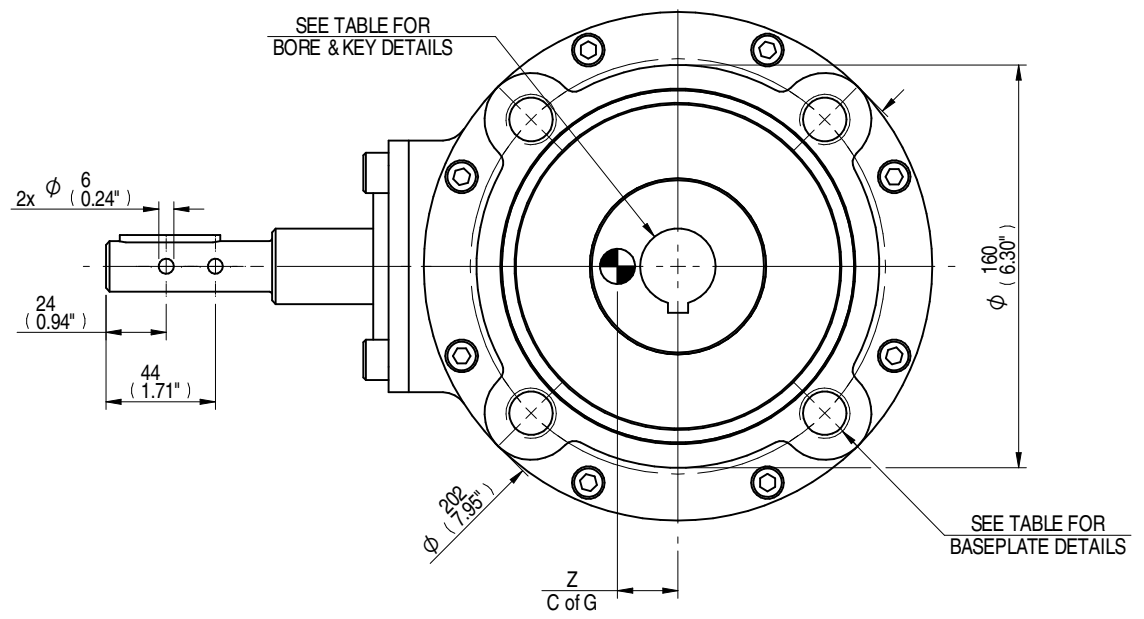

PLAN VIEW OF GEARBOX IN CLOSED POSITION SHOWING STANDARD KEYWAY POSITIONS. ALTERNATIVES AVAILABLE ON REQUEST

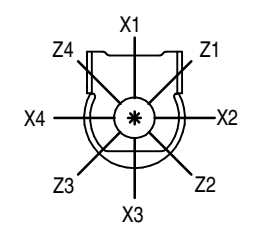

DESCRIPTION	TORQUE	CENTRE OF GRAVITY
6:1	5.1	19.79 kg
4:1	3.4	19.94 kg
RATIO	M.A.	WEIGHT
	MAX OUTPUT	MAX INPUT
	X	Y
	Z	

AS PART OF CONTINUOUS PRODUCT DEVELOPMENT, ALL DETAILS SUBJECT TO CHANGE WITHOUT PRIOR NOTICE. FOR UP TO DATE DETAILS PLEASE VISIT [www.rotork.com](http://www.rotork.com)

**rotork** Gears  
LEEDS - UK  
[www.rotork.com](http://www.rotork.com)

This drawing is confidential and is the property of Rotork Gears and must not be reproduced either wholly or partly. All rights in respect of patents, designs and copyrights are reserved. © 2015

Document Type	<b>PUBLICITY</b>	Mass	<b>19.79 kg</b>	Title	<b>HOB5 GEARBOX MANUAL INPUT F16/FA16 OUTPUT</b>
Created	<b>J. DICKINSON</b>	Dimensions in mm		Drawing Number	<b>PUB-HOB5-F16</b>
Checked	<b>R. DIX</b>	Scale	<b>1:3</b>	Iss.	<b>01</b>
Approved	-			Sheet	<b>1 of 1</b>
				Size	<b>A3</b>