

1		2			3		4			5		6			7		8
INPUT FLANGE DETAILS							MOUNTING HOLES - BOLT CIRCLE (OFF CENTRES)			STEM ACCEPTANCE IN ACCORDANCE TO STANDARD							
INPUT FLANGE	FLANGE O/DIA. + THICKNESS	SHAFT DIA.	RECESS DIA.	RECESS DEPTH	HOLE DETAILS (OFF CENTRES)	KEY DETAILS	ISO 5211 / MSS SP-101 MOUNTING OPTION	HOLE DETAILS (45° OFF CENTRES)	SPIGOT DIAMETER	MAX SCREW STEM ACCEPTANCE	STANDARD	MIN BORE	SQ KEY MAX BORE	SQ KEY SIZE	RECT. KEY MAX BORE	RECT. KEY SIZE	SQ BORE MAX
-	-	19.98-0.05 (0.787"-0.002")	-	-	-	6x6x40 (0.24"x0.24"x1.57")	F10	4xM10x15 (0.59") DEEP ON Ø102 (Ø4.02") P.C.	Ø69.95-0.05 (Ø2.754"-0.002")	45 (1.750")	BS4235	-	-	-	40.0	12 x 8	□ 31.6 (1.244")
							FA10	4x3/8"UNCx15 (0.59") DEEP ON Ø101.6 (Ø4.00") P.C.	Ø58.70-0.10 (Ø2.311"-0.004")		BS46	-	1.500"	3/8" SQ.	1.625"	7/16" x 5/16"	
											ANSI B17.1	-	1.500"	3/8" SQ.	1.625"	3/8" x 1/4"	
											DIN 6885	-	-	-	-	-	

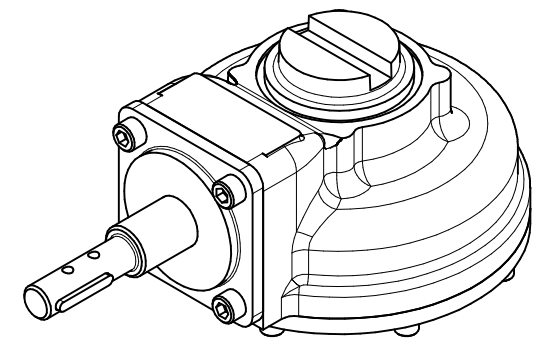

ISOMETRIC
1:4

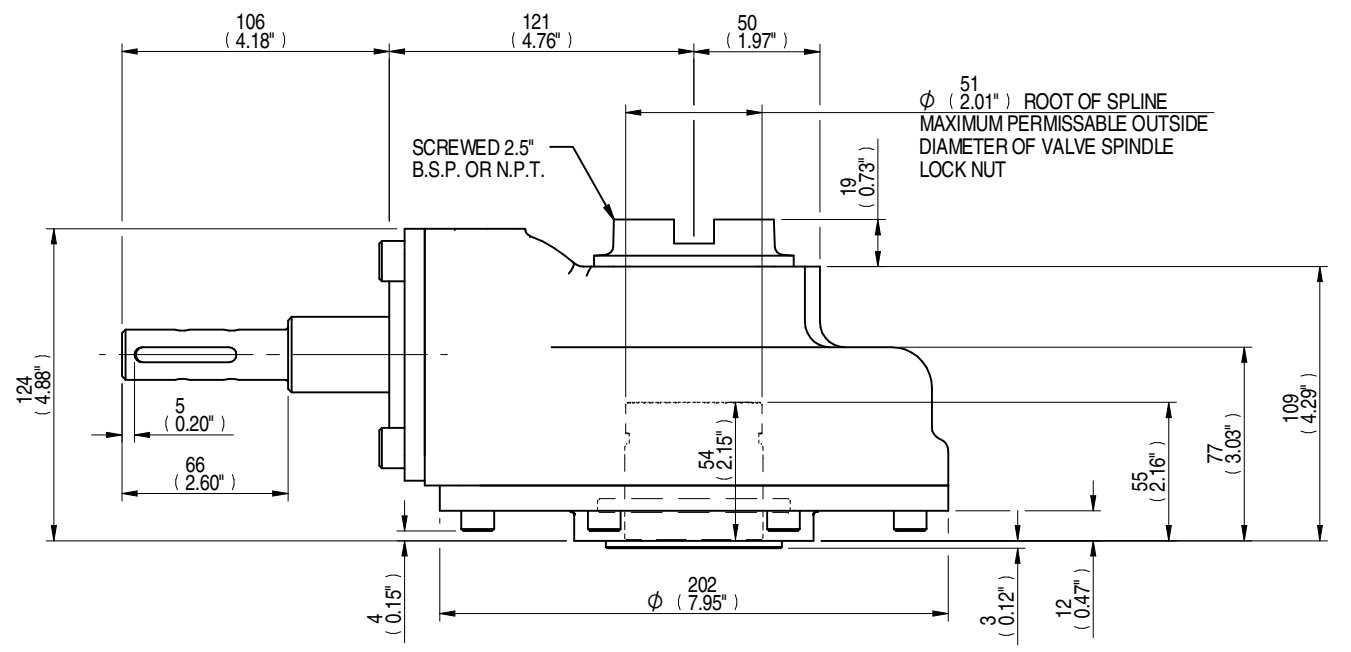
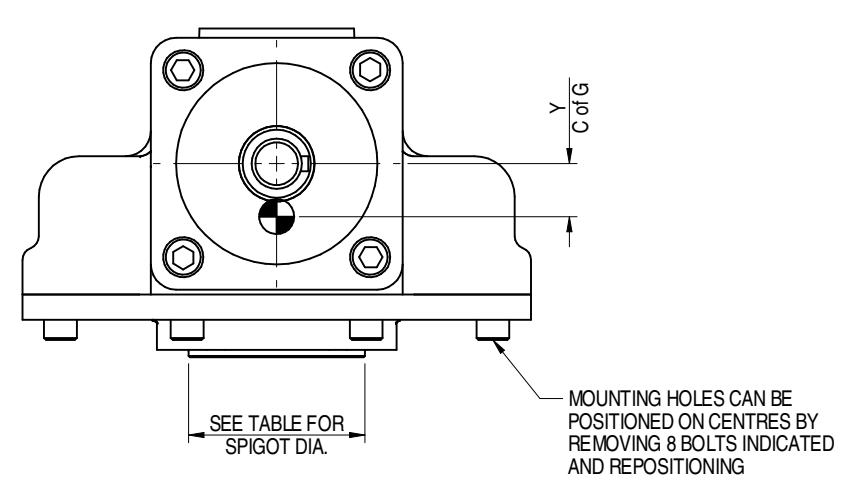
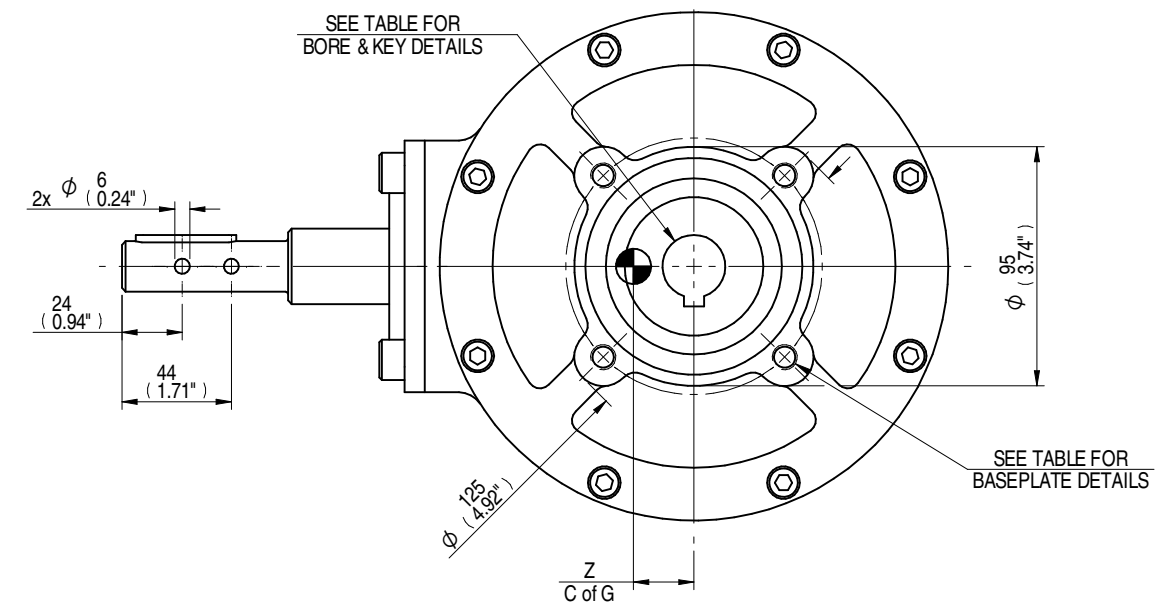

PLAN VIEW OF GEARBOX IN CLOSED POSITION SHOWING STANDARD KEYWAY POSITIONS. ALTERNATIVES AVAILABLE ON REQUEST

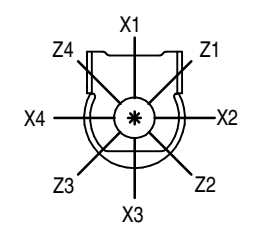

RATIO	M.A.	WEIGHT	MAX OUTPUT	MAX INPUT	X	Y	Z
6:1	5.1	14.39 kg	680	133	0	22	21
4:1	3.4	14.07 kg	850	250	0	22	23
2:1	1.7	13.46 kg	380	223	0	21	24
DESCRIPTION	TORQUE		CENTRE OF GRAVITY				

AS PART OF CONTINUOUS PRODUCT DEVELOPMENT, ALL DETAILS SUBJECT TO CHANGE WITHOUT PRIOR NOTICE. FOR UP TO DATE DETAILS PLEASE VISIT www.rotork.com

rotork Gears
LEEDS - UK
www.rotork.com

This drawing is confidential and is the property of Rotork Gears and must not be reproduced either wholly or partly. All rights in respect of patents, designs and copyrights are reserved. © 2015

Document Type	PUBLICITY	Mass	14.39 kg	Title	HOB4 GEARBOX MANUAL INPUT F10/FA10 OUTPUT	
Created	J. DICKINSON	30/03/2015	Dimensions in mm	Scale 1:3		
Checked	R. DIX	31/03/2015	Drawing Number	PUB-HOB4-F10		
Approved	-	-	Sheet	1	of	1
			Size	A3		

Iss. 01