

DESCRIPTION		MOUNTING HOLES - BOLT CIRCLE (OFF CENTRES)			BORE: STEM ACCEPTANCE WITH KEYWAY IN ACCORDING WITH STANDARD			TORQUE					
RATIO	TURNS TO CLOSE	TRAVEL (1/4 TURN)	WEIGHT	NR of HOLES	MIN PCD - ØHOLE	MAX PCD + ØHOLE	ACCORDING TO ISO 5211 / MSS SP-101	MIN	MAX	STANDARD	OUTPUT	INPUT	MA
109:1	27	-5° TO 95°	29 kg	4	Ø 145 mm	Ø 185 mm	F16	Ø35 mm	Ø80 mm	ISO 773 A	4500 Nm	136 Nm	33 ± 15%
				8	Ø188 mm	Ø270 mm	F25						
			64 lbs	4	Ø 5.709 inch	Ø 7.283 inch	FA16	Ø1.38 inch	Ø2.76 inch	ANSI B17.1	39,828 lbf.in	1204 lbf.in	
				8	Ø7.40 inch	Ø10.62 inch	FA25						

AS PART OF CONTINUOUS PRODUCT DEVELOPMENT, ALL DETAILS SUBJECT TO CHANGE WITHOUT PRIOR NOTICE. FOR UP TO DATE DETAILS PLEASE VISIT [www.rotork.com](http://www.rotork.com)

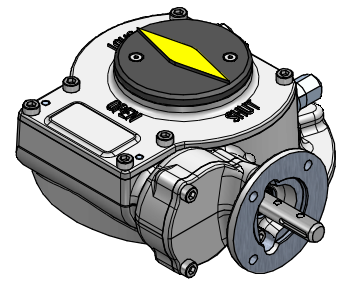
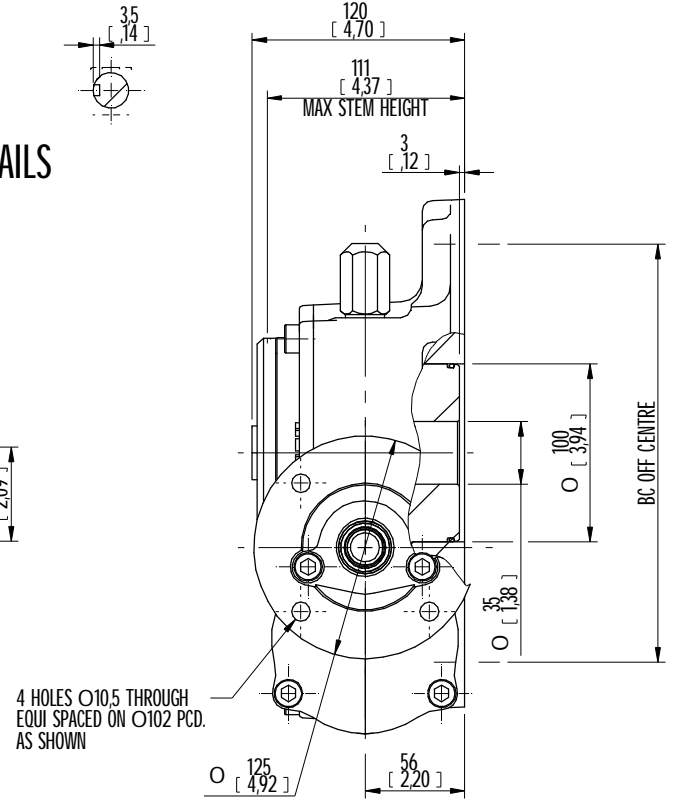
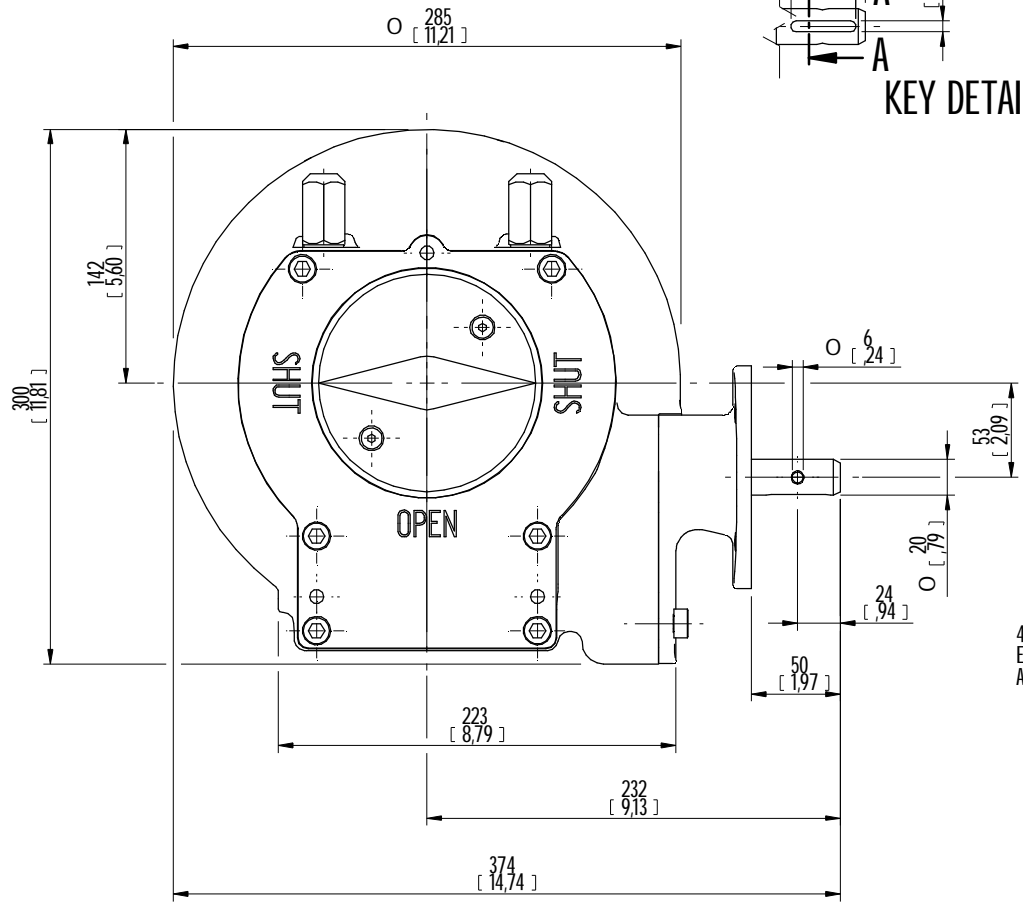
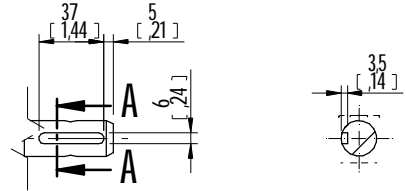
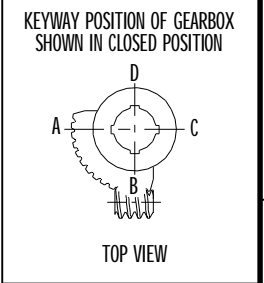

ISOMETRIC VIEW  
1:5

00				DD-MMM-YYYY	FIRST ISSUE
Rev	CN	Revised	Approved	Date	Change Description

 <b>rotork</b> Gears LOSSER - NETHERLANDS <a href="http://www.rotork.com">www.rotork.com</a>	Document type <b>DETAIL DRAWING</b> Dimensions in mm Scale 1:3	Title <b>E2000 G-TYPE ASSEMBLY F25 BASE, LH PROJECTION WITH E-FLANGE</b>	
		Created <b>M R</b> Checked <b>P LINE</b> Approved -	13-12-2012 28-2-2013 DD-MMM-YYYY
Sheet 1 of 3 Size A3			

Rev 01