

NOTES:

1. MAX. ALLOWABLE OPERATING PRESSURE (MAOP) = 10 BAR (150PSIG)
2. WARNING - SEE ROTORK INSTALLATION, OPERATION & MAINTENANCE MANUAL BEFORE MOUNTING, INSTALLING OR SERVICING.
3. ACTUATOR SHOWN IN FULL CW POSITION, SCRIBE MARK ON SHAFT SHOWS VANE LOCATION.
4. WEIGHT 100 kg (221 LB.)
5. RESTRICTED TRAVEL VERSIONS OPTIONAL.

AIR PORTS SIZE SEE TABLE
(STAGGERED)

	IMPERIAL	METRIC
THREAD SIZE	1 1/8-7 UNC	M30 x 3.5
AIR PORT SIZE	1/2-14 NPT	G1/2

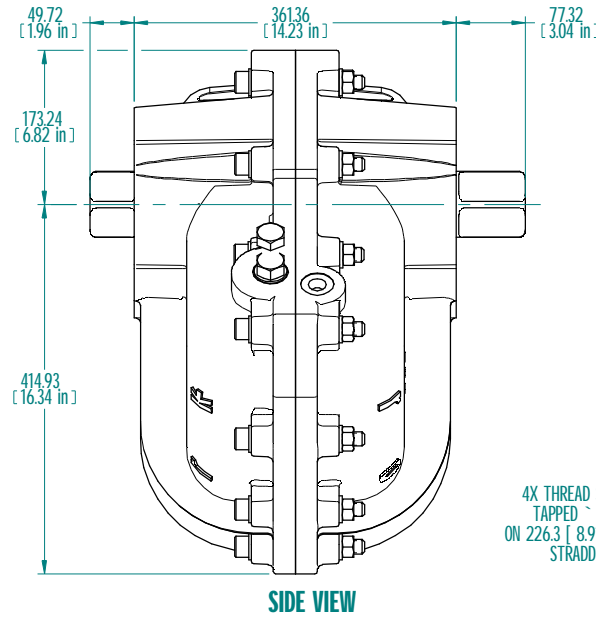
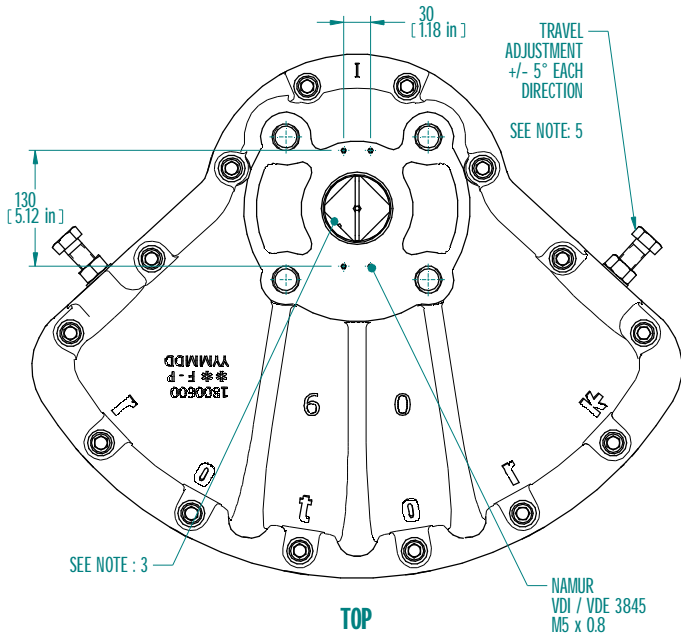
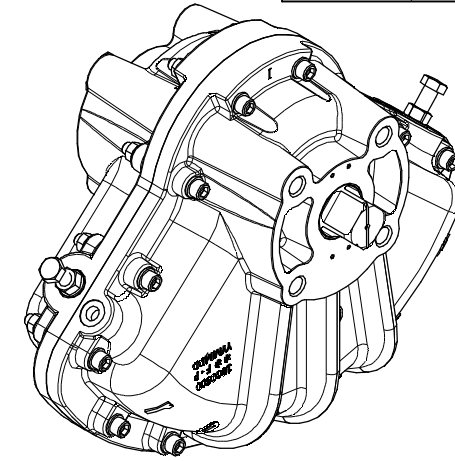
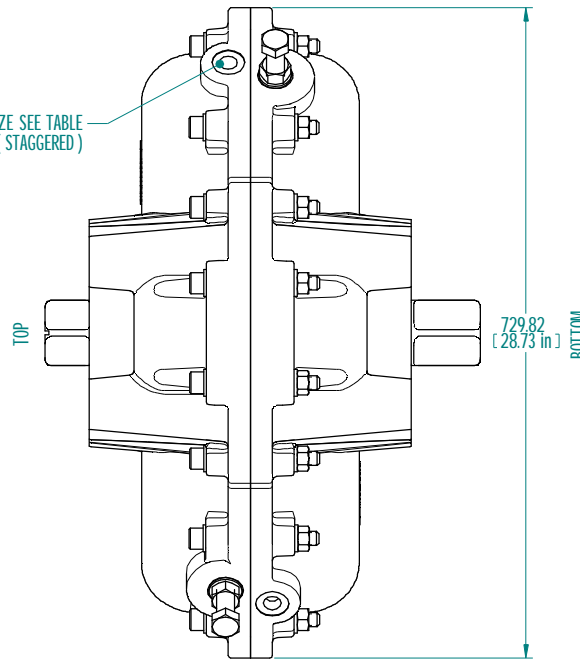
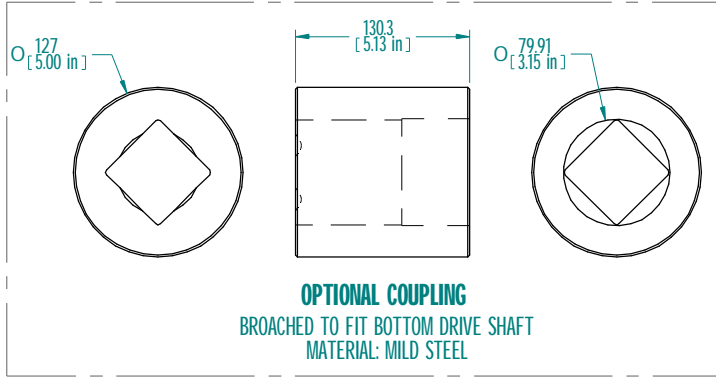

4X THREAD SIZE SEE TABLE
TAPPED ~ 50.8 [2.0 in]
ON 226.3 [8.91] BOLT CIRCLE
STRADDLE CENTER LINE

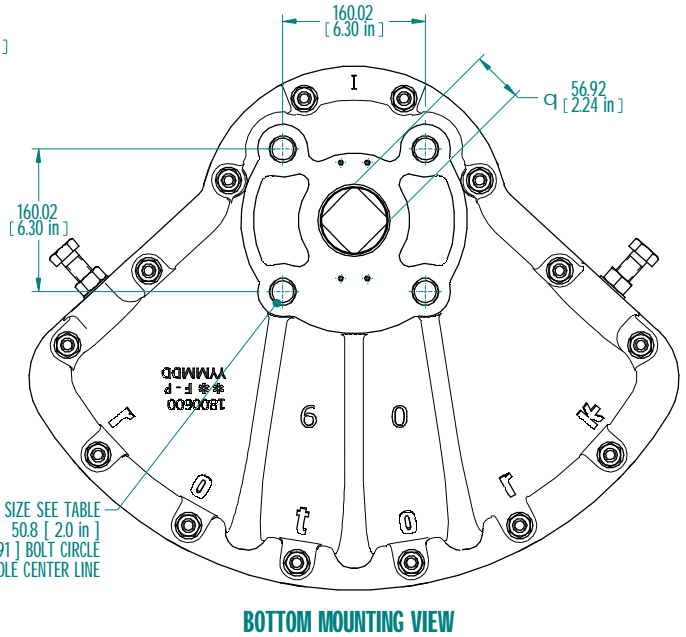

C	K.SEKAR	K.PRICE	06-MAR-2017	METRIC VERSION ADDED	
B	K.SEKAR	K.PRICE	15-JUL-2015	DESCRIPTION UPDATED	
A	K.SEKAR	K.PRICE	15-JUN-2015	REDRAWN: SOLID EDGE 3D	
Rev	ECN	Revised	Approved	Date	Change Description

rotork This drawing is confidential and is the property of Rotork Dallas Inc. and must not be reproduced either wholly or partly. All rights in respect of patents, designs and copyrights are reserved. © 2015

Dallas, Texas - USA
www.rotork.com

Document type			GENERAL ARRANGEMENT		Title	
Created			K.SEKAR		KT-60-DA	
Checked			S.SUDHR		IMPERIAL AIR PORTS & MOUNTING HOLES	
Approved			K.PRICE		Drawing Number	
			15-JUN-2015		D000000207	
			15-JUN-2015		Sheet 1 of 1	
			15-JUN-2015		Size A3	

Rev C