

- NOTES:**
- 1) MAX ALLOWABLE OPERATING PRESSURE (MAOP) = 10 BAR (150 PSIG)
 - 2) WARNING - SEE K-TORK INSTALLATION, OPERATION & MAINTENANCE MANUAL BEFORE MOUNTING, INSTALLING OR SERVICING.
 - 3) ACTUATOR SHOWN IN FULL CW POSITION, FLAT ON SHAFT SHOWS VANE LOCATION.
 - 4) WEIGHT 18.33 kg (40.40 LB.)
 - 5) RESTRICTED TRAVEL VERSIONS OPTIONAL.

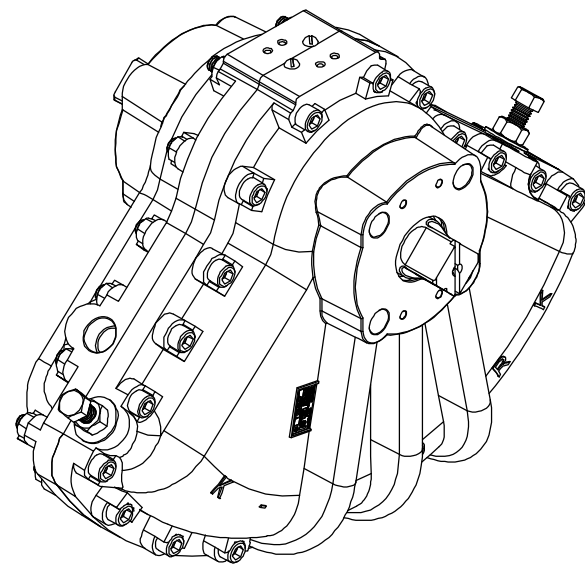

NAMUR VDI/VDE 3845
MOUNTING FOR SOLENOID VALVE
10-24 UNC

AIR PORTS
1/2" NPT
(STAGGERED)

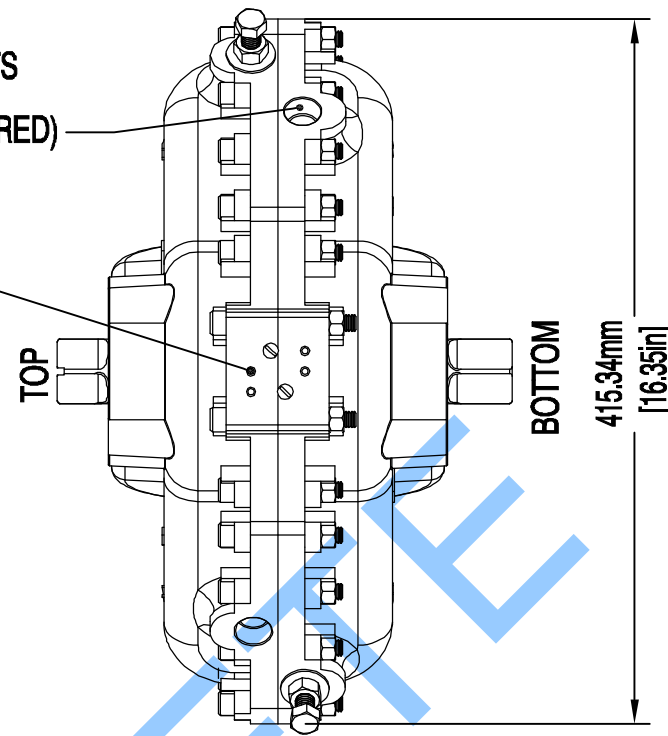

TRAVEL
ADJUSTMENT
+/- 5° EACH
DIRECTION

SEE NOTE: 5

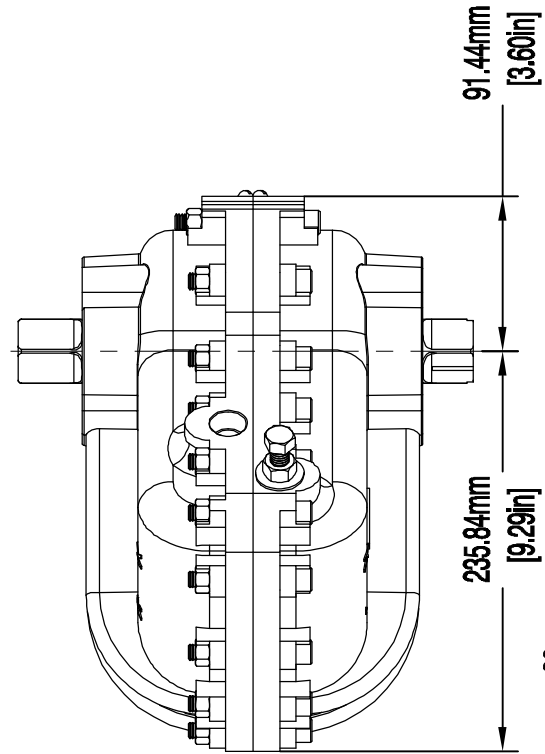

SIDE VIEW

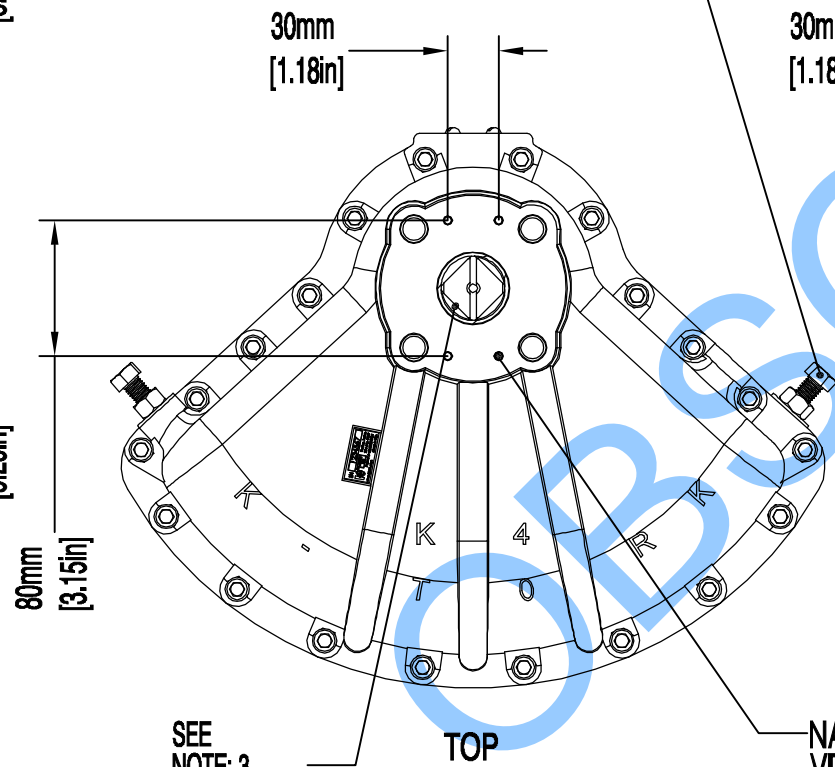

TOP

NAMUR
VDI/VDE 3845
M5 x .8

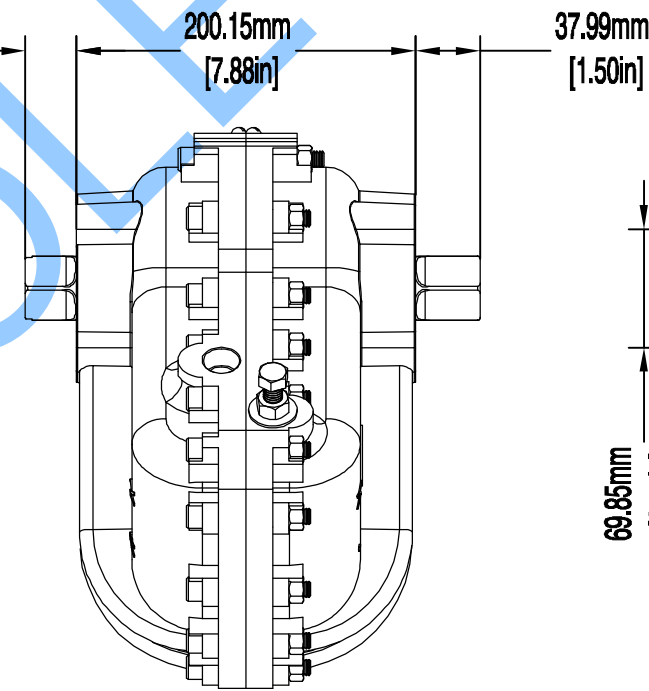

SIDE VIEW

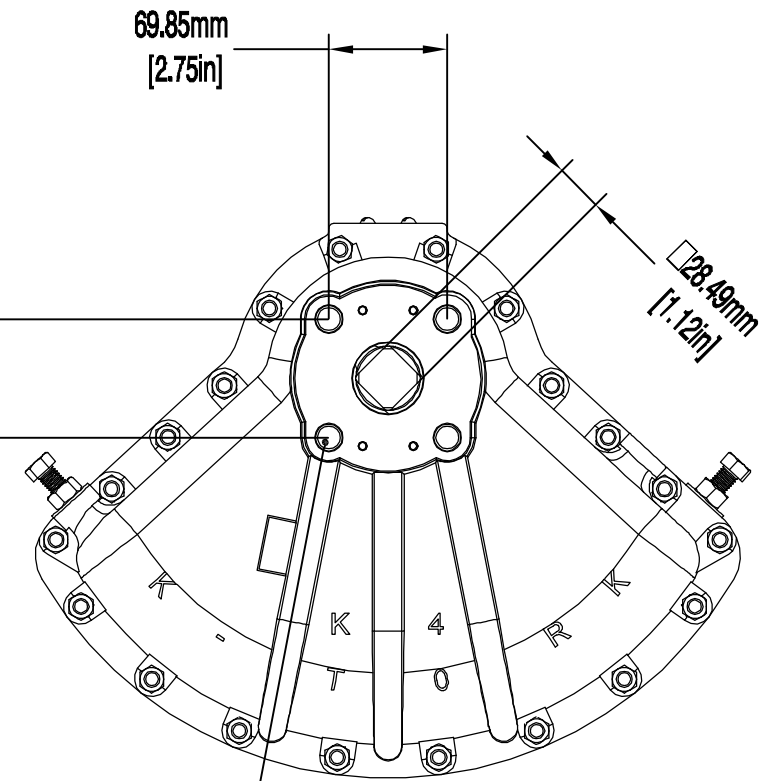

BOTTOM
MOUNTING VIEW

OPTIONAL COUPLING,
MILD STEEL

Ø57.15mm
[Ø2.25in]

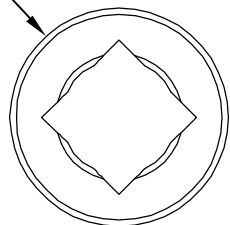

63.50mm
[2.50in]

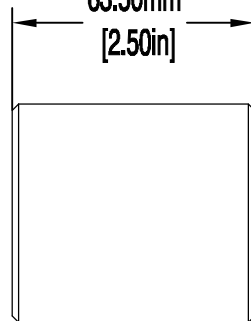

BROACHED TO FIT BOTTOM DRIVE SHAFT



Texas - USA
www.rotork.com

This drawing is confidential and is the property of Rotork Dallas Inc. and must not be reproduced either wholly or partly. All rights in respect of patents, designs and copyrights are reserved. © 2015

Document type	DETAIL DRAWING		Title	
	Dimensions in mm		K-4 DOUBLE-ACTING MODEL	
	Scale 1:1		IMPERIAL AIR PORTS &	
Created	S.DINESH	30-JAN-2015	MOUNTING HOLES	
Checked	S.SUDHIR	30-JAN-2015	Drawing Number	Rev
Approved	K.PRICE	30-JAN-2015	D000000205	0
Sheet 1 of 1			Size	A3