

- NOTES:
 1) MAX ALLOWABLE OPERATING PRESSURE (MAOP) = 10 BAR (150 PSIG)
 2) WARNING - SEE K-TORK INSTALLATION, OPERATION & MAINTENANCE MANUAL BEFORE MOUNTING, INSTALLING OR SERVICING.
 3) ACTUATOR SHOWN IN FULL CW POSITION, SCRIBE ON SHAFT SHOWS VANE LOCATION.
 4) WEIGHT 5.44 KG (12 LB.)
 5) RESTRICTED TRAVEL VERSIONS OPTIONAL.

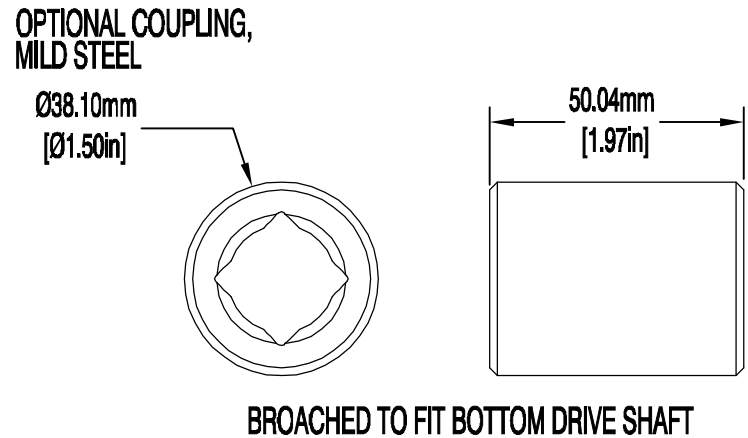

(4 PLACES)
3/8-16 UNC-2B
TAPPED 19.1mm (.75in) DEEP,
64.4mm (2.54in) BOLT CIRCLE STRADDLE ϕ

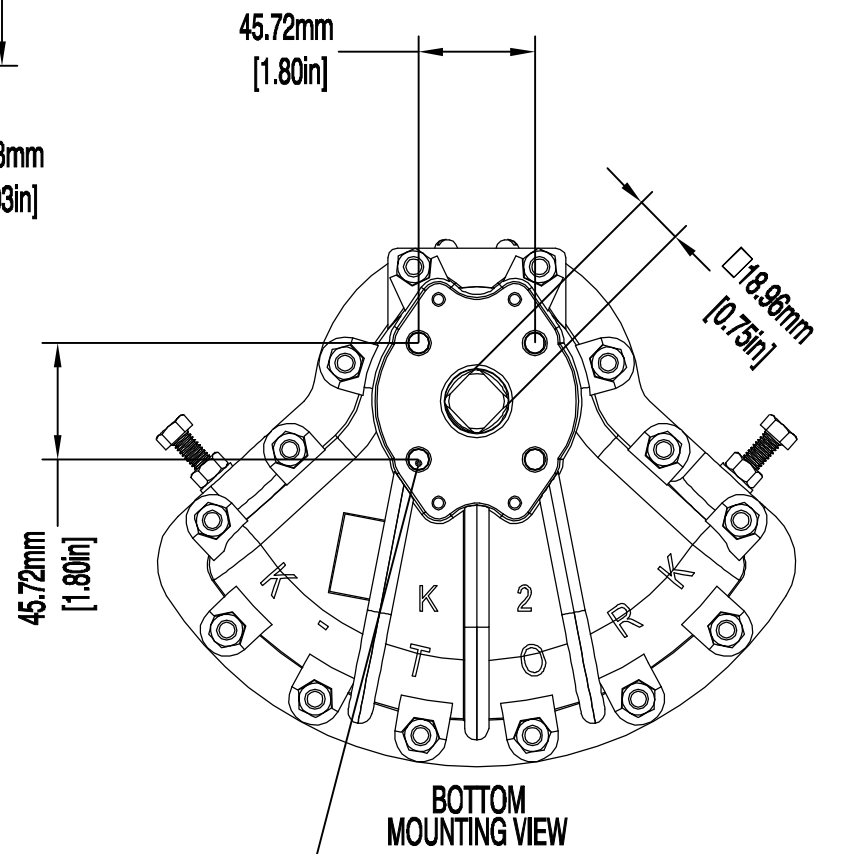
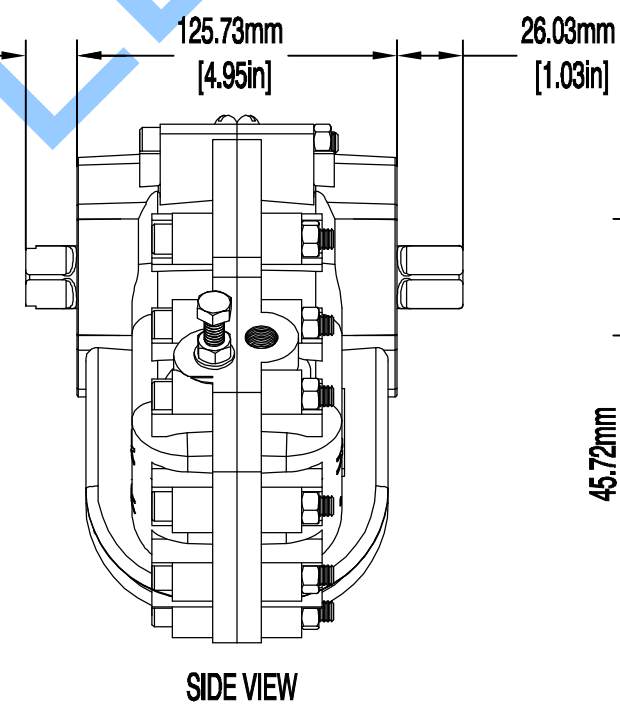
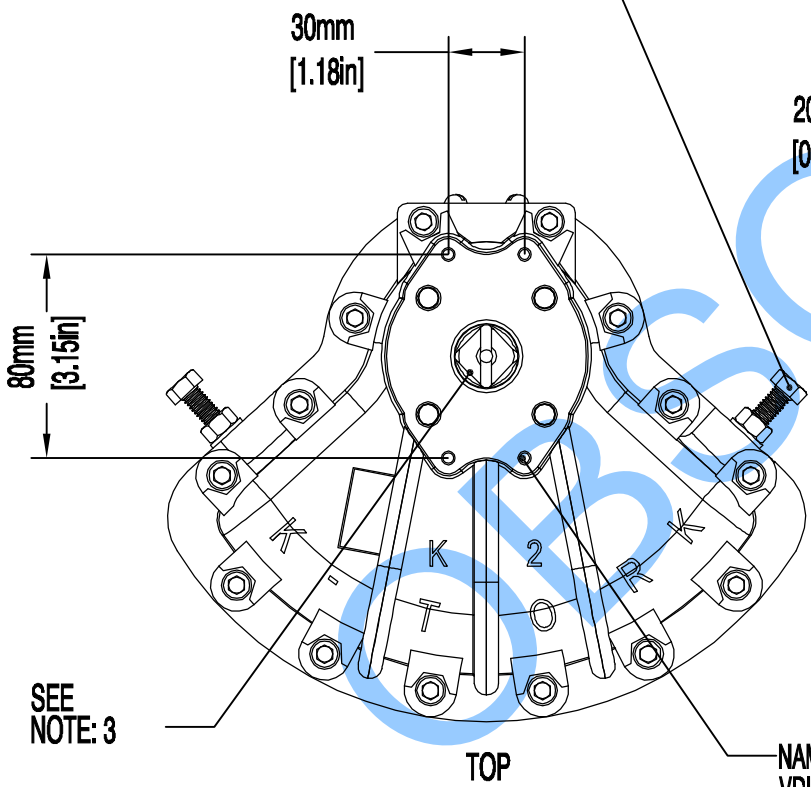
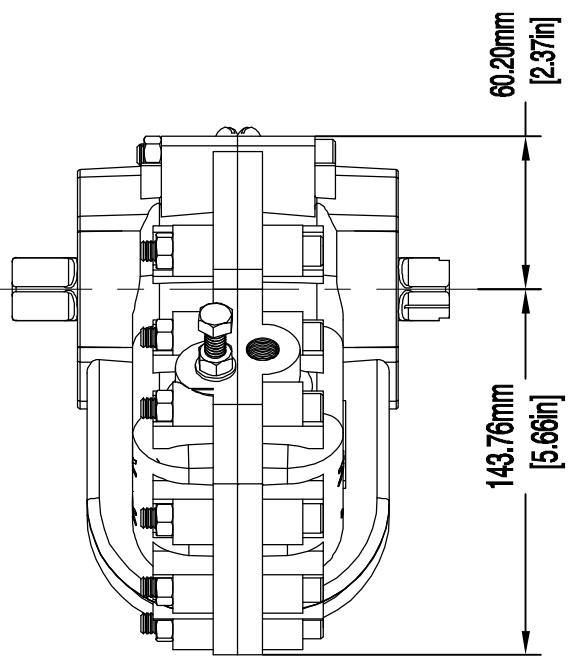
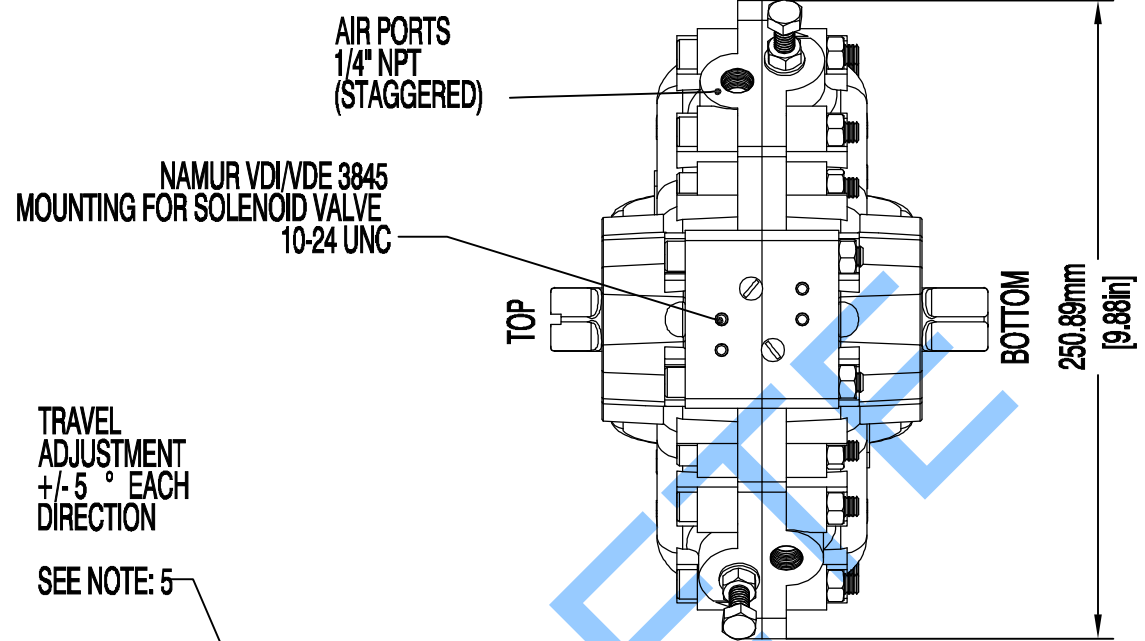
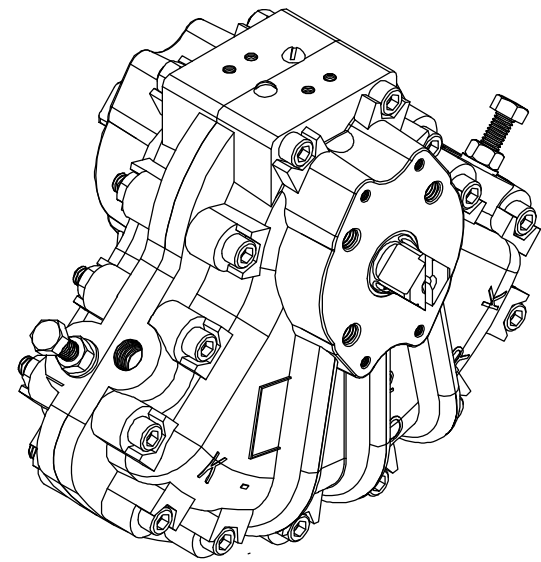

This drawing is confidential and is the property of Rotork Dallas Inc. and must not be reproduced either wholly or partly. All rights in respect of patents, designs and copyrights are reserved. © 2015

Document type	DETAIL DRAWING		Title	
	Dimensions in mm		K-2 DOUBLE-ACTING MODEL	
	Scale 1:1		IMPERIAL AIR PORTS & MOUNTING HOLES	
Created	S.DINESH	30-JAN-2015	Drawing Number	Rev
Checked	S.SUDHIR	30-JAN-2015	D000000203	0
Approved	K.PRICE	30-JAN-2015	Sheet 1 of 1	Size A3