

CONDUIT ENTRY HOLE			
Hole	Metric	NPT	PG
A	M20	3/4 - 14	PG13.5
B	M25	1 - 11.5	PG21
C	M32	1 1/4 - 11.5	PG29

- NOTE:
1. THRUST BASE. PLEASE REFER TO THE TECHNICAL DATA SECTION OF BROCHURE FOR DETAILS OF MAXIMUM AXIAL THRUST RATINGS.
 2. BASEPLATE DETAILS: F10/FA10.
 3. DIMENSIONS WITH '*' INDICATE COVER REMOVAL ALLOWANCE
 4. THE INTERFACE PROVIDED FOR MOUNTING THE ACTUATOR OR SECOND STAGE GEARBOX ONTO THE VALVE SHOULD CONFORM TO GOOD ENGINEERING PRACTICES, ENSURING ADEQUATELY TOLERANCED LIMITS FOR PARALLELISM, PERPENDICULARITY AND CONCENTRICITY.
 5. ROTORK CANNOT BE HELD LIABLE FOR DAMAGE TO OUR EQUIPMENT CAUSED BY EXCESSIVE LOADING FROM COVER TUBES, HANDWHEEL AND HAND LEVER.

PARAMETER	VALUE	DESCRIPTION
DRAWING TYPE	A	INSTALLATION DRAWING
ACTUATOR	8	CK(R)A120
GEARBOX1	00	NO G.B.1.
GEARBOX2	N0	NO G.B.2
TERMINAL COVER	C	4 COND
MECHANISM / MOTOR	A	AID/LARGE MOT.
HANDWHEEL / REAR / FRONT	0	STD.H.W./STD.REAR./STD.FRNT.
ORIENTATION	0	STD. ORIENT.

	Drawn	AASHAY	17-07-19	Title DIMENSIONAL DRAWING, CKA120 & CKRA120, 4 CONDUIT ENTRIES, AID/LARGE MOTOR, STANDARD ORIENTATION	A4 Doc Number A800N0CA00X	Ver No 1	Scale NTS	Sheet No 1 of 2
	Checked	TAMIL	17-07-19					
Approved	JOSE	17-07-19	<small>This drawing and the information it contains are property of Rotork Controls Limited, and they will not be reproduced or disclosed, in whole or in part, without the prior written consent of Rotork.</small>					

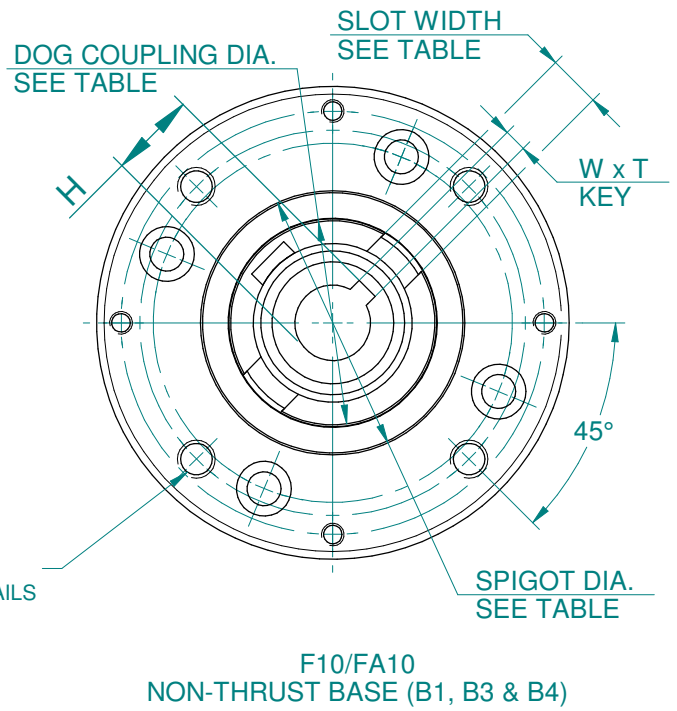
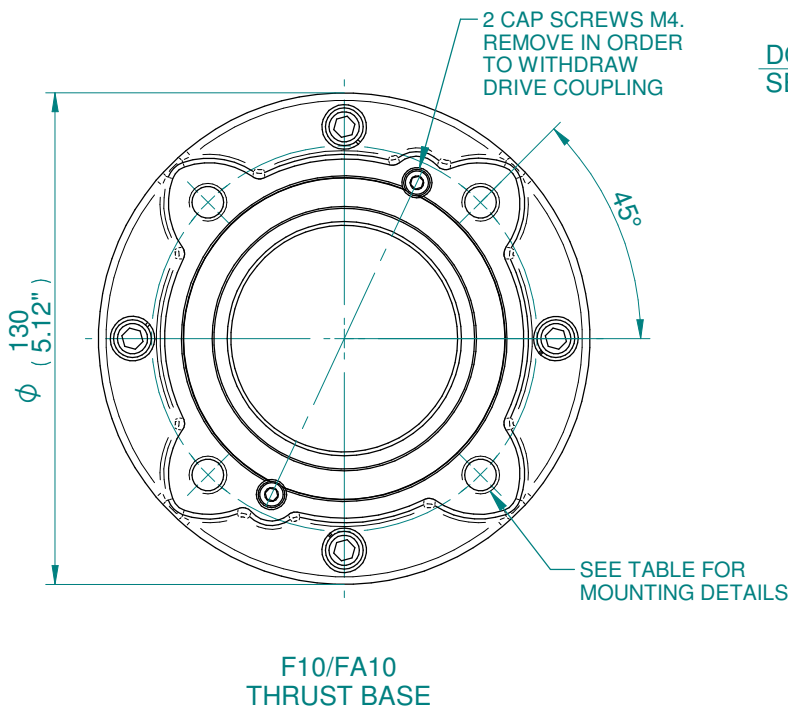
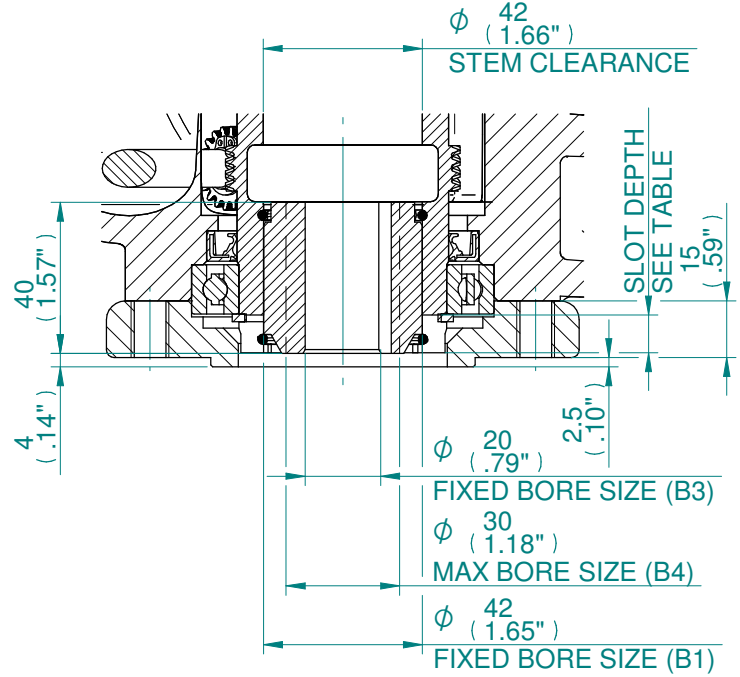
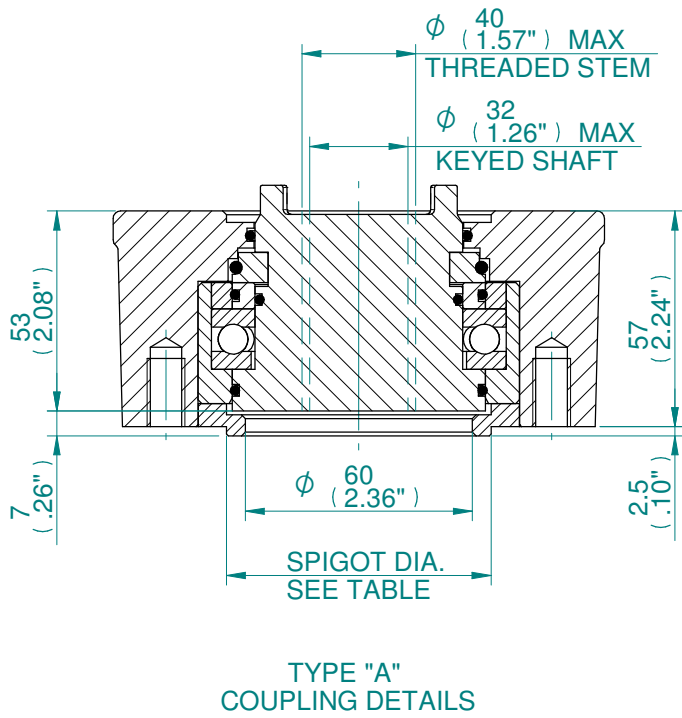

B1, B3 & B4 KEY DETAILS	
DESCRIPTION	F10/FA10
KEY (B1) WxT	12x8
KEY (B3) WxT	6x6
MAX. KEY (B4) WxT	8x7
H (B1)	45.3
H (B3)	22.8
H (B4) MAX	33.3

BASEPLATE MOUNTING DETAILS			
TYPE	BASEPLATE	SPIGOT DIA.	HOLE DETAILS (45° OFF CENTRES)
ISO F10	STANDARD	ϕ 69.970/69.924	4 HOLES M10x15 (0.59") DEEP ON ϕ 102.0 (ϕ 4.02") P.C.
		ϕ 2.310/2.305"	4 HOLES 3/8"UNCx15 (0.59") DEEP ON ϕ 101.6 (ϕ 4.00") P.C.
FA10			

DOG COUPLING DETAILS	
SLOT WIDTH	14
SLOT DEPTH	10
DOG COUPLING DIA.	ϕ 54

CK range	Drawn	AASHAY	17-07-19
	Checked	TAMIL	17-07-19
	Approved	JOSE	17-07-19

Title	DIMENSIONAL DRAWING, CKA120 & CKRA120, 4 CONDUIT ENTRIES, AID/LARGE MOTOR, STANDARD ORIENTATION
--------------	---

A4	Doc Number	Ver No	Scale	Sheet No
	A800N0CA00X	1	NTS	2 of 2