

NOTE:

- APPROXIMATE WEIGHT :140 Kg (308 lbs).
- GEARBOX RATIOS: 3, 4 & 6:1.
- GEARBOX BASEPLATE: F25/FA25 & F30/FA30.
- DIMENSIONS WITH "*" INDICATE COVER REMOVAL ALLOWANCE
- THE INTERFACE PROVIDED FOR MOUNTING THE ACTUATOR OR SECOND STAGE GEARBOX ONTO THE VALVE SHOULD CONFORM TO GOOD ENGINEERING PRACTICES, ENSURING ADEQUATELY TOLERANCED LIMITS FOR PARALLELISM, PERPENDICULARITY AND CONCENTRICITY.
- ROTORK CANNOT BE HELD LIABLE FOR DAMAGE TO OUR EQUIPMENT CAUSED BY EXCESSIVE LOADING FROM COVER TUBES, HANDWHEEL AND HAND LEVER.

| PARAMETER | VALUE | DESCRIPTION |
|--------------------------|-------|-----------------------------|
| DRAWING TYPE | A | INSTALLATION DRAWING |
| ACTUATOR | 6 | CK(R)C250/500 |
| GEARBOX1 | B9 | IB9 |
| GEARBOX2 | N0 | No G.B.2 |
| CENTRONIK / TERMINAL | B | 3 COND |
| MECHANISM / MOTOR | A | AID/LARGE MOT. |
| HANDWHEEL / REAR / FRONT | 0 | STD.H.W./STD.REAR/STD.FRNT. |
| ORIENTATION | 0 | STANDARD ORIENTATION |

LEZO - ES
www.rotork.com

© 2024 Rotork Group of Companies. All rights reserved. This document and its contents may not be reproduced, distributed, transmitted, displayed, published, or broadcast, in whole, or in part, without the prior, express written permission of Rotork Group of Companies.

Title: **DD,CK(R)C250/500,IB9,3 ENTR,AID/LRG MTR,STD ORT.**

| | | | | |
|----------|------------|------------|--------------------------------------|-------------------|
| Created | A.Aashay | 2024-03-18 | Drawing Number A6B9N0BA00X | Rev 1-0 |
| Checked | A.Aashay | 2024-03-20 | | |
| Approved | N.Campbell | 2024-04-09 | | |

Size: A3 Sheet 1 of 2

Template Issue : 2021-02-19 (RCL-PE)

| Rev | ECN | Revised | Rev. Approved | Date | Change Description |
|-----|-----|----------|---------------|------------|--------------------|
| 1-0 | - | A.Aashay | N.Campbell | 2024-04-09 | First issue |

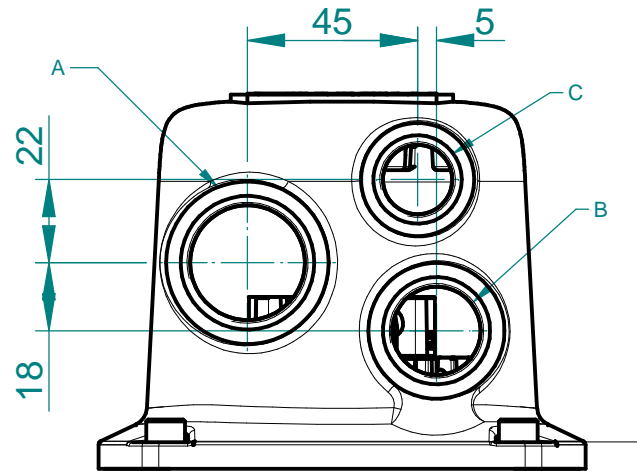

| CONDUIT ENTRY HOLE | | |
|--------------------|--------|------|
| Hole | Metric | NPT |
| A | M32 | 1 ¼" |
| B | M25 | ¾" |
| C | M20 | ¾" |

CONDUIT ENTRIES

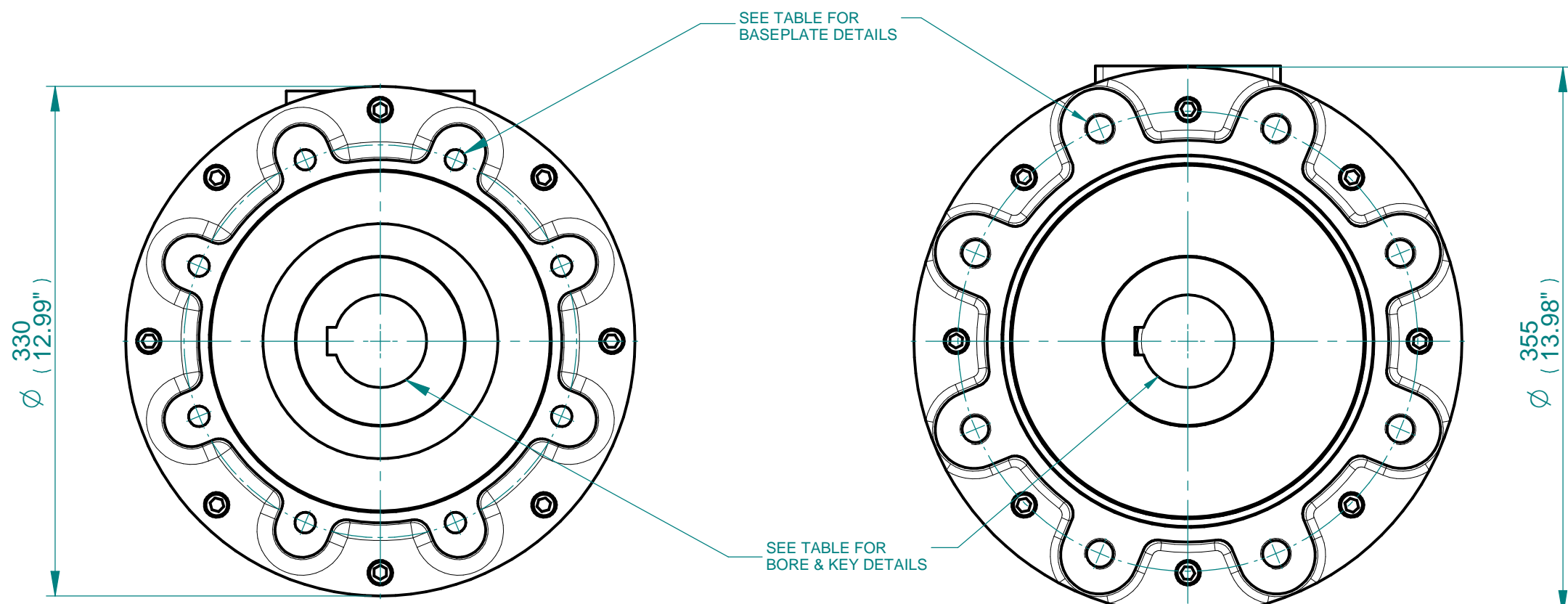

IB9-F25/FA25 GEARBOX MOUNTING DETAILS

IB9-F30/FA30 GEARBOX MOUNTING DETAILS

| |
|---------------------------------------|
| MAX. STEM SCREW ACCEPTANCE DIA |
| 86(3.375") |

| STD | MAX BORE SQ KEY | | MAX BORE RECTANGULAR KEY | |
|------------|-----------------|---------|--------------------------|-----------|
| | BORE | KEY | BORE | KEY |
| BS4235 | - | - | 76.0 | 22X14 |
| BS46 | 2.750" | 3/4" SQ | 3.000" | 3/4"X1/2" |
| ANSI B17.1 | 2.750" | 5/8" SQ | 3.000" | 3/4"X1/2" |

| BASEPLATE DETAILS | | | |
|-------------------|-----------|------------------|----------------------------------|
| TYPE | BASEPLATE | SPIGOT DIA. | HOLE DETAILS (22.5° OFF CENTRES) |
| ISO F25 | STANDARD | Ø199.95-0.05 | 8 HOLES M16X20 (0.79") DEEP |
| | | (Ø7.872"-0.002") | ON Ø254.0 (Ø10.00") P.C. |
| FA25 | | Ø152.25-0.05 | 8 HOLES 5/8"UNCX20 (0.79") DEEP |
| | | (Ø5.994"-0.002") | ON Ø254.4 (Ø10.00") P.C. |
| ISO F30 | STANDARD | Ø229.95-0.05 | 8 HOLES M20x25 (0.98") DEEP |
| | | (Ø9.053"-0.002") | ON Ø298.0 (Ø11.73") P.C. |
| FA30 | | Ø177.70-0.05 | 8 HOLES 3/4"UNCx25 (0.98") DEEP |
| | | (Ø6.996"-0.002") | ON Ø298.5 (Ø11.75") P.C. |

LEZO - ES
www.rotork.com

© 2024 Rotork Group of Companies. All rights reserved. This document and its contents may not be reproduced, distributed, transmitted, displayed, published, or broadcast, in whole, or in part, without the prior, express written permission of Rotork Group of Companies.

Title: **DD,CK(R)C250/500,IB9,3 ENTR,AID/LRG MTR,STD ORT.**

Created: A.Aashay, 2024-03-18

Checked: []

Approved: []

Drawing Number: **A6B9N0BA00X**

Rev: 1-0

Size: A3 Sheet 2 of 2

Template Issue - 2021-02-19 (RCL-PE)

| Rev | ECN | Revised | Rev. Approved | Date | Change Description |
|-----|-----|---------|---------------|------|--------------------|
| 1 | | | | | |
| 2 | | | | | |
| 3 | | | | | |
| 4 | | | | | |