

- NOTE:
1. GEARBOX RATIOS : 480, 540, 720:1
 2. GEARBOX BASEPLATE: F25/FA25, F30/FA30 & F35/FA35
 3. DIMENSIONS WITH "*" INDICATE COVER REMOVAL ALLOWANCE
 4. THE INTERFACE PROVIDED FOR MOUNTING THE ACTUATOR OR SECOND STAGE GEARBOX ONTO THE VALVE SHOULD CONFORM TO GOOD ENGINEERING PRACTICES, ENSURING ADEQUATELY TOLERANCED LIMITS FOR PARALLELISM, PERPENDICULARITY AND CONCENTRICITY.
 5. ROTORK CANNOT BE HELD LIABLE FOR DAMAGE TO OUR EQUIPMENT CAUSED BY EXCESSIVE LOADING FROM COVER TUBES, HANDWHEEL AND HAND LEVER.

| PARAMETER | VALUE | DESCRIPTION |
|--------------------------|-------|-----------------------------|
| DRAWING TYPE | A | INSTALLATION DRAWING |
| ACTUATOR | 4 | CK(R)C30/60 |
| GEARBOX1 | W7 | IW7 |
| GEARBOX2 | RH | HIGH RATIO |
| CENTRONIK / TERMINAL | B | CTK/3 COND |
| MECHANISM / MOTOR | 0 | STD.MECH./LARGE MOT. |
| HANDWHEEL / REAR / FRONT | 0 | STD.H.W./STD.REAR/STD.FRNT. |
| ORIENTATION | 0 | STD.ORIENT. |

CK range Drawn: TAMIL 17-05-17
 Checked: BHARAT 17-05-17
 Approved: JOSE 17-05-17

Title DIMENSIONAL DRAWING, CKC30/60 & CKRC30/60, IW7, HIGH RATIO, CENTRONIK / 3 CONDUIT ENTRIES, LARGE MOTOR, STANDARD ORIENTATION.

This drawing and the information it contains are property of Rotork Controls Limited, and they will not be reproduced or disclosed, in whole or in part, without the prior written consent of Rotork.

A4 Doc Number Ver No Scale Sheet No
A4W7RHB000X 1 NTS 1 of 2

| CONDUIT ENTRY HOLE | | |
|--------------------|--------|--------|
| Hole | Metric | NPT |
| A | M32 | 1 1/2" |
| B | M25 | 3/4" |
| C | M20 | 3/4" |

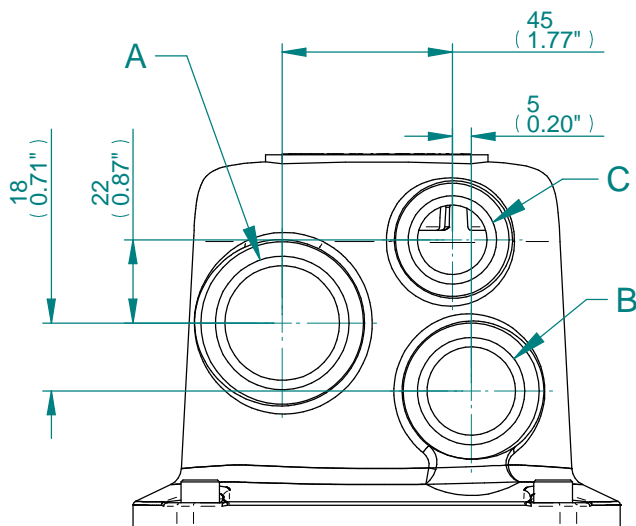

CONDUIT ENTRIES

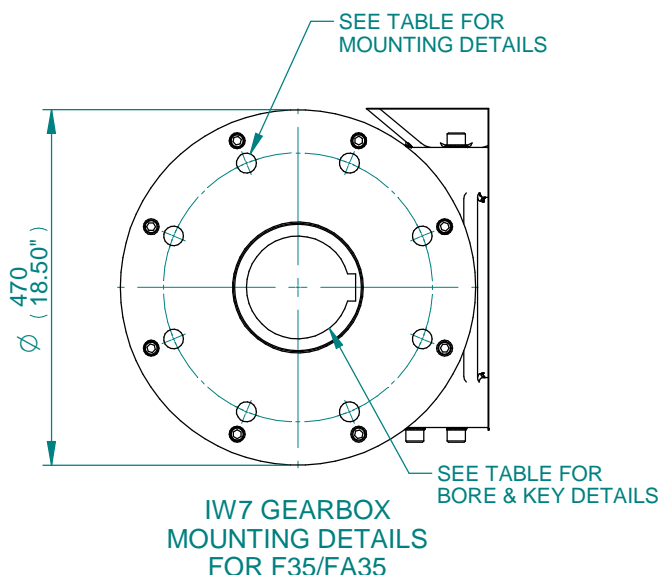
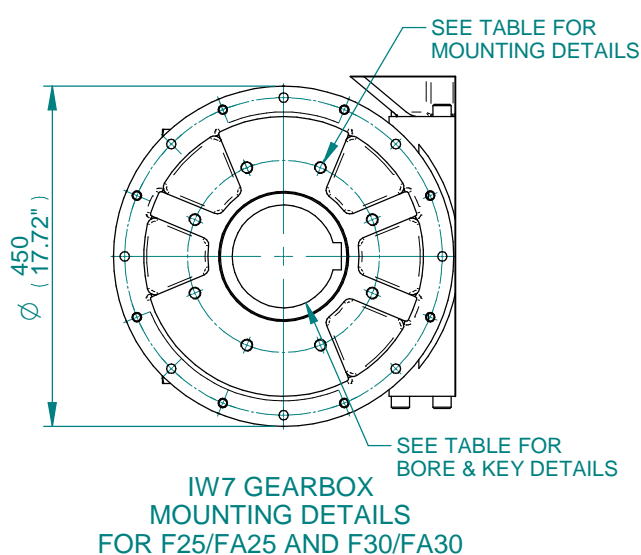

| BASEPLATE | X | Y | Z |
|--------------------|-----|-----|-----|
| STANDARD THICKNESS | 87 | 140 | 172 |
| FILLED THICKNESS | 97 | 150 | 182 |
| WAFER THICKNESS | 118 | 171 | 203 |

| STD | MAX BORE SQ KEY | | MAX BORE RECTANGULAR KEY | |
|------------|-----------------|----------|--------------------------|-------------|
| | BORE | KEY | BORE | KEY |
| BS4235 | - | - | 136.0 | 36X20 |
| BS46 | 4.875" | 1.1/4"SQ | 5.125" | 1.1/2"X1" |
| ANSI B17.1 | 4.875" | 1.1/4"SQ | 5.25" | 1.1/4"X7/8" |

| BASEPLATE DETAILS | | |
|-------------------|---------------------|--|
| TYPE | BASEPLATE | HOLE DETAILS (22.5° OFF CENTRES) |
| ISO F25 | STANDARD AND FILLED | 8 HOLES M16X24 (0.94") DEEP ON Ø254.00 (Ø10.00") P.C. |
| FA25 | | 8 HOLES 5/8"UNCX24 (0.94") DEEP ON Ø254.00 (Ø10.00") P.C. |
| ISO F30 | | 8 HOLES M20X24 (0.94") DEEP ON Ø298.00 (Ø11.73") P.C. |
| FA30 | | 8 HOLES 3/4"UNCX24 (0.94") DEEP ON Ø298.45 (Ø11.75") P.C. |
| ISO F35 | WAFER | 8 HOLES M30X36 (1.42") DEEP ON Ø356.00 (Ø14.02") P.C. |
| FA35 | | 8 HOLES 1"UNCX36 (1.42") DEEP ON Ø356.60 (Ø14.00") P.C. |

CK range

| | | |
|----------|--------|----------|
| Drawn | TAMIL | 17-05-17 |
| Checked | BHARAT | 17-05-17 |
| Approved | JOSE | 17-05-17 |

Title DIMENSIONAL DRAWING, CKC30/60 & CKRC30/60, IW7, HIGH RATIO, CENTRONIK / 3 CONDUIT ENTRIES, LARGE MOTOR, STANDARD ORIENTATION.

This drawing and the information it contains are property of Rotork Controls Limited, and they will not be reproduced or disclosed, in whole or in part, without the prior written consent of Rotork.

| | | | | |
|-----------|--------------------|----------|------------|---------------|
| A4 | Doc Number | Ver No | Scale | Sheet No |
| | A4W7RHB000X | 1 | NTS | 2 of 2 |