

"X" REFER SHEET 2
 "Y" MAX. STEM ENTRY REFER SHEET 2
 "Z" REFER SHEET 2

- NOTE:
1. GEARBOX RATIOS : 200, 240, 350 & 420:1
 2. GEARBOX BASEPLATE: F14/FA14, F16/FA16 & F25/FA25
 3. DIMENSIONS WITH "*" INDICATE COVER REMOVAL ALLOWANCE
 4. THE INTERFACE PROVIDED FOR MOUNTING THE ACTUATOR OR SECOND STAGE GEARBOX ONTO THE VALVE SHOULD CONFORM TO GOOD ENGINEERING PRACTICES, ENSURING ADEQUATELY TOLERANCED LIMITS FOR PARALLELISM, PERPENDICULARITY AND CONCENTRICITY.
 5. ROTORK CANNOT BE HELD LIABLE FOR DAMAGE TO OUR EQUIPMENT CAUSED BY EXCESSIVE LOADING FROM COVER TUBES, HANDWHEEL AND HAND LEVER.

PARAMETER	VALUE	DESCRIPTION
DRAWING TYPE	A	INSTALLATION DRAWING
ACTUATOR	4	CK(R)/C30/CK60
GEARBOX1	W5	IW5
GEARBOX2	RH	HIGH RATIO
CENTRONIK / TERMINAL	P	S1ph/3 COND
MECHANISM / MOTOR	S	STD. MECH/SMALL MOT.
HANDWHEEL / REAR / FRONT	L	STD.H.W./LRGE.REAR/STD.FRNT.
ORIENTATION	0	STD.ORIENT.

	Drawn	TAMIL	14-11-17	Title DIMENSIONAL DRAWING, CKC30/60 & CKRC30/60, IW5, HIGH RATIO, 1ph/3 CONDUIT ENTRIES, SMALL MOTOR, EXTENDED CENTRONIK, STANDARD ORIENTATION	A4	Doc Number	A4W5RHPSL0X	Ver No	1	Scale	NTS	Sheet No	1 of 2
	Checked	BHARAT	14-11-17			Approved		JOSE		14-11-17			

This drawing and the information it contains are property of Rotork Controls Limited, and they will not be reproduced or disclosed, in whole or in part, without the prior written consent of Rotork.

CONDUIT ENTRY HOLE		
Hole	Metric	NPT
A	M32	1 1/4"
B	M25	3/4"
C	M20	3/4"

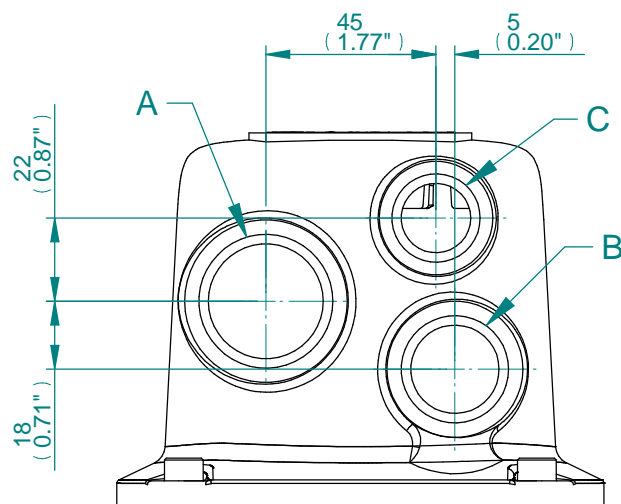

CONDUIT ENTRIES

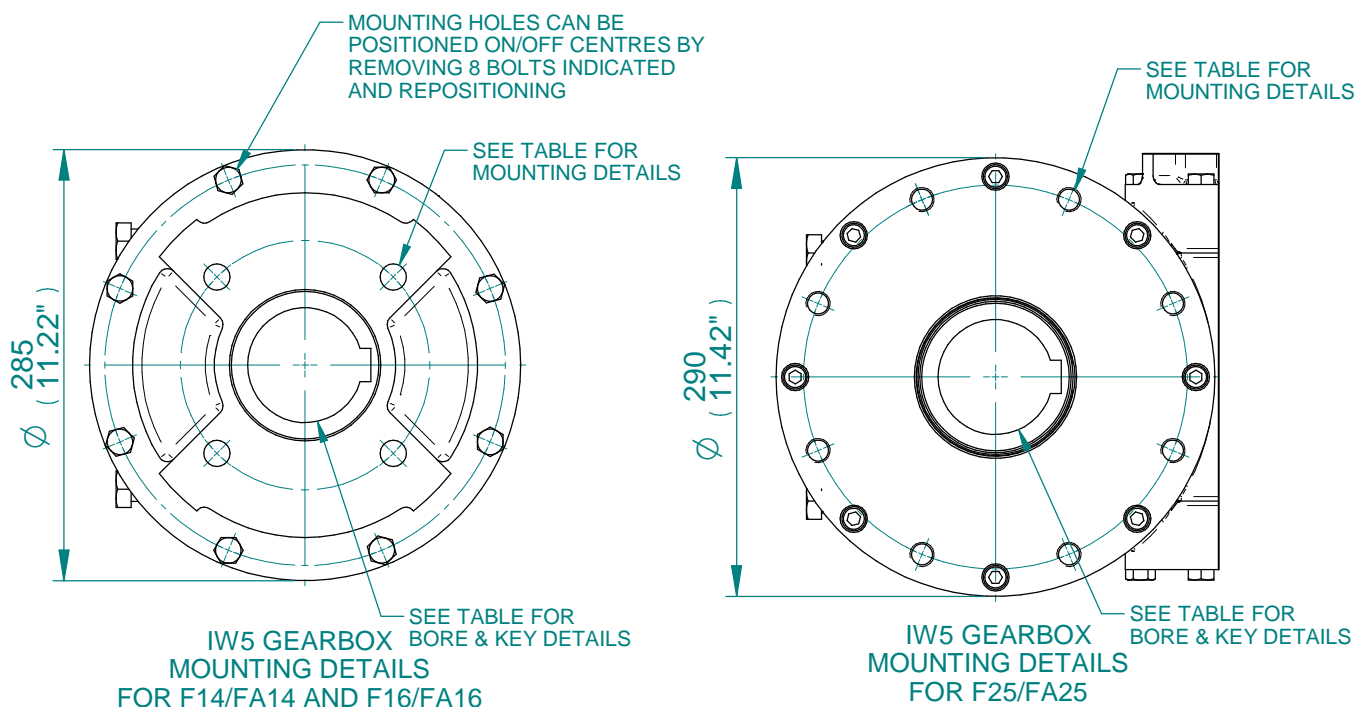

IW5 GEARBOX MOUNTING DETAILS FOR F14/FA14 AND F16/FA16

IW5 GEARBOX MOUNTING DETAILS FOR F25/FA25

BASEPLATE	X	Y	Z
STANDARD THICKNESS	65	110	128
FILLED THICKNESS	75	120	138
WAFER THICKNESS	101	146	164

STD	MAX BORE SQ KEY		MAX BORE RECTANGULAR KEY	
	BORE	KEY	BORE	KEY
BS4235	-	-	76.0	22X14
BS46	2.75"	3/4" SQ	3.00"	3/4"X1/2"
ANSI B17.1	2.75"	5/8" SQ	3.00"	3/4"X1/2"

BASEPLATE DETAILS		
TYPE	BASEPLATE	HOLE DETAILS (45° OFF CENTRES)
ISO F14	STANDARD	4 HOLES M16X16 (0.63") DEEP ON Ø140.0 (Ø5.51") P.C.
FA14		4 HOLES 5/8"UNCx16 (0.63") DEEP ON Ø139.7 (Ø5.50") P.C.
ISO F16		4 HOLES M20X16 (0.63") DEEP ON Ø165.0 (Ø6.50") P.C.
FA16		4 HOLES 3/4"UNCx16 (0.63") DEEP ON Ø165.0 (Ø6.50") P.C.
TYPE	BASEPLATE	HOLE DETAILS (22.5° OFF CENTRES)
ISO F25	FILLED AND WAFER	8 HOLES M16X16 (0.63") DEEP ON Ø254.0 (Ø10.00") P.C.
FA25		8 HOLES 5/8"UNCx16 (0.63") DEEP ON Ø254.0 (Ø10.00") P.C.

CK range
 Drawn: TAMIL 14-11-17
 Checked: BHARAT 14-11-17
 Approved: JOSE 14-11-17

Title DIMENSIONAL DRAWING, CKC30/60 & CKRC30/60, IW5, HIGH RATIO, 1ph/3 CONDUIT ENTRIES, SMALL MOTOR, EXTENDED CENTRONIK, STANDARD ORIENTATION

A4 Doc Number Ver No Scale Sheet No
A4W5RHPSL0X 1 NTS 2 of 2