

"X" REFER SHEET 2
 "Y" MAX. STEM ENTRY REFER SHEET 2
 "Z" REFER SHEET 2

- NOTE:
1. GEARBOX RATIOS : 200, 240, 350 & 420:1
 2. GEARBOX BASEPLATE: F14/FA14, F16/FA16 & F25/FA25
 3. DIMENSIONS WITH "*" INDICATE COVER REMOVAL ALLOWANCE
 4. THE INTERFACE PROVIDED FOR MOUNTING THE ACTUATOR OR SECOND STAGE GEARBOX ONTO THE VALVE SHOULD CONFORM TO GOOD ENGINEERING PRACTICES, ENSURING ADEQUATELY TOLERANCED LIMITS FOR PARALLELISM, PERPENDICULARITY AND CONCENTRICITY.
 5. ROTORK CANNOT BE HELD LIABLE FOR DAMAGE TO OUR EQUIPMENT CAUSED BY EXCESSIVE LOADING FROM COVER TUBES, HANDWHEEL AND HAND LEVER.

| PARAMETER | VALUE | DESCRIPTION |
|--------------------------------------|-------|------------------------------|
| DRAWING TYPE | A | INSTALLATION DRAWING |
| ACTUATOR | 4 | CK(R)/C30/CK60 |
| GEARBOX1 | W5 | IW5 |
| GEARBOX2 | RH | HIGH RATIO |
| CENTRONIK / TERMINAL | B | CTK/3 COND |
| MECHANISM / MOTOR | S | STD. MECH/SMALL MOT. |
| HANDWHEEL / REAR / FRONT ORIENTATION | L | STD.H.W./LRGE.REAR/STD.FRNT. |
| | 0 | STD.ORIENT. |

| | | | | | | | | | | |
|-----------------|----------|--------|----------|--------------|--|-----------|--------------------|--------|-------|----------|
| CK range | Drawn | TAMIL | 14-08-17 | Title | DIMENSIONAL DRAWING, CKC30/60 & CKRC30/60, IW5, HIGH RATIO, CENTRONIK/3 CONDUIT ENTRIES, SMALL MOTOR, EXTENDED CENTRONIK, STANDARD ORIENTATION | A4 | Doc Number | Ver No | Scale | Sheet No |
| | Checked | BHARAT | 14-08-17 | | | | A4W5RHBSL0X | | | |
| | Approved | JOSE | 14-08-17 | | | | 1 | | | |

| CONDUIT ENTRY HOLE | | |
|--------------------|--------|--------|
| Hole | Metric | NPT |
| A | M32 | 1 1/4" |
| B | M25 | 3/4" |
| C | M20 | 3/4" |

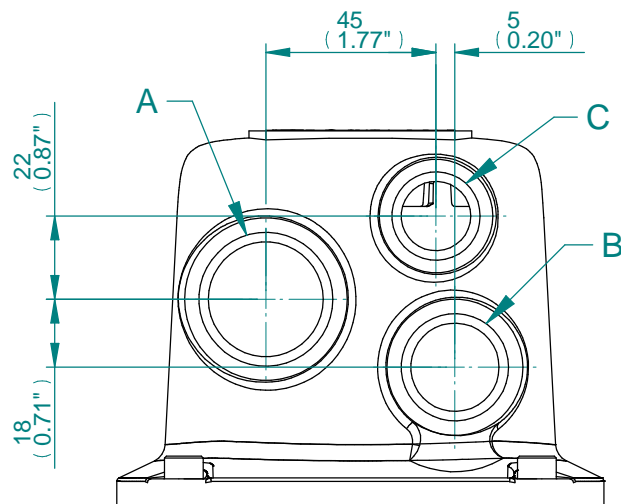

CONDUIT ENTRIES

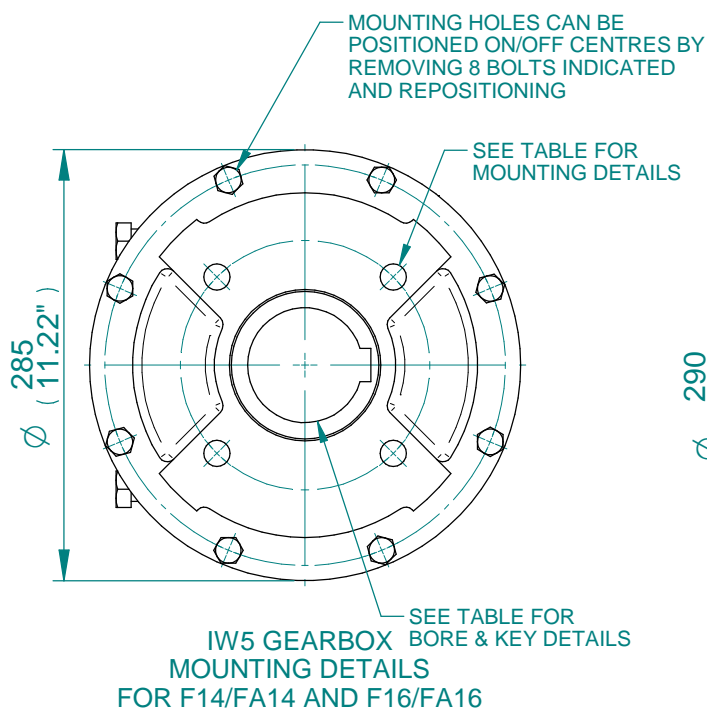

IW5 GEARBOX MOUNTING DETAILS FOR F14/FA14 AND F16/FA16

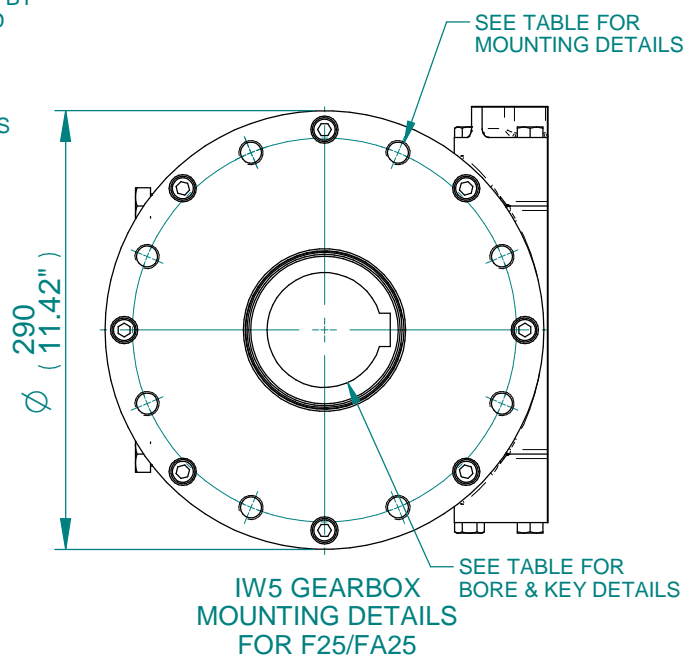

IW5 GEARBOX MOUNTING DETAILS FOR F25/FA25

| BASEPLATE | X | Y | Z |
|--------------------|-----|-----|-----|
| STANDARD THICKNESS | 65 | 110 | 128 |
| FILLED THICKNESS | 75 | 120 | 138 |
| WAFER THICKNESS | 101 | 146 | 164 |

| STD | MAX BORE SQ KEY | | MAX BORE RECTANGULAR KEY | |
|------------|-----------------|---------|--------------------------|-----------|
| | BORE | KEY | BORE | KEY |
| BS4235 | - | - | 76.0 | 22X14 |
| BS46 | 2.75" | 3/4" SQ | 3.00" | 3/4"X1/2" |
| ANSI B17.1 | 2.75" | 5/8" SQ | 3.00" | 3/4"X1/2" |

| BASEPLATE DETAILS | | |
|-------------------|------------------|---|
| TYPE | BASEPLATE | HOLE DETAILS (45° OFF CENTRES) |
| ISO F14 | STANDARD | 4 HOLES M16X16 (0.63") DEEP ON Ø140.0 (Ø5.51") P.C. |
| FA14 | | 4 HOLES 5/8"UNCx16 (0.63") DEEP ON Ø139.7 (Ø5.50") P.C. |
| ISO F16 | | 4 HOLES M20X16 (0.63") DEEP ON Ø165.0 (Ø6.50") P.C. |
| FA16 | | 4 HOLES 3/4"UNCx16 (0.63") DEEP ON Ø165.0 (Ø6.50") P.C. |
| TYPE | BASEPLATE | HOLE DETAILS (22.5° OFF CENTRES) |
| ISO F25 | FILLED AND WAFER | 8 HOLES M16X16 (0.63") DEEP ON Ø254.0 (Ø10.00") P.C. |
| FA25 | | 8 HOLES 5/8"UNCx16 (0.63") DEEP ON Ø254.0 (Ø10.00") P.C. |



| | | |
|----------|--------|----------|
| Drawn | TAMIL | 14-08-17 |
| Checked | BHARAT | 14-08-17 |
| Approved | JOSE | 14-08-17 |

Title DIMENSIONAL DRAWING, CKC30/60 & CKRC30/60, IW5, HIGH RATIO, CENTRONIK/3 CONDUIT ENTRIES, SMALL MOTOR, EXTENDED CENTRONIK, STANDARD ORIENTATION

This drawing and the information it contains are property of Rotork Controls Limited, and they will not be reproduced or disclosed, in whole or in part, without the prior written consent of Rotork.

| | | | | |
|-----------|--------------------|---------------|--------------|-----------------|
| A4 | Doc Number | Ver No | Scale | Sheet No |
| | A4W5RHBSL0X | 1 | NTS | 2 of 2 |