

POSICIÓN DE ACOPLAMIENTO PARA BASE SIN EMPUJE (B1, B3 y B4) (F07 / FA07 y F10 / FA10)

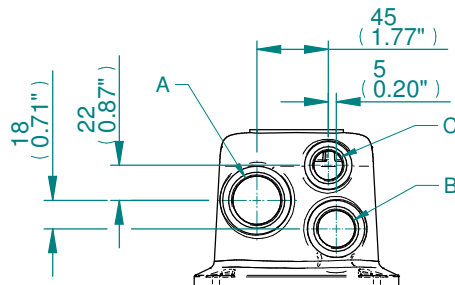

ENTRADAS DE CABLE

- NOTE:
- THRUST BASE. PLEASE REFER TO THE TECHNICAL DATA SECTION OF BROCHURE FOR DETAILS OF MAXIMUM AXIAL THRUST RATINGS.
  - BASEPLATE DETAILS: F07/FA07 AND F10/FA10.
  - DIMENSIONS WITH "\*" INDICATE COVER REMOVAL ALLOWANCE
  - THE INTERFACE PROVIDED FOR MOUNTING THE ACTUATOR OR SECOND STAGE GEARBOX ONTO THE VALVE SHOULD CONFORM TO GOOD ENGINEERING PRACTICES, ENSURING ADEQUATELY TOLERANCED LIMITS FOR PARALLELISM, PERPENDICULARITY AND CONCENTRICITY.
  - ROTORC CANNOT BE HELD LIABLE FOR DAMAGE TO OUR EQUIPMENT CAUSED BY EXCESSIVE LOADING FROM COVER TUBES, HANDWHEEL AND HAND LEVER.
- NOTA:
- BASE DE EMPUJE. CONSULTE LA SECCIÓN DE DATOS TÉCNICOS DEL FOLLETO PARA DETALLES DE CLASIFICACIONES MÁXIMAS DE EMPUJE
  - DETALLES DE LA PLACA BASE F07 / FA07 y F10 / FA10.
  - COTAS CON "\*" INDICAN LA DISTANCIA PARA DESMONTAR LAS TAPAS
  - LA INTERFAZ PROPORCIONADA PARA MONTAR EL ACTUADOR O LA CAJA DE ENGRANAJES DE SEGUNDA ETAPA EN LA VÁLVULA DEBERÍA HACERSE CON BUENAS PRÁCTICAS DE INGENIERÍA, ASEGURANDO LOS LÍMITES TOLERADOS ADECUADAMENTE PARA PARALELISMO, PERPENDICULARIDAD Y CONCENTRICIDAD.
  - ROTORC NO PUEDE SER RESPONSABLE POR DAÑOS A NUESTRO EQUIPO CAUSADOS POR CARGA EXCESIVA EN TUBOS DE PROTECCIÓN, VOLANTE Y EMBRAGUE.

CONDUIT ENTRY HOLE		
Hole	Metric	NPT
A	M32	1 1/4"
B	M25	3/4"
C	M20	3/4"

PARAMETER	VALUE	DESCRIPTION
DRAWING TYPE	A	INSTALLATION DRAWING
ACTUATOR	4	CK(R)C30/60
GEARBOX1	00	NO G.B.1.
GEARBOX2	NO	NO G.B.2.
TERMINAL COVER	B	3 COND
MECHANISM / MOTOR	S	STD MECH/SMALL MOT.
HANDWHEEL / REAR / FRONT	0	STD.H.W./LRGE.REAR./STD.FRNT.
ORIENTATION	0	STD. ORIENT.

**CK range**

Drawn	AASHAY	20-08-19
Checked	TAMIL	20-08-19
Approved	JOSE	20-08-19

**Title** DIMENSIONAL DRAWING, CKC30/60 & CKRC30/60, 3 CONDUIT ENTRIES, SMALL MOTOR, STANDARD ORIENTATION.

<b>A4</b>	<b>Doc Number</b>	<b>Ver No</b>	<b>Scale</b>	<b>Sheet No</b>
	<b>A400N0BS00S</b>	<b>1</b>	<b>NTS</b>	<b>1 of 3</b>

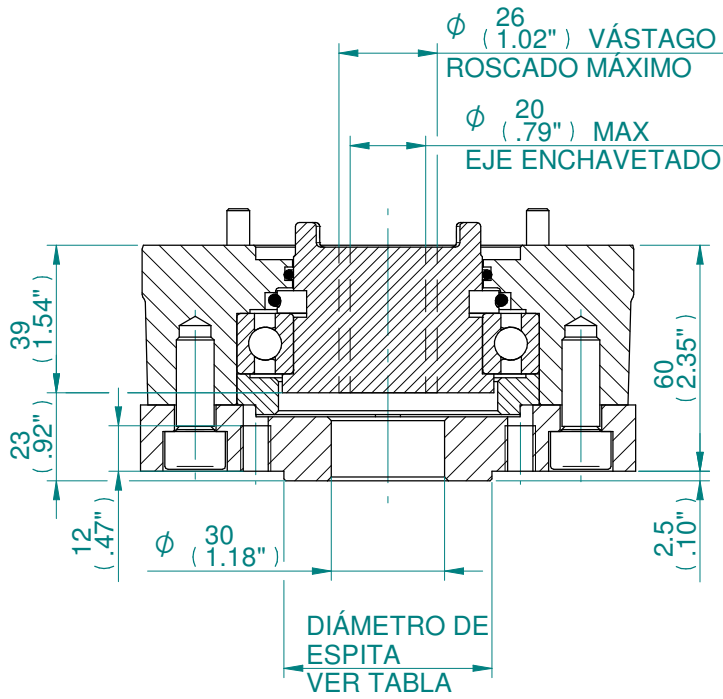

TIPO A DETALLES DE ACOPLAMIENTO PARA F07/FA07

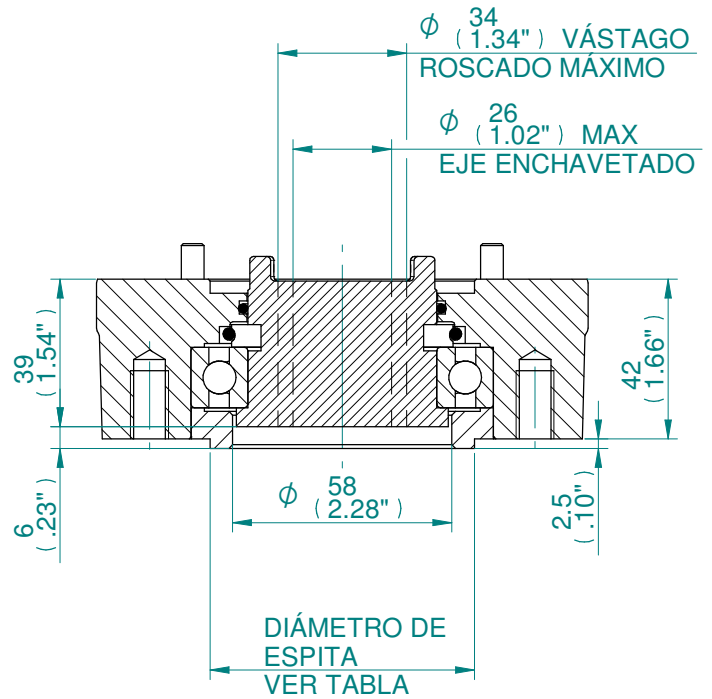

TIPO A DETALLES DE ACOPLAMIENTO PARA F10/FA10

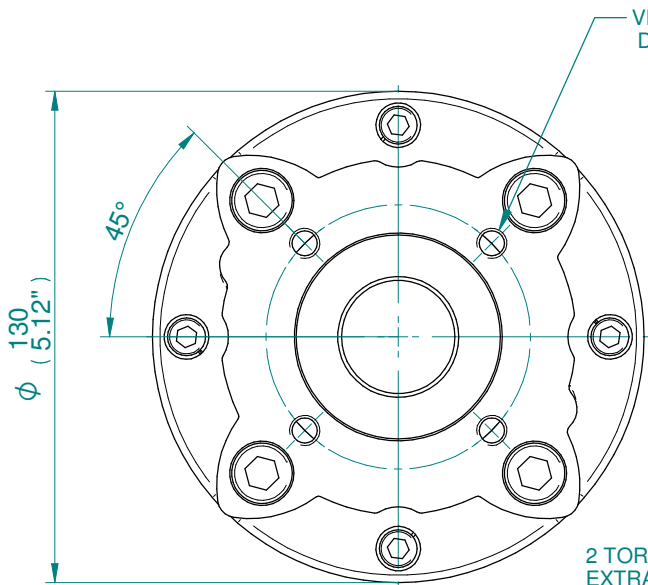

F07/FA07 BASE CON EMPUJE

2 TORNILLOS M4 EXTRAIGA PARA RETIRAR EL ACOPLAMIENTO DE LA UNIDAD

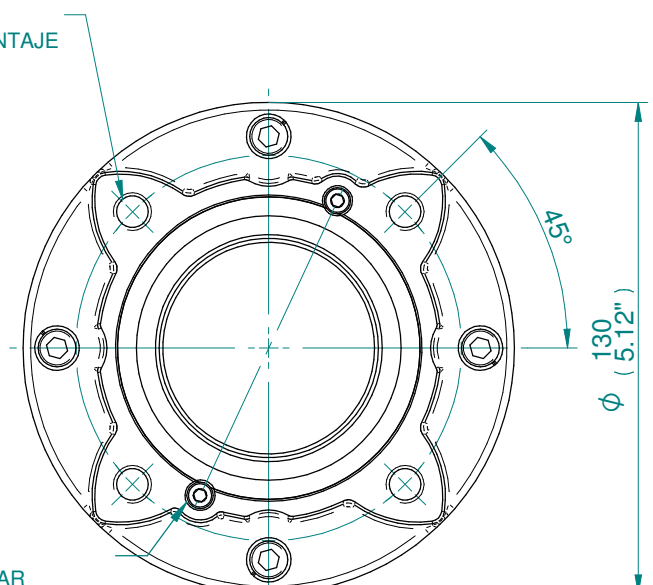

F10/FA10 BASE CON EMPUJE

BASEPLATE MOUNTING DETAILS			
TYPE	BASEPLATE	SPIGOT DIA.	HOLE DETAILS (45° OFF CENTRES)
ISO F07	STANDARD	Ø54.97/54.92	4 HOLES M8 x 15 (0.59") DEEP ON Ø70.0 (Ø2.76") P.C.
FA07		Ø2.164/2.159"	4 HOLES 5/16"UNC x 15 (0.59") DEEP ON Ø69.9 (Ø2.76") P.C.
ISO F10		Ø69.970/69.9	4 HOLES M10x15 (0.59") DEEP ON Ø102.0 (Ø4.02") P.C.
FA10		Ø2.310/2.305"	4 HOLES 3/8"UNCx15 (0.59") DEEP ON Ø101.6 (Ø4.00") P.C.

$\phi$  35  
(1.38")

AUTORIZACIÓN DEL TALLO

PROFUNDIDAD PERFECTA  
VER TABLA

$\phi$  35  
(1.38")

AUTORIZACIÓN DEL TALLO

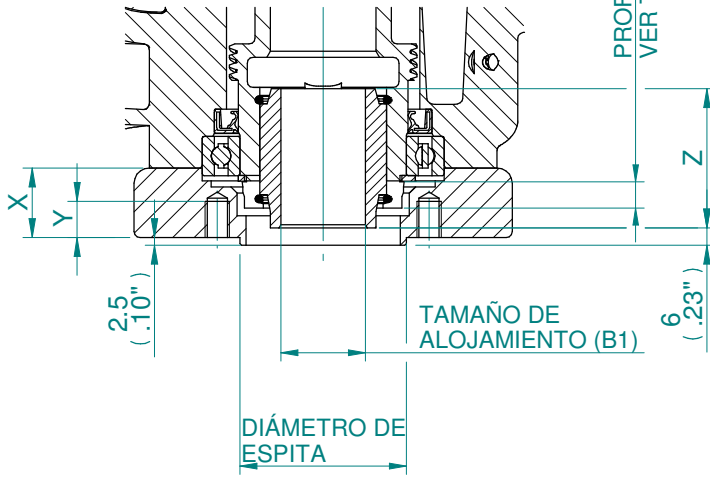

F07/FA07 & F10/FA10  
TIPO "B1" DETALLES DE ACOPLAMIENTO

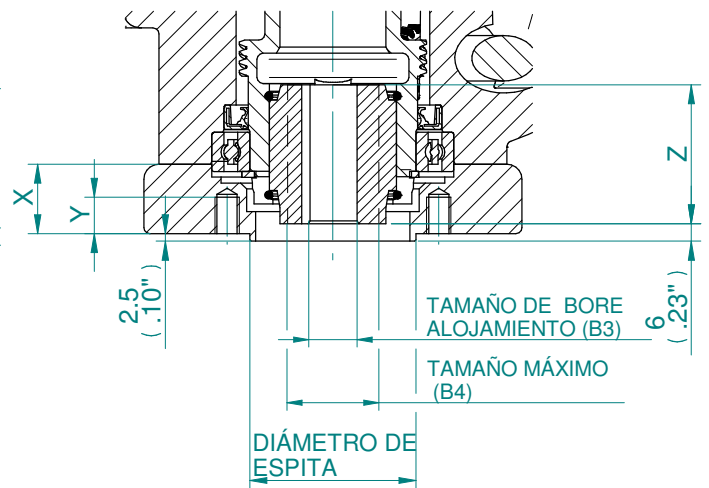

F07/FA07 & F10/FA10  
TIPO "B3 & B4" DETALLES DE ACOPLAMIENTO

DIÁMETRO DE ACOPLAMIENTO  
VER TABLA

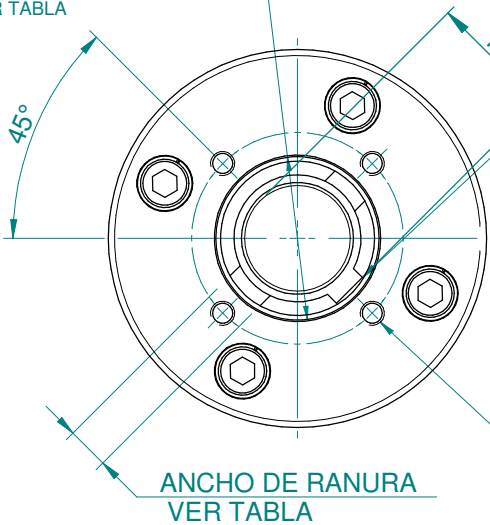

ANCHO DE RANURA  
VER TABLA

F07/FA07 & F10/FA10  
BASE SIN EMPUJE (B1)

VER TABLA PARA  
DETALLE DE ALOJAMIENTO  
Y CHAVETERO

VER TABLA PARA  
DETALLES DE MONTAJE

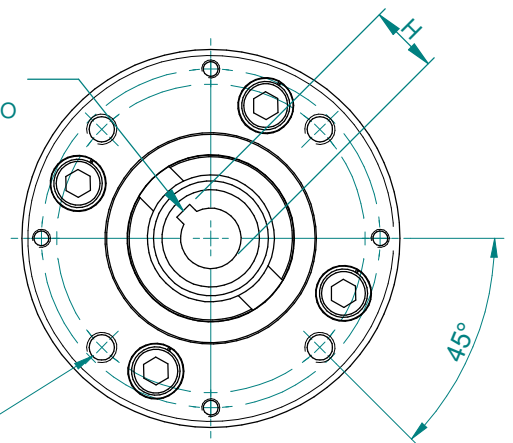

F07/FA07 & F10/FA10  
BASE SIN EMPUJE (B3 & B4)

BASEPLATE MOUNTING DETAILS

TYPE	BASEPLATE	SPIGOT DIA.	HOLE DETAILS (45° OFF CENTRES)
ISO F07	STANDARD	Ø54.97/54.92	4 HOLES M8 x 15 (0.59") DEEP ON Ø70.0 (Ø2.76") P.C.
FA07		Ø2.164/2.159"	4 HOLES 5/16"UNC x 15 (0.59") DEEP ON Ø69.9 (Ø2.76") P.C.
ISO F10		Ø69.970/69.9	4 HOLES M10x15 (0.59") DEEP ON Ø102.0 (Ø4.02") P.C.
FA10		Ø2.310/2.305"	4 HOLES 3/8"UNCx15 (0.59") DEEP ON Ø101.6 (Ø4.00") P.C.

B1, B3 & B4 BASEPLATE DETAILS

DESCRIPTION	F07/FA07	F10/FA10
X	23 (0.91")	15 (0.59")
Y	12 (0.47")	10 (0.39")
Z	46 (1.81")	40 (1.59")
FIXED BORE SIZE (B1)	Ø28 (1.10")	Ø42 (1.65")
FIXED BORE SIZE (B3)	Ø16 (0.63")	Ø20 (0.79")
MAX. BORE SIZE (B4)	Ø20 (0.79")	Ø30 (1.18")
KEY (B1) WxT	8x7	12x8
KEY (B3) WxT	5x5	6x6
MAX. KEY (B4) WxT	6x6	8x7
H (B1)	31.3	45.3
H (B3)	18.3	22.8
H (B4) MAX	22.8	33.3

DOG COUPLING DETAILS

SLOT WIDTH	14
SLOT DEPTH	9
DOG COUPLING DIA.	Ø54



Drawn AASHAY 20-08-19  
Checked TAMIL 20-08-19  
Approved JOSE 20-08-19

Title DIMENSIONAL DRAWING, CKC30/60 & CKRC30/60, 3 CONDUIT ENTRIES, SMALL MOTOR, STANDARD ORIENTATION.

This drawing and the information it contains are property of Rotork Controls Limited, and they will not be reproduced or disclosed, in whole or in part, without the prior written consent of Rotork.

A4

Doc Number

A400N0BS00S

Ver No

1

Scale

NTS

Sheet No

3 of 3