

NOTE:
 1. APPROXIMATE WEIGHT :133 Kg (293 lbs).
 2. GEARBOX RATIOS: 3, 4 & 6:1.
 3. GEARBOX BASEPLATE: F25/FA25 & F30/FA30.
 4. DIMENSIONS WITH "*" INDICATE COVER REMOVAL ALLOWANCE
 5. THE INTERFACE PROVIDED FOR MOUNTING THE ACTUATOR OR SECOND STAGE GEARBOX ONTO THE VALVE SHOULD CONFORM TO GOOD ENGINEERING PRACTICES, ENSURING ADEQUATELY TOLERANCED LIMITS FOR PARALLELISM, PERPENDICULARITY AND CONCENTRICITY.
 6. ROTORK CANNOT BE HELD LIABLE FOR DAMAGE TO OUR EQUIPMENT CAUSED BY EXCESSIVE LOADING FROM COVER TUBES, HANDWHEEL AND HAND LEVER.

PARAMETER	VALUE	DESCRIPTION
DRAWING TYPE	A	INSTALLATION DRAWING
ACTUATOR	3	CK(R)250/500
GEARBOX1	B9	IB9
GEARBOX2	NO	NO GB2
CENTRONIK / TERMINAL	B	3 COND
MECHANISM / MOTOR	0	STD.MECH./LARGE MOT
HANDWHEEL / REAR / FRONT	0	STD.H.W./STD.REAR/STD.FRNT.
ORIENTATION	0	STANDARD ORIENTATION

Template Issue : 2021-02-19 (RCL-PE)

Rev	ECN	Revised	Rev. Approved	Date	Change Description
1-0	-	A.Aashay	N.Campbell	2024-03-25	

LEZO - ES
www.rotork.com

© 2024 Rotork Group of Companies. All rights reserved. This document and its contents may not be reproduced, distributed, transmitted, displayed, published, or broadcast, in whole, or in part, without the prior, express written permission of Rotork Group of Companies.

Title **DD, CK(R)250/500,IB9,3 ENTR, LRG MTR, STD ORT.**

Created	A.Aashay	2024-03-25	Drawing Number	Rev
Checked	A.Aashay	2024-03-25	A3B9N0B000X	1-0
Approved	N.Campbell	2024-03-25	Size	A3 Sheet 1 of 2

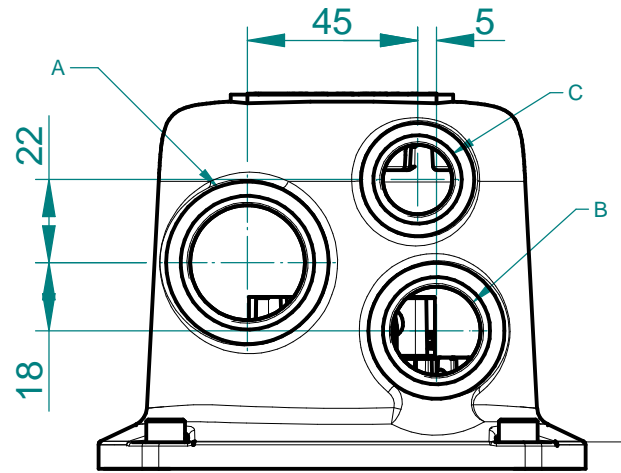

CONDUIT ENTRY HOLE		
Hole	Metric	NPT
A	M32	1 ¼"
B	M25	¾"
C	M20	¾"

CONDUIT ENTRIES

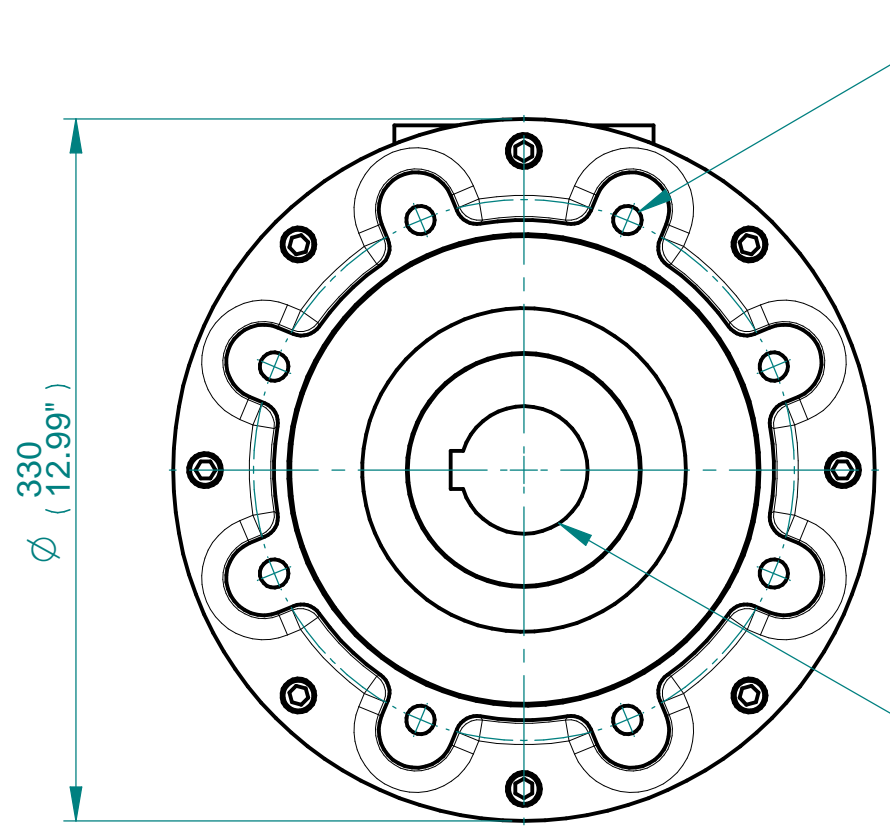

IB9-F25/FA25 GEARBOX MOUNTING DETAILS

SEE TABLE FOR BASEPLATE DETAILS

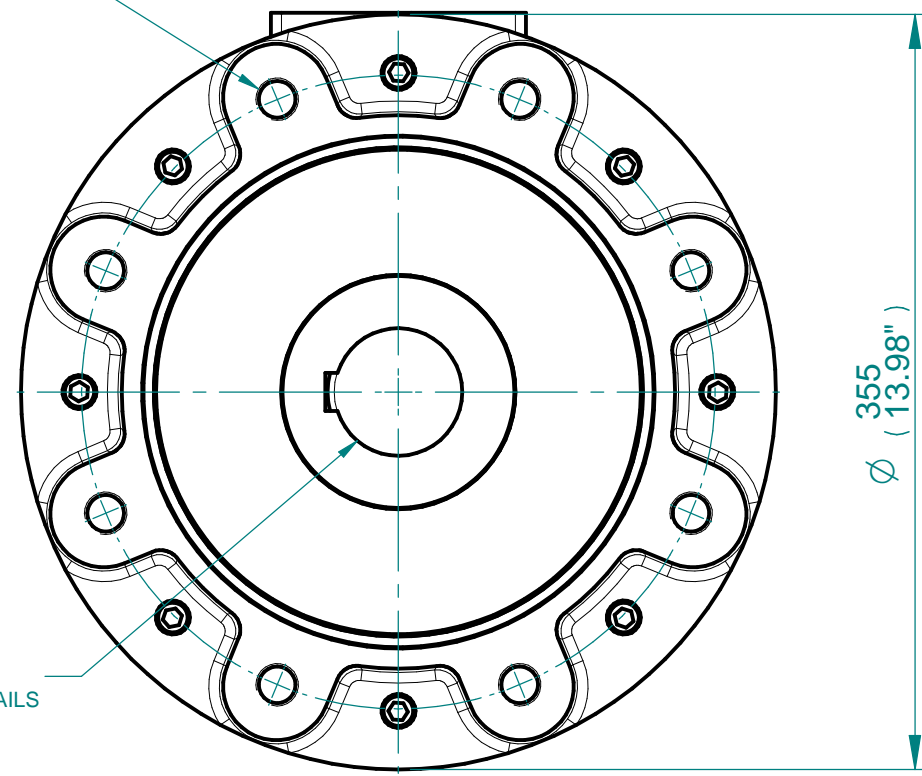

IB9-F30/FA30 GEARBOX MOUNTING DETAILS

SEE TABLE FOR BORE & KEY DETAILS

MAX. STEM SCREW ACCEPTANCE DIA
86(3.375")

STD	MAX BORE SQ KEY		MAX BORE RECTANGULAR KEY	
	BORE	KEY	BORE	KEY
BS4235	-	-	76.0	22X14
BS46	2.750"	3/4" SQ	3.000"	3/4"X1/2"
ANSI B17.1	2.750"	5/8" SQ	3.000"	3/4"X1/2"

BASEPLATE DETAILS			
TYPE	BASEPLATE	SPIGOT DIA.	HOLE DETAILS (22.5° OFF CENTRES)
ISO F25	STANDARD	Ø199.95-0.05	8 HOLES M16X20 (0.79") DEEP
		(Ø7.872"-0.002")	ON Ø254.0 (Ø10.00") P.C.
Ø152.25-0.05		8 HOLES 5/8"UNCX20 (0.79") DEEP	
(Ø5.994"-0.002")		ON Ø254.4 (Ø10.00") P.C.	
ISO F30	STANDARD	Ø229.95-0.05	8 HOLES M20x25 (0.98") DEEP
		(Ø9.053"-0.002")	ON Ø298.0 (Ø11.73") P.C.
Ø177.70-0.05		8 HOLES 3/4"UNCx25 (0.98") DEEP	
(Ø6.996"-0.002")		ON Ø298.5 (Ø11.75") P.C.	
FA30			

LEZO - ES
www.rotork.com

© 2024 Rotork Group of Companies. All rights reserved. This document and its contents may not be reproduced, distributed, transmitted, displayed, published, or broadcast, in whole, or in part, without the prior, express written permission of Rotork Group of Companies.

Title **DD, CK(R)250/500,IB9,3 ENTR, LRG MTR, STD ORT.**

Created	A.Aashay	2024-03-25	Drawing Number	Rev
Checked			A3B9N0B000X	1-0
Approved			Size	A3 Sheet 2 of 2

Template Issue - 2021-02-19 (RCL-PE)

Rev	ECN	Revised	Rev. Approved	Date	Change Description
1					
2					
3					
4					