

- NOTE:
1. GEARBOX RATIOS : 40, 70:1
 2. GEARBOX BASEPLATE: F10/FA10, F12/FA12, F14/FA14 & F16/FA16.
 3. DIMENSIONS WITH "*" INDICATE COVER REMOVAL ALLOWANCE.
 4. THE INTERFACE PROVIDED FOR MOUNTING THE ACTUATOR OR SECOND STAGE GEARBOX ONTO THE VALVE SHOULD CONFORM TO GOOD ENGINEERING PRACTICES, ENSURING ADEQUATELY TOLERANCED LIMITS FOR PARALLELISM, PERPENDICULARITY AND CONCENTRICITY.
 5. ROTORK CANNOT BE HELD LIABLE FOR DAMAGE TO OUR EQUIPMENT CAUSED BY EXCESSIVE LOADING FROM COVER TUBES, HANDWHEEL AND HAND LEVER.

PARAMETER	VALUE	DESCRIPTION
DRAWING TYPE	A	INSTALLATION DRAWING
ACTUATOR	1	CK(R)30/60
GEARBOX1	W3	IW3
GEARBOX2	NO	NO G.B.2
CENTORNIK / TERMINAL	S	SET/3 COND
MECHANISM / MOTOR	S	STD.MECH/SMALL MOT.
HANDWHEEL / REAR / FRONT ORIENTATION	0	STD.H.W./STD.REAR./STD.FRNT.
	0	STD.ORIENT.



Drawn	TAMIL	16-05-17
Checked	BHARAT	16-05-17
Approved	JOSE	16-05-17

Title DIMENSIONAL DRAWING, CK30/60 & CKR30/60, IW3, 3 CONDUIT ENTRIES, SMALL MOTOR, STANDARD ORIENTATION

A4	Doc Number	Ver No	Scale	Sheet No
	A1W3N0SS00X	2	NTS	1 of 2

CONDUIT ENTRY HOLE		
Hole	Metric	NPT
A	M32	1 1/4"
B	M25	3/4"
C	M20	3/4"

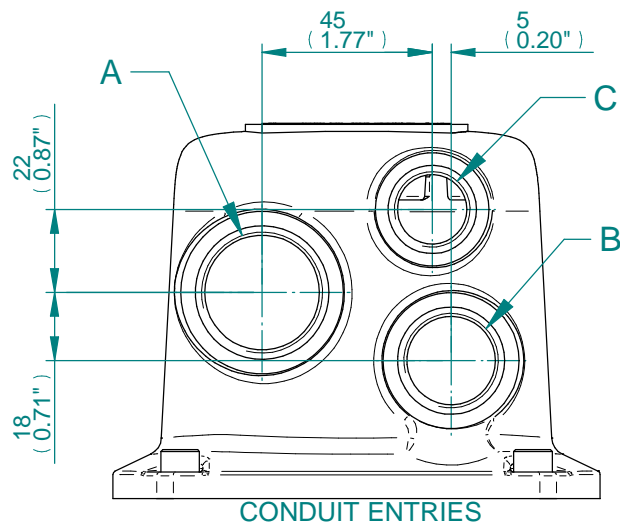

CONDUIT ENTRIES

MOUNTING HOLES CAN BE POSITIONED ON/OFF CENTRES BY REMOVING 4 BOLTS INDICATED AND REPOSITIONING

SEE TABLE FOR MOUNTING DETAILS

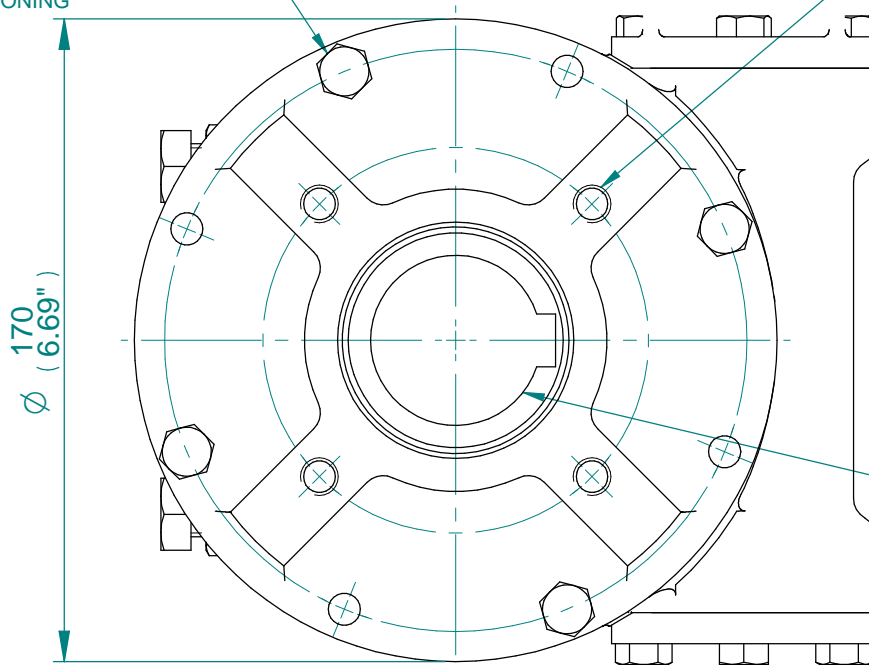

SEE TABLE FOR BORE & KEY DETAILS

IW3 GEARBOX MOUNTING DETAILS

BASEPLATE	X	Y	Z
STANDARD THICKNESS	45	70	81
FILLED THICKNESS	57	82	93
WAFER THICKNESS	71	96	107

STD	MAX BORE SQ KEY		MAX BORE RECTANGULAR KEY	
	BORE	KEY	BORE	KEY
BS4235	-	-	45.0	14X9
BS46	1.625"	7/16"SQ	1.75"	7/16"X5/16"
ANSI B17.1	1.750"	3/8"SQ	1.75"	3/8"X1/4"

BASEPLATE DETAILS		
TYPE	BASEPLATE	HOLE DETAILS (45° OFF CENTRES)
ISO F10	STANDARD	4 HOLES M10X18 (0.71") DEEP
		ON Ø102.0 (Ø4.02") P.C.
FA10		4 HOLES 3/8"UNCx18 (0.71") DEEP
		ON Ø102.0 (Ø4.02") P.C.
ISO F12		4 HOLES M12 x 18 (0.71") DEEP
		ON Ø125 (Ø4.92") P.C.
FA12	4x 1/2"UNC x 18 (0.71") DEEP	
	ON Ø125.7 (Ø4.95") P.C.	
ISO F14	FILLED	4 HOLES M16X24 (0.94") DEEP
		ON Ø140.0 (Ø5.51") P.C.
FA14		4 HOLES 5/8"UNCx24 (0.94") DEEP
		ON Ø139.7 (Ø5.50") P.C.
ISO F16		4 HOLES M20X24 (0.94") DEEP
		ON Ø165.0 (Ø6.50") P.C.
FA16	4 HOLES 3/4"UNCx24 (0.94") DEEP	
	ON Ø165.0 (Ø6.50") P.C.	



Drawn	TAMIL	16-05-17
Checked	BHARAT	16-05-17
Approved	JOSE	16-05-17

Title DIMENSIONAL DRAWING, CK30/60 & CKR30/60, IW3, 3 CONDUIT ENTRIES, SMALL MOTOR, STANDARD ORIENTATION

This drawing and the information it contains are property of Rotork Controls Limited, and they will not be reproduced or disclosed, in whole or in part, without the prior written consent of Rotork.

A4	Doc Number	Ver No	Scale	Sheet No
	A1W3N0SS00X	2	NTS	2 of 2